

NOTES:

1. MAINTENANCE OF TRAFFIC ON RAMP 64W55N SHALL BE COORDINATED WITH CONSTRUCTION OF CONTRACT 76C53.
2. MAINTENANCE OF TRAFFIC ON RAMP NB I-55 TO ST. CLAIR AVENUE SHALL BE COORDINATED WITH CONSTRUCTION OF CONTRACT 76C51.

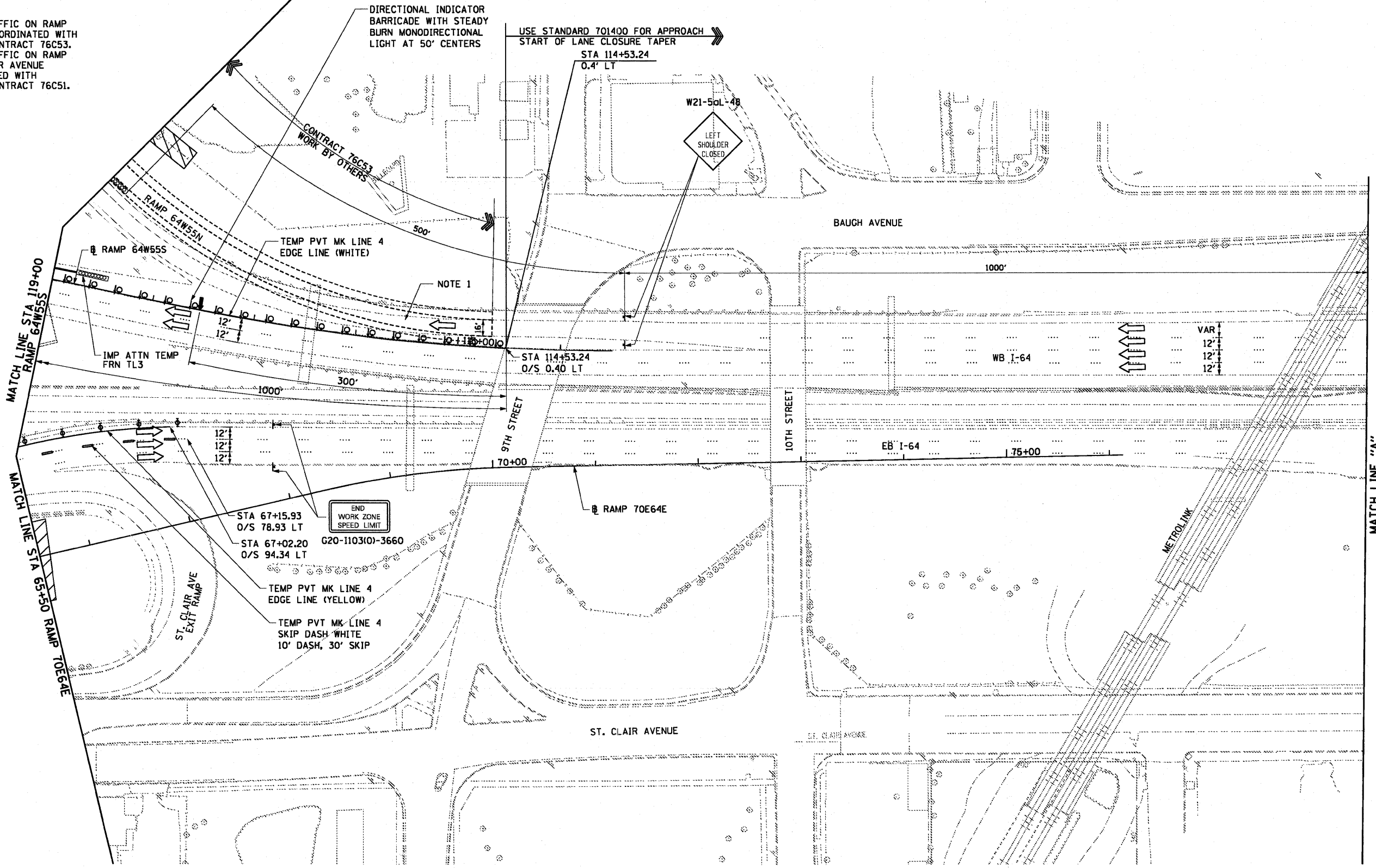

USER NAME = searab	DESIGNED OP	REVISED -
PLT SCALE = 1/8" = 10' / 1"	DRAWN OP	REVISED -
PLT DATE = 6/30/2011	CHECKED DBM	REVISED -
	DATE 07-01-11	REVISED -

**STATE OF ILLINOIS
DEPARTMENT OF TRANSPORTATION**

**SUGGESTED STAGES OF CONSTRUCTION AND
TRAFFIC CONTROL - STAGE 1**

SCALE: 1" = 50' SHEET NO. 3 OF 7 SHEETS STA. TO STA.

F.A.I. RTE. 64/998	SECTION 82-1-B-2	COUNTY ST. CLAIR	TOTAL SHEETS 399	SHEET NO. 44
FED. ROAD DIST. NO.		ILLINOIS FED. AID PROJECT		