

P
6-01

140 FOOT STORM SEWERS
CLASS A, TYPE 2 12" @ 4.50%
TBF = 27.3 CU YD

P
6-02

98 FOOT STORM SEWERS
CLASS A, TYPE 2 12" @ 4.50%
TBF = 48.2 CU YD

P
6-03

102 FOOT STORM SEWERS
CLASS A, TYPE 2 12" @ 3.00%
TBF = 50.8 CU YD

P
6-04

20 FOOT STORM SEWERS
CLASS A, TYPE 2 12" @ 1.00%
TBF = 0.0 CU YD

P
6-05

92 FOOT STORM SEWERS
CLASS A, TYPE 2 12" @ 3.00%
TBF = 68.4 CU YD

P
6-07

32 FOOT STORM SEWERS
CLASS A, TYPE 2 21" @ 0.31%
TBF = 22.0 CU YD

P
6-08

37 FOOT STORM SEWERS
CLASS A, TYPE 2 21" @ 0.30%
TBF = 0.0 CU YD

NOTES:

1. PROPOSED 70E55N LEFT-SIDE DITCH TO BE CONSTRUCTED FOR TEMPORARY CONDITIONS UNTIL FINAL EMBANKMENT GRADING IS COMPLETED IN CONTRACT 76C53. STRUCTURE S 6-04 AND PIPE P 6-04 ARE TEMPORARY STRUCTURES AND WILL BE REMOVED ONCE FINAL GRADING IS ESTABLISHED.
2. ALL DRAINAGE STRUCTURES AND STORM SEWERS LOCATED BEYOND STA 78+50.00 (70E55N) ARE TO BE CONSTRUCTED IN CONTRACT 76C53 WITH THE EXCEPTION OF P 6-05, WHICH IS TO BE CONSTRUCTED IN THIS CONTRACT.

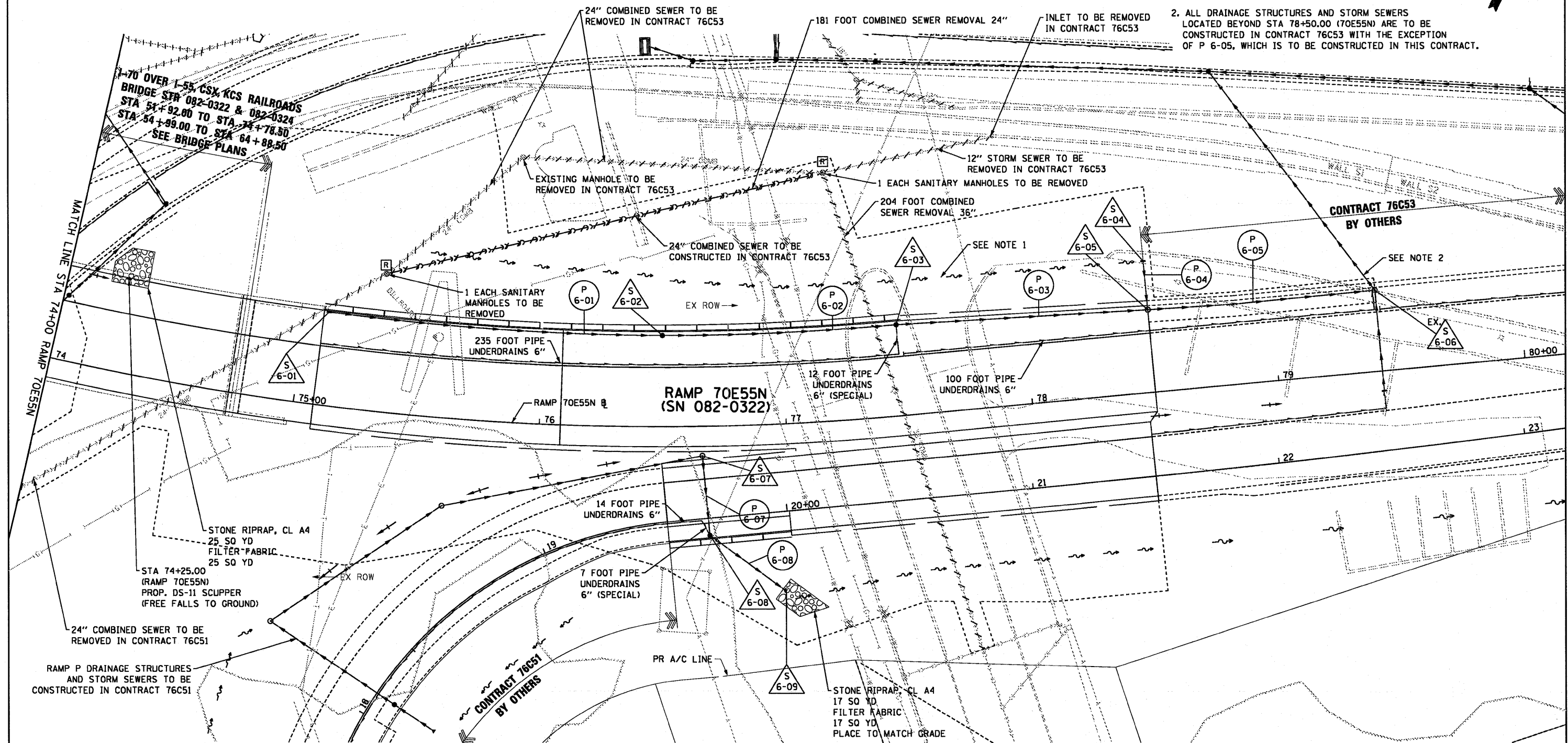

S
6-01
STA 75+10.00 (70E55N)
O/S 38.50' LT
CATCH BASINS, TYPE A
TYPE 20 F&G
RIM: 426.12
NE. INV (12''): 420.95

S
6-02
STA 76+50.00 (70E55N)
O/S 38.50' LT
CATCH BASINS, TYPE A 4'-DIAM. (FST)
TYPE 20 F&G
RIM: 418.02
NE. INV (12''): 412.65
SW. INV (12''): 414.65

S
6-03
STA 77+48.00 (70E55N)
O/S 38.50' LT
CATCH BASINS, TYPE A 4'-DIAM.
TYPE 20 F&G
RIM: 413.65
NE. INV (12''): 408.24
SW. INV (12''): 408.24

S
6-04
STA 78+50.00 (70E55N)
O/S 53.43' LT
INLETS, TYPE A
TYPE 8 GRATE
RIM: 407.44
SE. INV (12''): 403.96

S
6-05
STA 78+50.00 (70E55N)
O/S 33.50' LT
MANHOLES, TYPE A 4'-DIAM.
TYPE 1 FRAME CL
RIM: 410.63
NE. INV (12''): 403.76
NW. INV (12''): 403.76
SW. INV (12''): 405.18

EX. S
6-06
STA 79+42.00 (70E55N)
O/S 32.87' LT
MANHOLES, TYPE A 4'-DIAM.
TYPE 1 FRAME CL
RIM: 408.05
SE. INV (12''): 401.00
NW. INV (12''): 401.00
W. INV (12''): 391.78

S
6-07
STA 19+68.00 (RAMP P)
O/S 25.50' LT
MANHOLES, TYPE A 5'-DIAM.
TYPE 1 FRAME OL
RIM: 419.60
SE. INV (21''): 412.58
SW. INV (21''): 412.58

S
6-08
STA 19+68.00 (RAMP P)
O/S 8.00' RT
CATCH BASINS, TYPE A 5'-DIAM.
TYPE 20 F&G
RIM: 418.40
NE. INV (21''): 412.48
E. INV (21''): 412.48

S
6-09
STA 19+95.54 (RAMP P)
O/S 31.43' RT
PRECAST REINFORCED CONCRETE
FLARED END SECTIONS 21"
W. INV (21''): 412.37

USER NAME = searsb	DESIGNED KLK	REVISED -
PLLOT SCALE = 48.0000' / in.	DRAWN KLK	REVISED -
PLLOT DATE = 7/1/2011	CHECKED EEE	REVISED -
	DATE 07-01-11	REVISED -

**STATE OF ILLINOIS
DEPARTMENT OF TRANSPORTATION**

DRAINAGE AND UTILITY PLAN

F.A.I. RTE. 64/998	SECTION 82-1-B-2	COUNTY ST. CLAIR	TOTAL SHEETS 399	SHEET NO. 66
SCALE: 1" = 20'		SHEET NO. 6 OF 7 SHEETS		STA. 74+00 TO STA. 75+41.52
FED. ROAD DIST. NO. ILLINOIS FED. AID PROJECT				