

PLAN	SURVEYED	BY	DATE
	NOTED		
	ALIGNED		
	CHECKED		
	BT. OF WAY		
	CHECKED		
	NO.		
	PAID FILE NAME		

PROFILE	SURVEYED	BY	DATE
	NOTED		
	ALIGNED		
	CHECKED		
	BT. OF WAY		
	CHECKED		
	NO.		
	STRUCTURE NOTATIONS GRID		

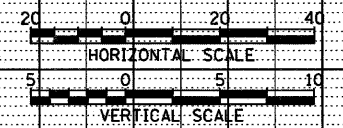
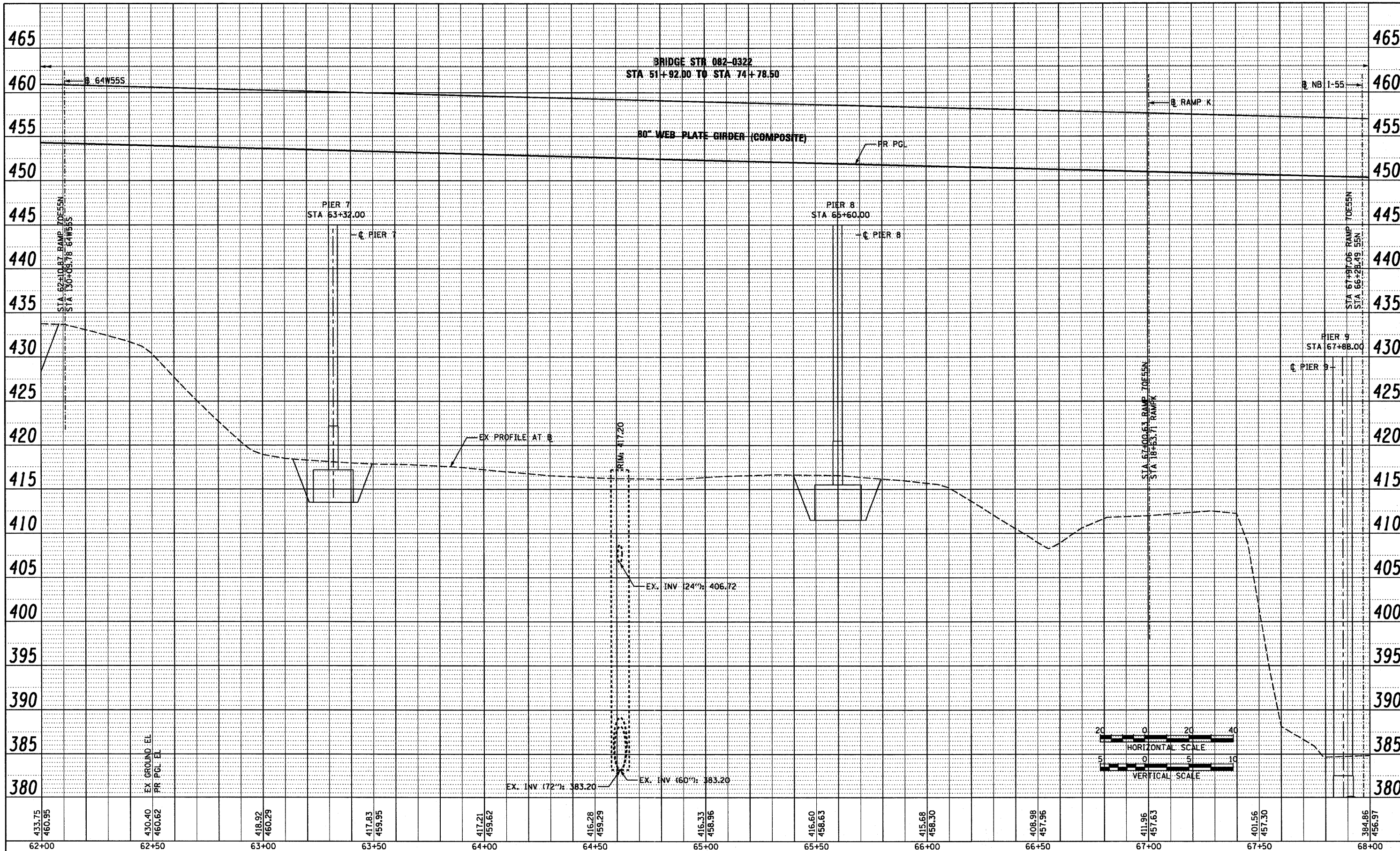

433.75	430.40	418.92	417.83	417.21	416.28	416.33	416.60	415.68	408.98	411.96	401.56	384.86
460.95	460.62	460.29	459.95	459.62	459.29	458.96	458.63	458.30	457.96	457.63	457.30	456.97
62+00	62+50	63+00	63+50	64+00	64+50	65+00	65+50	66+00	66+50	67+00	67+50	68+00

PROPOSED RAMP 70E55N

USER NAME = ssa-sb	DESIGNED KLK	REVISED -	<p align="center">STATE OF ILLINOIS DEPARTMENT OF TRANSPORTATION</p> <p align="center">DRAINAGE PROFILE RAMP 70E55N</p>	F.A.I. RTE. 64/998	SECTION 82-1-B-2	COUNTY ST. CLAIR	TOTAL SHEETS 399	SHEET NO. 71	
PLT SCALE = 40.0000' / 1"	DRAWN KLK	REVISED -		SCALE: H: 20 V: 5	SHEET NO. 3 OF 5 SHEETS	STA. 62+00 TO STA. 68+00	FED. ROAD DIST. NO. ILLINOIS FED. AID PROJECT		
PLT DATE = 7/1/2011	CHECKED DBM	REVISED -							
	DATE 07-01-11	REVISED -							

FILE NAME = P:\P6804669\980.CAD\981.Drawings\76C76.Contract\Sheet\Civil\Drainage\DR71-76C76-8ht-drain-Profile-84-78E55N-83.dgn