

PLAN SURVEYED BY DATE  
 PLOTTED BY DATE  
 ALIGNED CHECKED BY DATE  
 RT. OF WAY CHECKED BY DATE  
 NO. \_\_\_\_\_ DDD FILE NAME

PROFILE SURVEYED BY DATE  
 PLOTTED BY DATE  
 B.M. NOTED BY DATE  
 STRUCTURE NOTATION CHRD

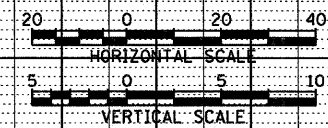
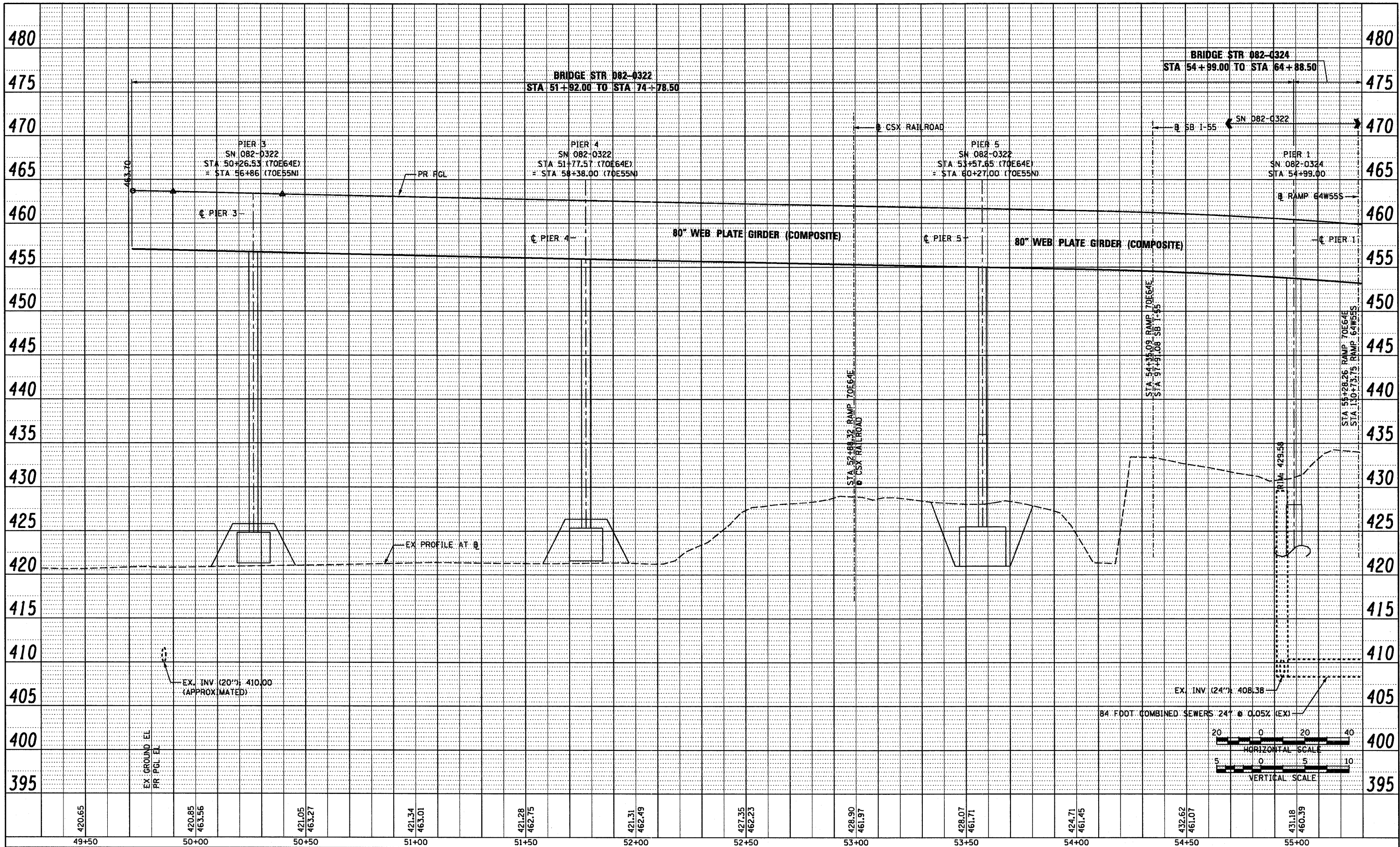

49+50 50+00 50+50 51+00 51+50 52+00 52+50 53+00 53+50 54+00 54+50 55+00

**PROPOSED RAMP 70E64E**

USER NAME = searsb	DESIGNED KLK	REVISED -
	DRAWN KLK	REVISED -
PLOT SCALE = 40.0000' / in.	CHECKED DBM	REVISED -
PLOT DATE = 7/1/2011	DATE 07-01-11	REVISED -

**STATE OF ILLINOIS  
 DEPARTMENT OF TRANSPORTATION**

**DRAINAGE PROFILE  
 RAMP 70E64E**

SCALE: H 20 V 5 SHEET NO. 1 OF 3 SHEETS STA. 49+30 TO STA. 55+30

F.A.I. RTE. 64/998	SECTION 82-1-B-2	COUNTY ST. CLAIR	TOTAL SHEETS 399	SHEET NO. 74
FED. ROAD DIST. NO. ILLINOIS FED. AID PROJECT CONTRACT NO. 76C76				

FILE NAME = P:\P6804668\9\980.CAD\9801.Drawings\76C76.Contract\Sheet\Civil\Drainage\DR11-76C76-shd-drain-Profile-87-76E64E-01.dgn