

GRADING LAYOUT EAST ABUTMENT

POINT	STATION	O/S	RT/LT	NOTES
A	63+32.05	38.01	RT	MEET EXISTING
B	63+45.00	37.82	RT	PI
C	64+72.25	40.91	RT	PI
D	64+83.41	40.74	RT	PC
E	64+91.88	39.06	RT	PCC
F	64+97.72	38.15	RT	PT
G	65+30.12	40.06	RT	PC
H	65+45.82	29.94	RT	PCC
I	64+94.18	15.33	RT	PC
J	64+83.94	25.73	RT	PT
K	63+77.44	1.91	LT	MEET EXISTING
L	64+64.75	30.06	LT	PC
M	64+72.25	31.28	LT	PT
N	65+01.25	31.57	LT	PC
O	65+23.75	29.58	LT	END
P	64+04.03	26.24	LT	PC
Q	63+98.98	28.88	LT	PT
R	63+97.34	34.23	LT	PC
S	64+02.38	41.60	LT	PT, MEET EXISTING
T	63+59.83	19.84	LT	PI
U	63+30.16	9.91	LT	PI
V	63+74.73	37.48	LT	MEET EXISTING
W	63+12.13	16.53	LT	PC
X	63+09.68	11.27	LT	PT
Y	63+10.28	9.75	LT	PC
Z	63+05.68	1.35	LT	PT

GRADING LAYOUT PIER 3

POINT	STATION	O/S	RT/LT	NOTES
AA	57+36.33	22.32	LT	MEET EXISTING
BB	57+53.31	41.42	LT	PI
CC	57+85.04	50.73	LT	PI
DD	58+15.84	41.18	LT	MEET EXISTING
EE	57+48.11	6.45	RT	MEET EXISTING
FF	57+68.59	20.41	LT	PI
GG	57+86.80	26.46	LT	PI
HH	58+23.31	17.89	LT	MEET EXISTING

*ALL STATION AND OFFSETS TAKE FROM RAMP 70E64E BASELINE

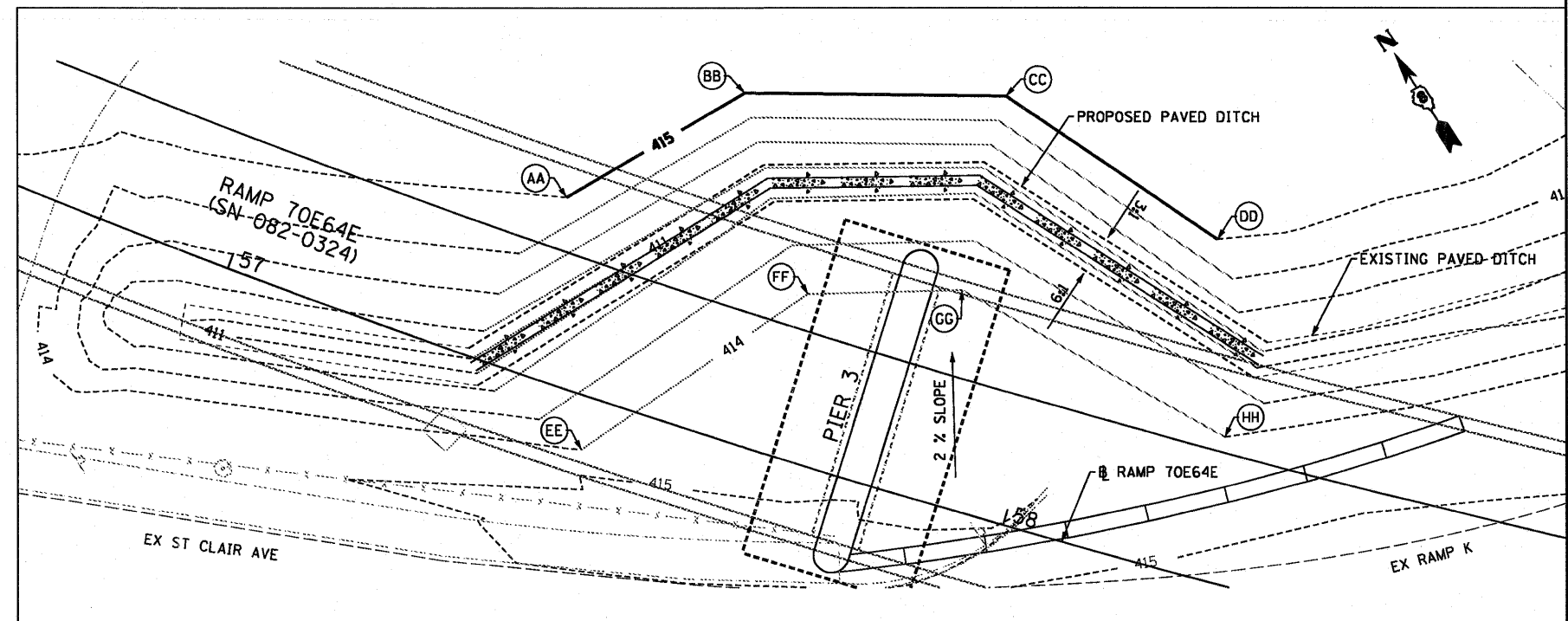

USER NAME = pimarno	DESIGNED OP	REVISED -
PLLOT SCALE = 20.0000' / 1"	DRAWN OP	REVISED -
PLLOT DATE = 6/30/2011	CHECKED DBM	REVISED -
	DATE 07-01-11	REVISED -

STATE OF ILLINOIS
DEPARTMENT OF TRANSPORTATION

GRADING PLAN

SCALE: 1" = 10' SHEET NO. 1 OF 1 SHEETS STA. TO STA.

F.A.I. RTE. 64/998	SECTION 82-1-B-2	COUNTY ST. CLAIR	TOTAL SHEETS 399	SHEET NO. 93
FED. ROAD DIST. NO.		ILLINOIS FED. AID PROJECT		
CONTRACT NO. 76C76				