

Notes:
See sheet S-84 for Sections C-C, D-D & H-H and Views B-B & G-G.
a274(E) thru a277(E) bar spacings measured along \bar{C} Rdwy.

**** Cost included with Concrete Superstructure.

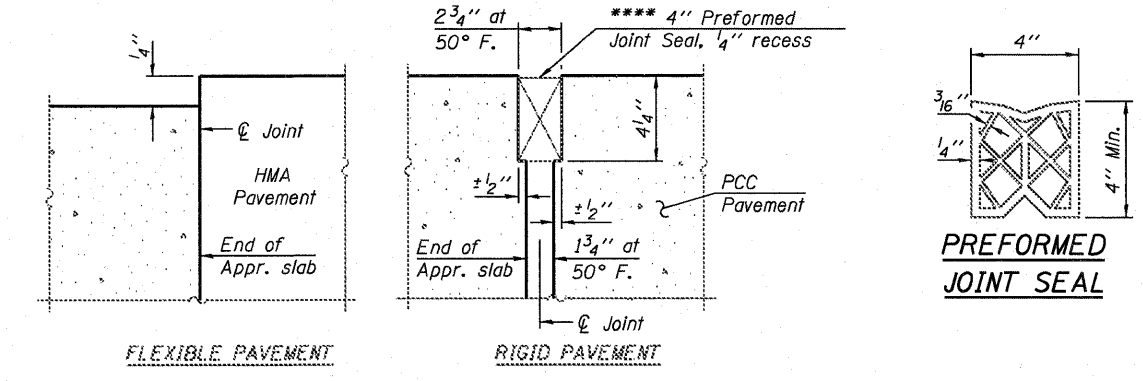

DETAIL A

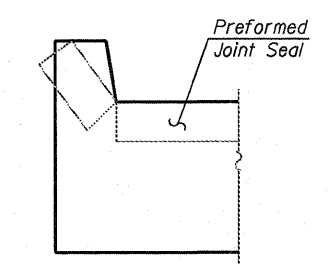

VIEW E-E

Angle Preformed Joint Seal at 45° at curbs when req'd for drainage.

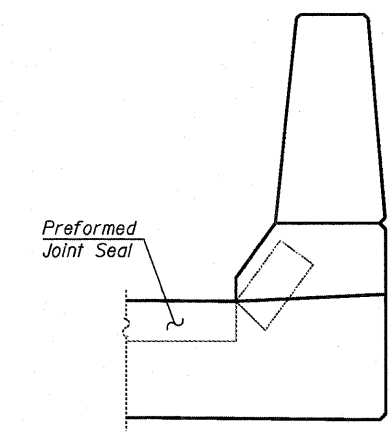

VIEW F-F

Angle Preformed Joint Seal at 45° at curbs when req'd for drainage.

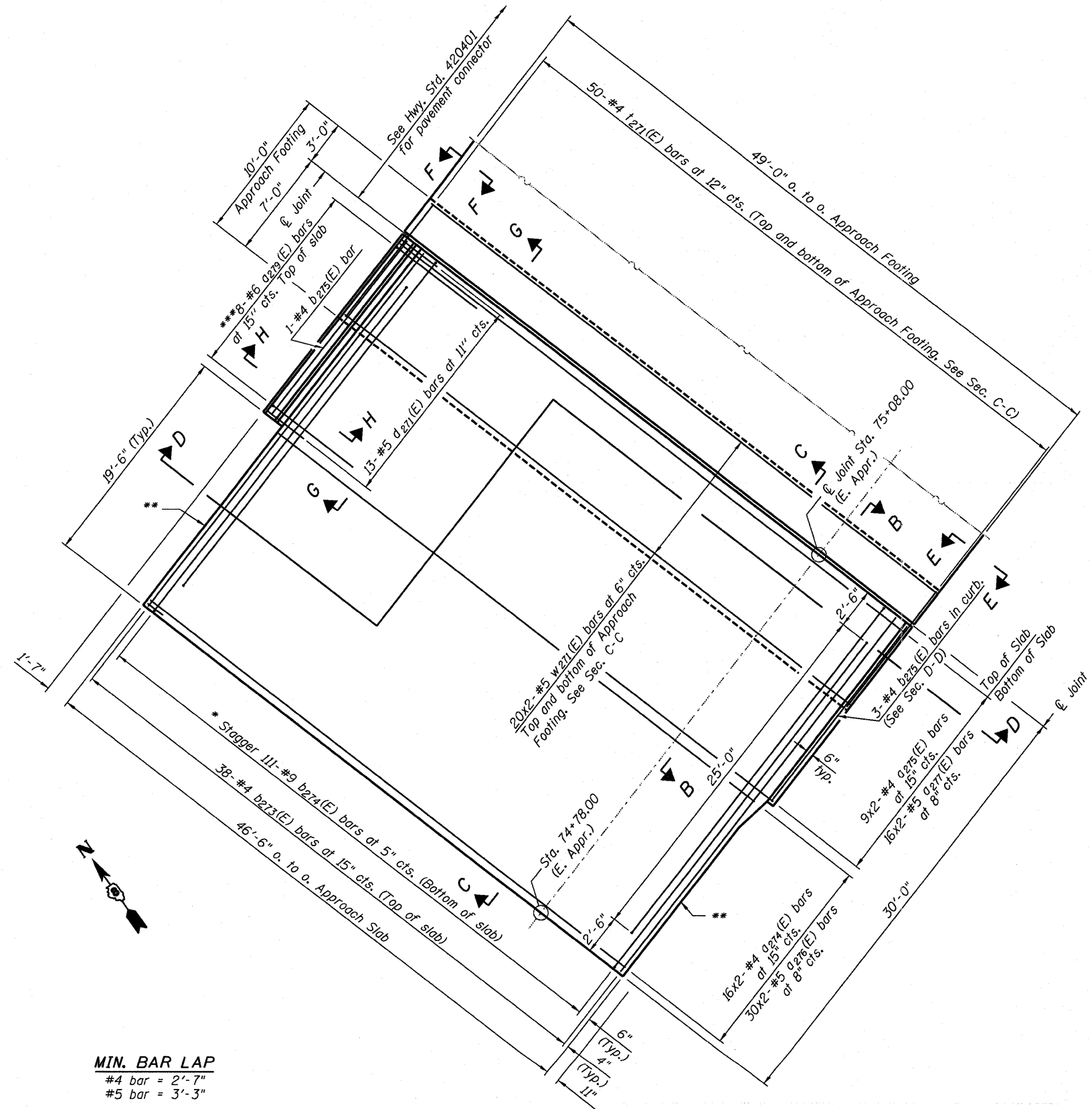

MIN. BAR LAP
#4 bar = 2'-7"
#5 bar = 3'-3"

EAST APPROACH SLAB PLAN - S.N. 082-0322

- * Tilt #9 b274(E) bars as required to maintain clearance.
- ** Closed cell joint filler according to Article 1051.08 of the Standard Specifications, full depth of slab, full length of parapet. Typical each parapet.
- *** Space between a275(E) bars.

DB:TR-0820322-0820324-7675-SB3-EApp-Slab-082.dgn

	USER NAME = Scott Whitney	DESIGNED - JLA	REVISED -	STATE OF ILLINOIS DEPARTMENT OF TRANSPORTATION	EAST APPROACH SLAB PLAN - S.N. 082-0322 I-70E OVER I-55, CSX & KCS RAILROADS		F.A.I. RTE. 70	SECTION 82-1-B-2	COUNTY ST. CLAIR	TOTAL SHEETS 399	SHEET NO. 210
	PLOT SCALE = 2.0000' / IN.	DRAWN - SAW	REVISED -		SCALE: NONE	SHEET S-83 OF S-234 SHEETS	S.N. 082-0322 & S.N. 082-0324	CONTRACT NO. 76C76		FED. ROAD DIST. NO. [ILLINOIS] FED. AID PROJECT	
	PLOT DATE = 6/7/2011	DATE - 07-01-2011	REVISED -								