

TOP PLAN

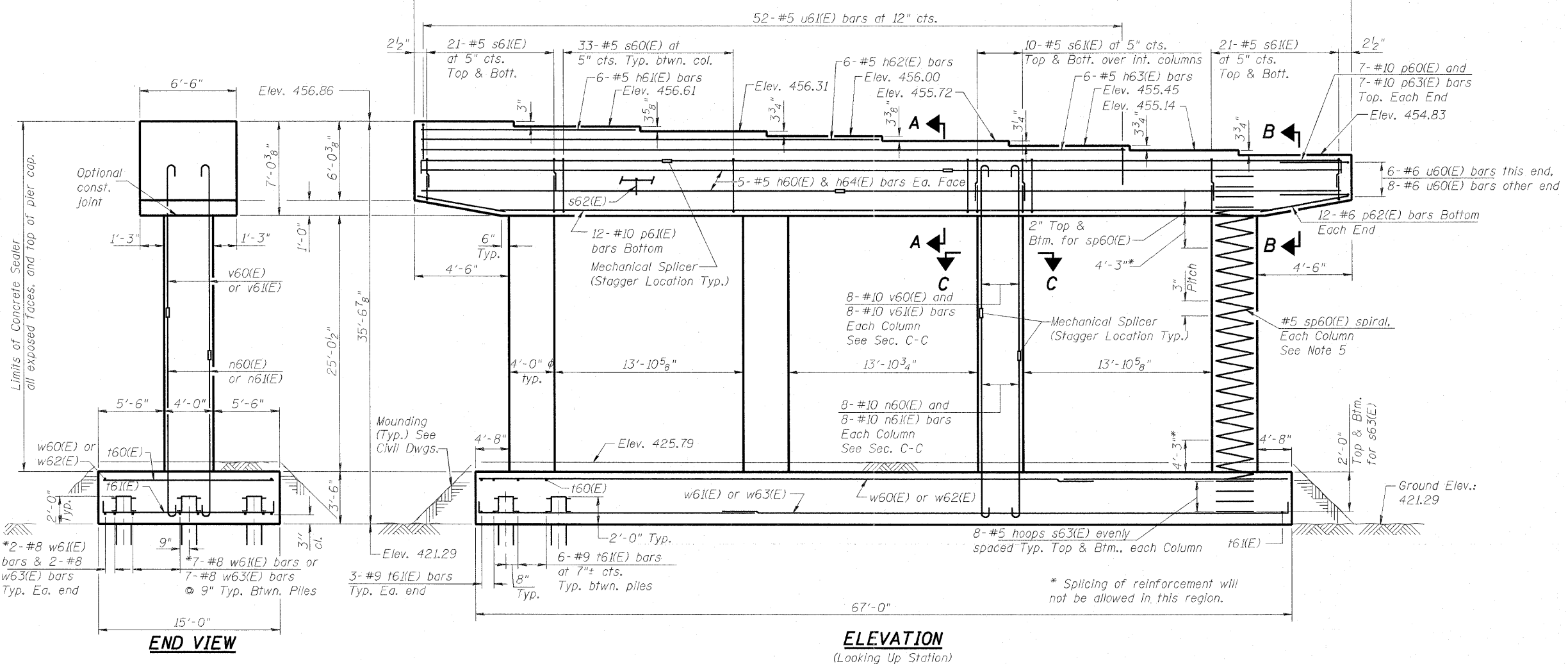

ELEVATION
(Looking Up Station)

END VIEW

*Alternate Splice Locations
Min. Laps
#7 bar: 3'-7"
#8 bar: 4'-2"

- Notes:
1. Space reinforcement in cap to miss anchor bolts.
 2. Four steps monolithically with cap.
 3. For details of piles, see sheet S-187 of S-234.
 4. C of Pier is radial to @ 70E55N at Sta. 56+86.00.
 5. #5 sp60(E) spiral, each column
 - 1) Provide 1/2 extra turns, shop welded together per AWS D1.4 top and bottom. Extend spiral 2" into pier cap & crashwall. Provide 4-#4 spacers or equivalent.
 - 2) When splicing spiral reinforcement is necessary, the spirals shall be provided with 1/2 extra turns at the ends to be spliced. These additional turns shall either be welded together according to AWS D1.4, or shall both terminate with a 135° standard hook.
 6. Contractor shall use Mechanical Splicers in columns and pier cap that will fit between spirals and stirrups.

PILE DATA

Type: HP 12x63
Nominal Required Bearing: 400 kips
Factored Resistance Available: 200 kips
Est. Length: 97'
No. Production Piles: 51
No. Test Piles: 0

BILL OF MATERIAL

Bar	No.	Size	Length	Shape
h60(E)	10	#5	36'-4"	—
h61(E)	6	#5	15'-9"	—
h62(E)	6	#5	33'-0"	—
h63(E)	6	#5	50'-7"	—
h64(E)	10	#5	30'-0"	—
n60(E)	32	#10	10'-5"	U
n61(E)	32	#10	13'-5"	U
p60(E)	14	#10	17'-1"	
p61(E)	12	#10	58'-8"	
p62(E)	24	#6	8'-3"	
p63(E)	14	#10	52'-11"	
s60(E)	99	#5	22'-7"	□
s61(E)	124	#5	13'-6"	□
s62(E)	67	#5	7'-7"	□
s63(E)	64	#5	11'-6"	□
** sp60(E)	4	#5	25'-5"	~
t60(E)	68	#7	14'-8"	—
t61(E)	102	#9	18'-4"	—
u60(E)	14	#6	12'-2"	U
u61(E)	52	#5	14'-1"	U
v60(E)	32	#10	23'-9"	U
v61(E)	32	#10	20'-9"	U
w60(E)	20	#7	25'-0"	—
w61(E)	18	#8	26'-10"	—
w62(E)	20	#7	45'-7"	—
w63(E)	18	#8	48'-0"	—
Concrete Structures		Cu. Yd.	272.7	
Reinforcement Bars, Epoxy Coated		Pound	44,500	
Furnishing Steel Piles HP 12x63		Foot	4,947	
Driving Piles		Foot	4,947	
Mechanical Splicers		Each	88	
Concrete Sealer		Sq. Ft.	2,930	

** Length is height of spiral.
See next sheet for Bar Details and Sections.

AECOM	USER NAME =	DESIGNED - DDB	REVISED -	STATE OF ILLINOIS DEPARTMENT OF TRANSPORTATION	PIER - UNIT 1 - PIER 3 - PLANS & ELEVATIONS I-70E OVER I-55, CSX & KCS RAILROADS	F.A.I. RTE. TO	SECTION 82-1-B-2	COUNTY ST. CLAIR	TOTAL SHEETS 399	SHEET NO. 279
	PLOT SCALE = 0.165667' / IN.	DRAWN - BRD	REVISED -			S.N. 082-0322 & S.N. 082-0324	CONTRACT NO. 76C76			
	PLOT DATE = 6/30/2011	CHECKED - LLV	REVISED -	SCALE:	SHEET S-152 OF S-234 SHEETS	STA. TO STA.		FED. ROAD DIST. NO. [ILLINOIS] FED. AID PROJECT		
		DATE - 07-01-11	REVISED -							