

**SEC. A-A**

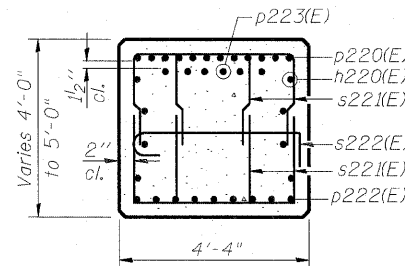

**SEC. B-B**

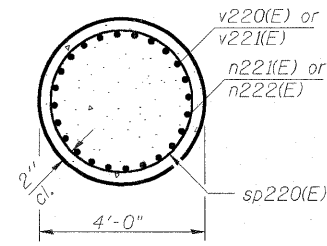

**SEC. C-C**

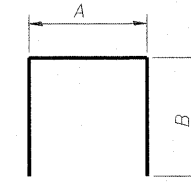

**BARS**  
**A & B DIMENSIONS**

Bar	A	B
s221(E)	2'-8"	4'-0"
s223(E)	3'-10"	2'-3"
s225(E)	3'-10"	13'-0"
t221(E)	20'-8"	1'-10"
u221(E)	4'-0"	4'-6"

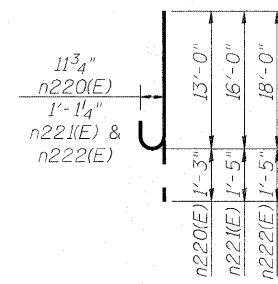

**BAR n220(E), n221(E) & n222(E)**

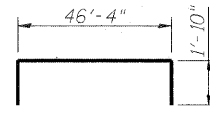

**BAR p220(E)**

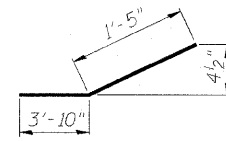

**BAR p222(E)**

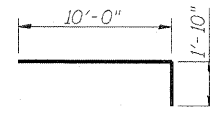

**BAR p223(E)**

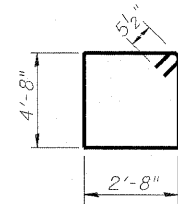

**BAR s220(E)**

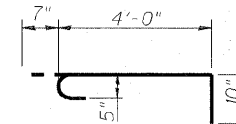

**BAR s222(E)**

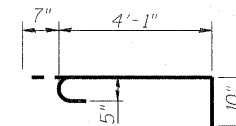

**BAR s226(E)**

Shop welded per AWS D1.4 or mechanically spliced; cost included in Reinforcement Bars, Epoxy Coated

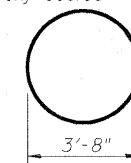

**BAR s224(E)**

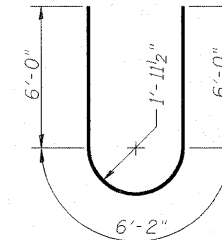

**BAR u220(E)**

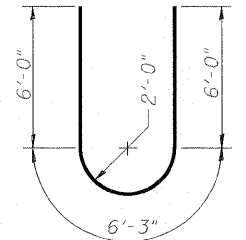

**BAR u222(E)**

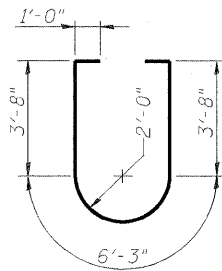

**BAR u223(E)**

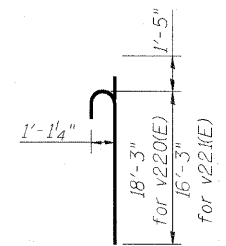

**BAR v220(E) or v221(E)**



USER NAME =  
PLOT SCALE = 0.166667' / IN.  
PLOT DATE = 8/15/2011

DESIGNED - DDB  
DRAWN - BRD  
CHECKED - LLV  
DATE - 08-12-11

REVISED -  
REVISED -  
REVISED -  
REVISED -

STATE OF ILLINOIS  
DEPARTMENT OF TRANSPORTATION

PIER - UNIT 4 - PIER 11 - DETAILS  
I-70E OVER I-55, CSX & KCS RAILROADS

SCALE: SHEET S-170 OF S-234 SHEETS STA. TO STA.

F.A.I. RTE.	SECTION	COUNTY	TOTAL SHEETS	SHEET NO.
70	82-1-B-2	ST. CLAIR	399	297
S.N. 082-0322 & S.N. 082-0324		CONTRACT NO. 76C76		
FED. ROAD DIST. NO.		ILLINOIS FED. AID PROJECT		

K:\projects\08016609\0802-0322 & 0324 - PIER UNIT 4 - PIER 11 - DETAILS\0802-0322 sheets\082-0322-0324-76C76-5623-Unit 4-Pier 11-2.dgn