

Notes:
 1. Pour steps monolithically with cap.
 2. ϕ of Pier is perpendicular to \square 70E64E at Sta. 59+68.00.

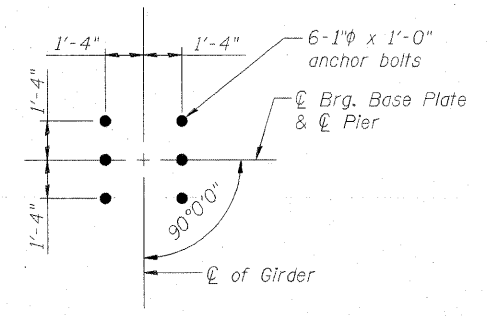

ANCHOR BOLT LOCATION DETAIL

BAR s364(E)

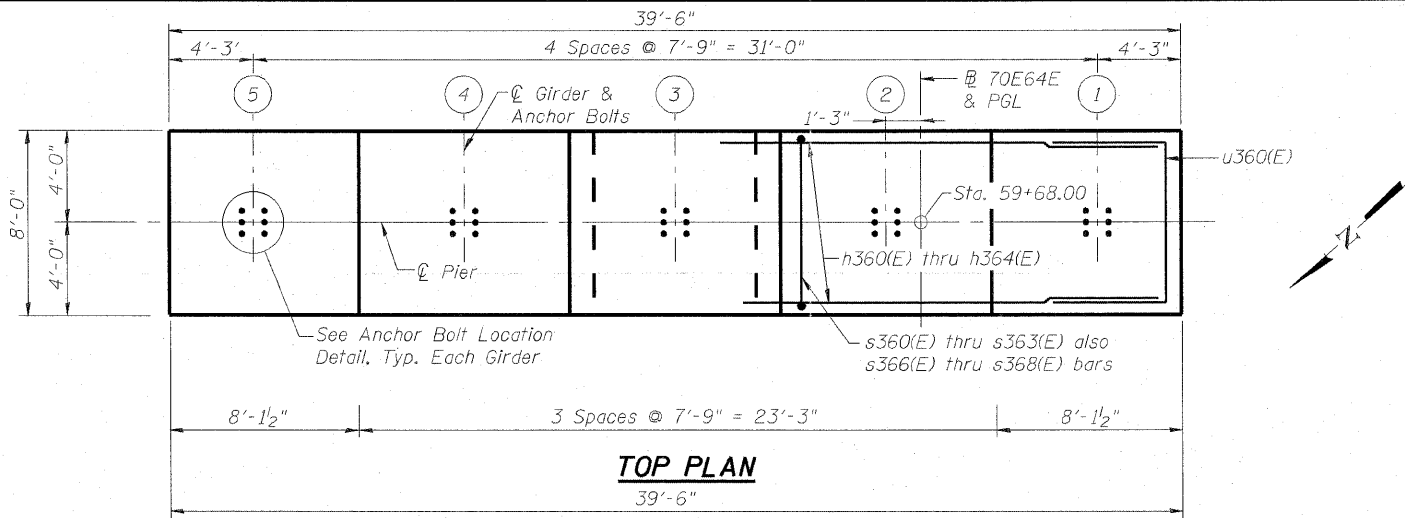
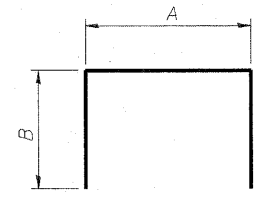

BARS A & B DIMENSIONS

Bar	A	B
s360(E)	5'-1"	3'-8"
s361(E)	5'-1"	4'-7"
s362(E)	5'-1"	5'-9"
s363(E)	5'-1"	6'-4"
s366(E)	5'-1"	5'-4"
s367(E)	5'-1"	5'-6"
s368(E)	5'-1"	6'-0"
u360(E)	7'-7"	6'-0"

BILL OF MATERIAL

Bar	No.	Size	Length	Shape
h360(E)	2	#6	13'-11"	—
h361(E)	2	#6	21'-0"	—
h362(E)	2	#6	28'-0"	—
h363(E)	2	#9	35'-1"	—
h364(E)	6	#9	39'-2"	—
h365(E)	2	#9	19'-7"	—
p360(E)	24	#11	43'-2"	—
p361(E)	20	#7	23'-6"	—
s360(E)	20	#5	12'-5"	—
s361(E)	28	#5	14'-3"	—
s362(E)	48	#5	16'-7"	—
s363(E)	80	#5	17'-9"	—
s364(E)	12	#5	22'-6"	—
s365(E)	82	#5	9'-1"	—
s366(E)	20	#5	15'-9"	—
s367(E)	28	#5	16'-1"	—
s368(E)	48	#5	17'-1"	—
sp360(E)	1	#7	51'-0"	—
sp361(E)	1	#5	9'-6"	—
sp362(E)	2	#6	39'-3"	—
u360(E)	12	#6	19'-7"	—
v360(E)	36	#14	13'-3"	—
v361(E)	36	#14	15'-3"	—
v362(E)	108	#14	37'-0"	—
v363(E)	36	#14	39'-0"	—
v364(E)	72	#14	57'-0"	—
Structure Excavation		Cu. Yd.	3.5	
Concrete Structures		Cu. Yd.	122.1	
Reinforcement Bars, Epoxy Coated		Pound	110,270	
Drilled Shaft in Soil		Cu. Yd.	192.7	
Drilled Shaft in Rock		Cu. Yd.	27.8	
Permanent Casing		Lin. Ft.	104	
Mechanical Splicers		Each	216	
Crosshole Sonic Logging		Each	1	

** Length is height of spiral.

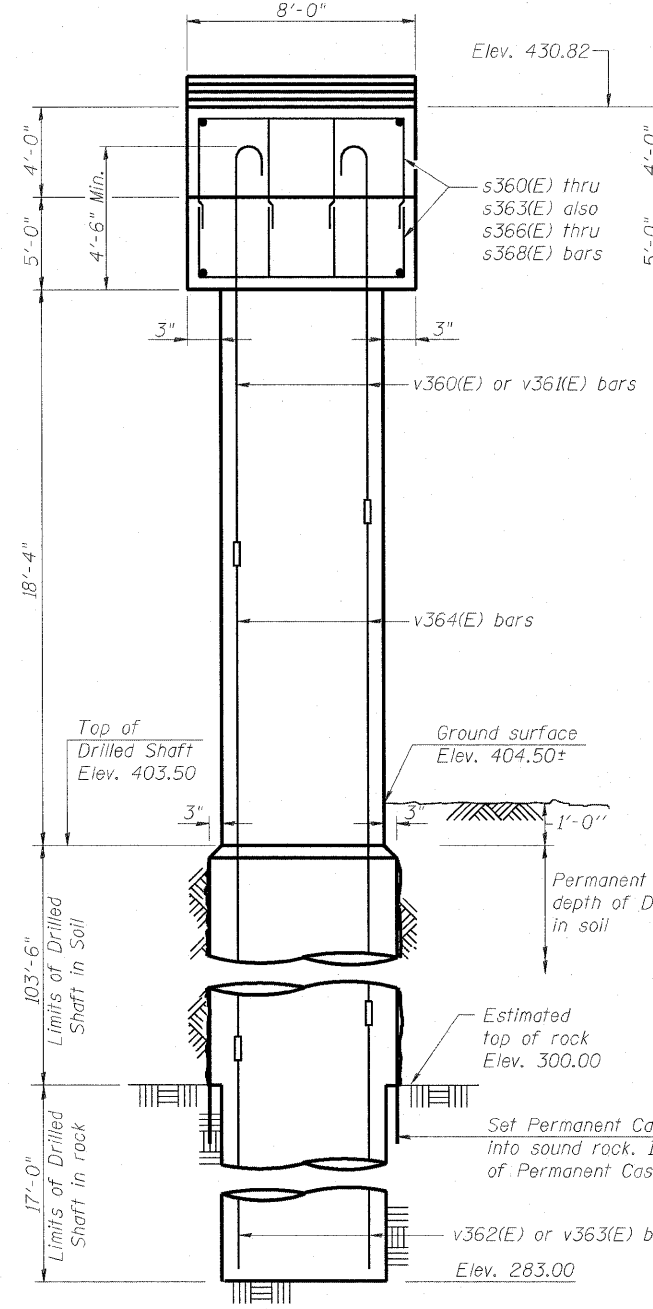

END VIEW

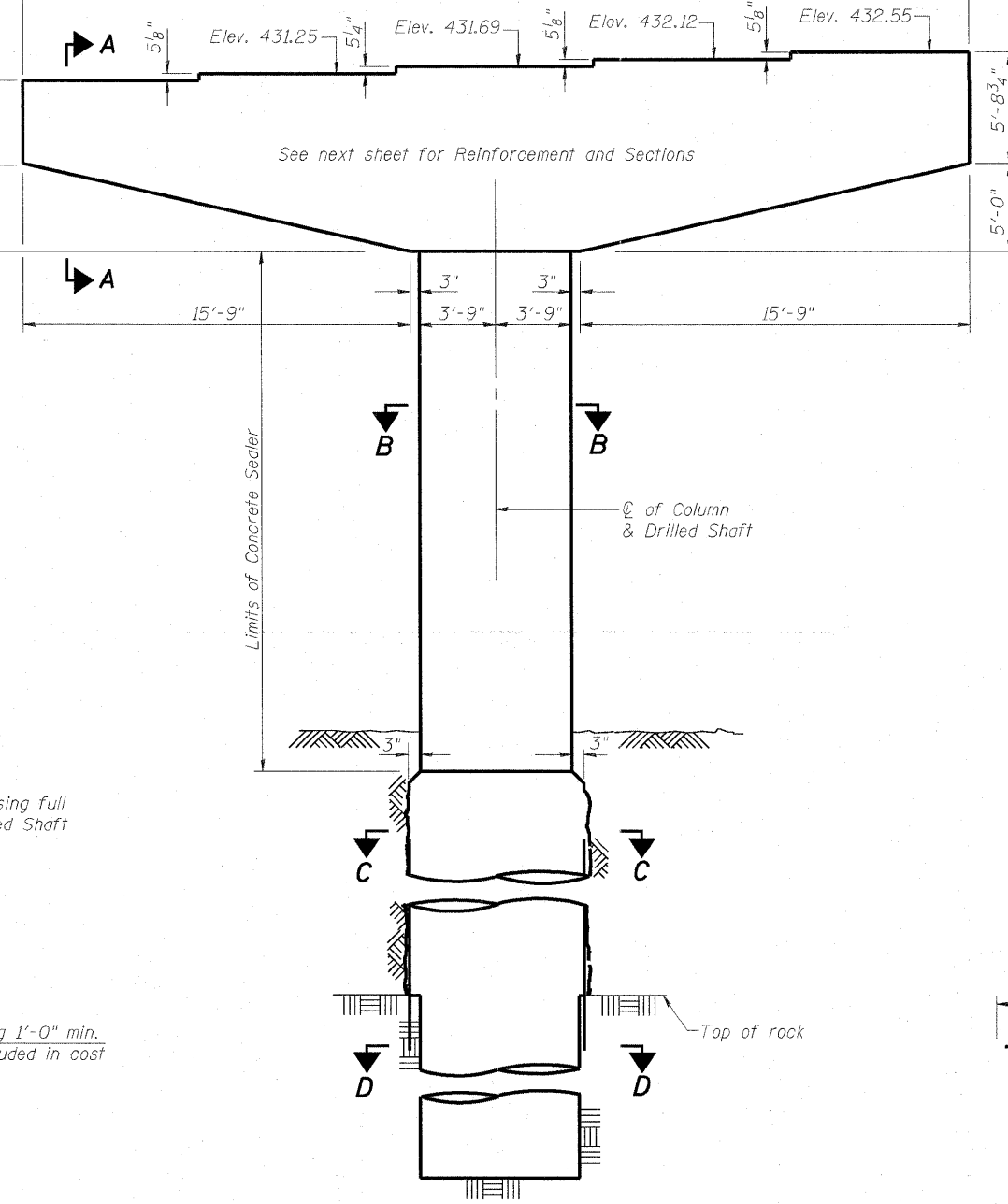

ELEVATION (Looking Up Station)

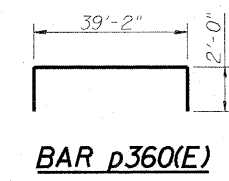

BAR p360(E)

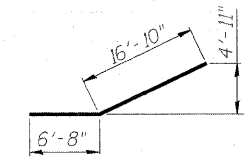

BAR p361(E)

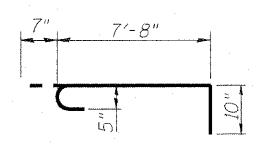

BAR s365(E)

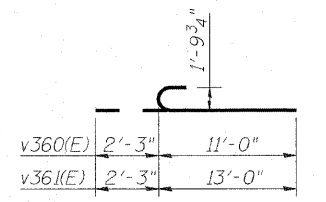

BAR v360(E) & v361(E)



USER NAME =
 PLOT SCALE = 0.166667' / IN.
 PLOT DATE = 8/15/2011

DESIGNED - DDB
 DRAWN - BRD
 CHECKED - LLV
 DATE - 08-12-11

REVISED -
 REVISED -
 REVISED -
 REVISED -

STATE OF ILLINOIS
 DEPARTMENT OF TRANSPORTATION

PIER - S.N. 082-0324 - PIER 4 - PLAN & ELEVATIONS
 I-70E OVER I-55, CSX & KCS RAILROADS

SCALE: SHEET S-181 OF S-234 SHEETS STA. TO STA.

F.A.I. RTE.	SECTION	COUNTY	TOTAL SHEETS	SHEET NO.
70	82-1-B-2	ST. CLAIR	399	308
S.N. 082-0322 & S.N. 082-0324		CONTRACT NO. 76C76		
FED. ROAD DIST. NO.		ILLINOIS FED. AID PROJECT		