

OUTSIDE ELEVATION OF PARAPET
(N.T.S.)

NOTE A:

Parapet & Anchorage Slab by
Others under contract 76C51.

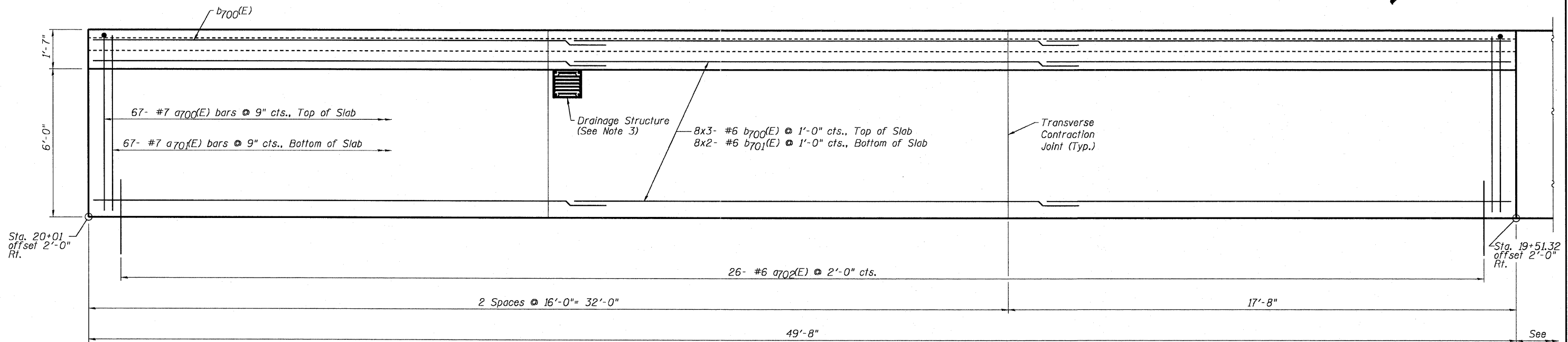
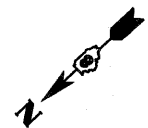

PLAN - PARAPET & ANCHORAGE SLAB
(N.T.S.)

Min. Bar Laps

Bar	Length
#4	2'-7"
#6	3'-10"
#8	6'-9"

NOTES:

- Optional full depth construction joints with 1/2" chamfers may be placed in Anchorage slab and parapet at contraction joint location(s).
- Bars indicated thus 7x2-#6 etc. indicates 7 lines of bars with 2 lengths per line.
- For Drainage Structure location, type, and size, see drainage sheets.
- For Section A-A see sheet S-2.

FILE #	FILE NAME = DBTr-76C76-shr-MomentSlab-01.dgn	USER NAME = BhattA	DESIGNED - DEV	REVISED -	STATE OF ILLINOIS DEPARTMENT OF TRANSPORTATION	PARAPET & ANCHORAGE SLAB		F.A.I. RTE. 70	SECTION 82-1-B-2	COUNTY ST. CLAIR	TOTAL SHEETS 399	SHEET NO. 372
	PLOT SCALE = 0:2.00000 1/2" = 1'-0"	CHECKED - ATB	REVISOR -	DATE - 07-01-11		SCALE: N.T.S.	SHEET S-1 OF S-2 SHEETS	STA. 19+51.32 TO STA. 20+01	FED. ROAD DIST. NO. ILLINOIS FED. AID PROJECT	CONTRACT NO. 76C76		