

EXISTING UTILITIES SHOWN HEREON ARE BASED ON INFORMATION PROVIDED BY THE DISTRICT. PROPOSED SEWERS SHOWN HEREON ARE BASED ON THE PROPOSED DRAINAGE DESIGN SHOWN WITHIN THESE PLANS. THE CONTRACTOR IS RESPONSIBLE FOR IDENTIFYING ALL EXISTING UTILITIES PRIOR TO CONSTRUCTION. THE CONTRACTOR SHALL REFER TO S.U.E. PLANS FOR FURTHER UTILITY INFORMATION.

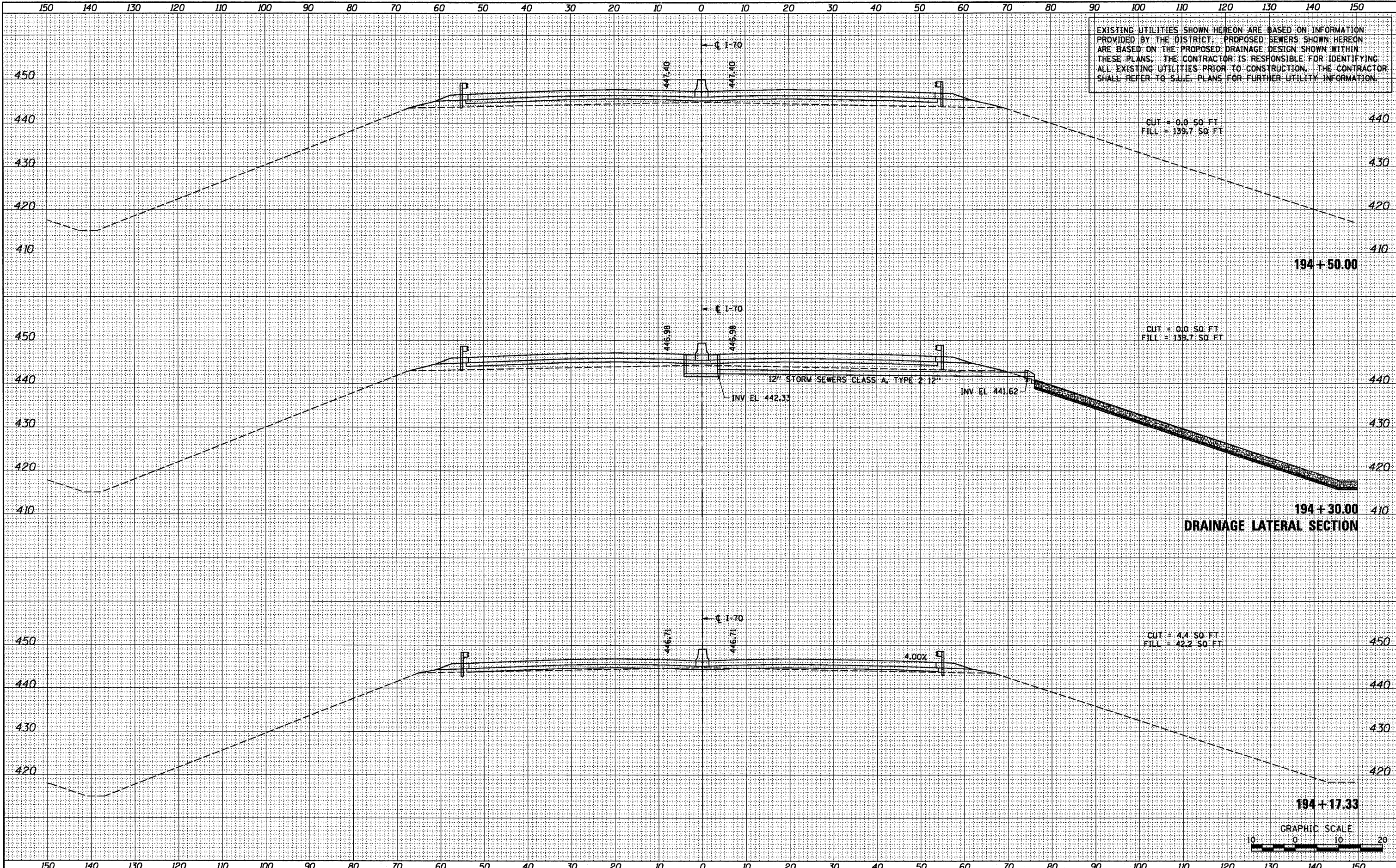

DATE	
BY	
FINAL SURVEY	
SURVEYED	
PLOTTED	
DATE	
NOTE BOOK	
NO.	
AREAS CHECKED	

DATE	
BY	
ORIGINAL SURVEY	
SURVEYED	
PLOTTED	
DATE	
NOTE BOOK	
NO.	
AREAS CHECKED	

DRAINAGE LATERAL SECTION

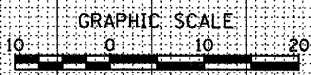

FILE NAME =	USER NAME = searsb	DESIGNED	OP	REVISED	-	STATE OF ILLINOIS DEPARTMENT OF TRANSPORTATION	CROSS SECTIONS - I-70		F.A.I. RTE.	SECTION	COUNTY	TOTAL SHEETS	SHEET NO.
P:\P60246629\1020_Geopak\76C76\XS-Sheets\08TR-76C76-sh1.XS.170.dgn		DRAWN	OP	REVISED	-		64/998	82-1-B-2	ST. CLAIR	399	379		
PLOT SCALE = 20.0000' / in.		CHECKED	DBM	REVISED	-		STA. 194+17.33 TO STA. 194+50.00		CONTRACT NO. 76C76				
PLOT DATE = 6/30/2011		DATE	07-01-11	REVISED	-		FED. ROAD DIST. NO. ILLINOIS FED. AID PROJECT						
							SCALE: 1" = 10'	SHEET NO. 2 OF 4 SHEETS					