

EXISTING UTILITIES SHOWN HEREON ARE BASED ON INFORMATION PROVIDED BY THE DISTRICT. PROPOSED SEWERS SHOWN HEREON ARE BASED ON THE PROPOSED DRAINAGE DESIGN SHOWN WITHIN THESE PLANS. THE CONTRACTOR IS RESPONSIBLE FOR IDENTIFYING ALL EXISTING UTILITIES PRIOR TO CONSTRUCTION. THE CONTRACTOR SHALL REFER TO S.U.E. PLANS FOR FURTHER UTILITY INFORMATION.

DATE	
BY	
FINAL SURVEY	
PLOTTED	
NOTE BOOK	
AREAS CHECKED	
NO.	

DATE	
BY	
ORIGINAL SURVEY	
PLOTTED	
NOTE BOOK	
AREAS CHECKED	
NO.	

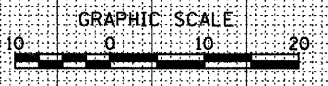
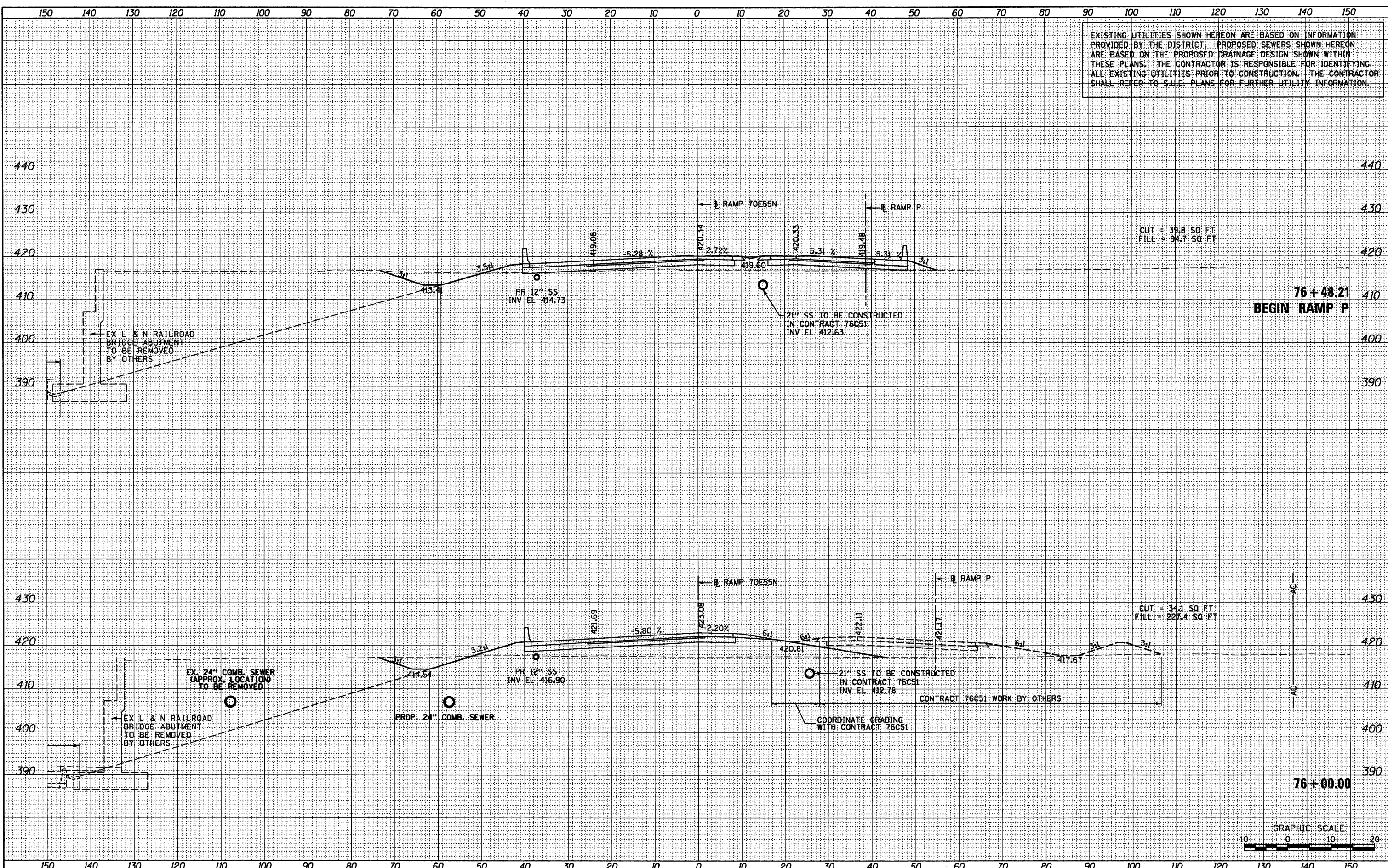

FILE NAME =	USER NAME = searab	DESIGNED	OP	REVISED	-	<b>STATE OF ILLINOIS DEPARTMENT OF TRANSPORTATION</b>	<b>CROSS SECTIONS - I-70 / RAMP 70E55N</b>		F.A.I. RTE.	SECTION	COUNTY	TOTAL SHEETS	SHEET NO.
P:\P62046629\1020_Geopak\76C76\XS-Sheets\08TR	-76C76-sh1.XS_70E55N.dgn	DRAWN	OP	REVISED	-		64/998	82-1-B-2	ST. CLAIR	399	385		
PLT SCALE = 20.0000' / in.		CHECKED	DBM	REVISED	-		CONTRACT NO. 76C76						
PLT DATE = 6/30/2011		DATE	07-01-11	REVISED	-		SCALE: 1" = 10'			SHEET NO. 4 OF 7 SHEETS	STA. 76+00.00 TO STA. 76+48.21	FED. ROAD DIST. NO. ILLINOIS FED. AID PROJECT	