

RTE.	SECTION	COUNTY	TOTAL SHEETS	SHEET NO.
CH #14	94-00091-00-BR	HANCOCK	14	2
SUMMARY OF QUANTITIES, TYPICAL SECTIONS GENERAL NOTES AND TRAFFIC CONTROL PLAN				

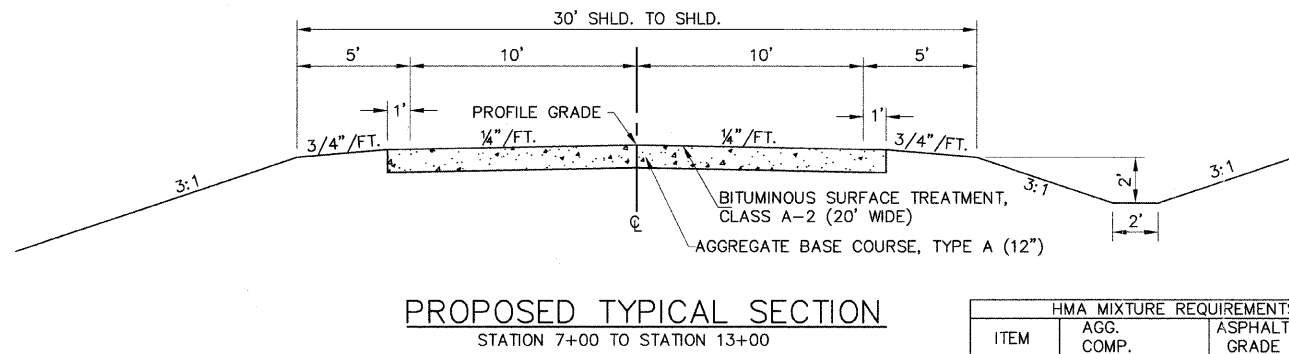

ITEM	AGG. COMP.	ASPHALT GRADE	DESIGN AIR VOIDS
SURFACE COURSE	IL-9.5 OR 12.5 MIX "C"	PG 64-22	4% @ N50

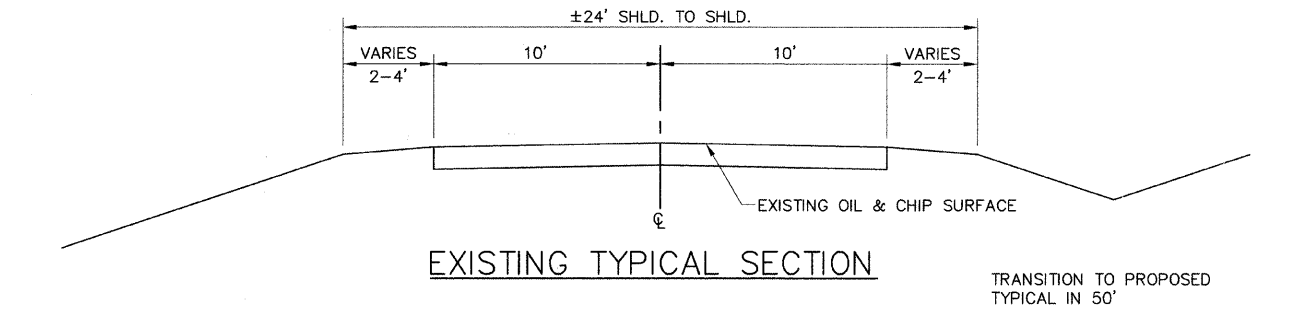
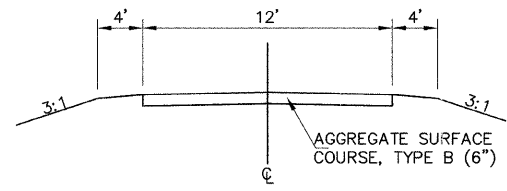
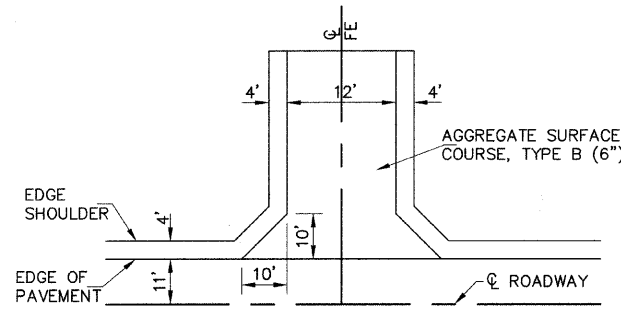

FE DETAIL

FE TYPICAL SECTION

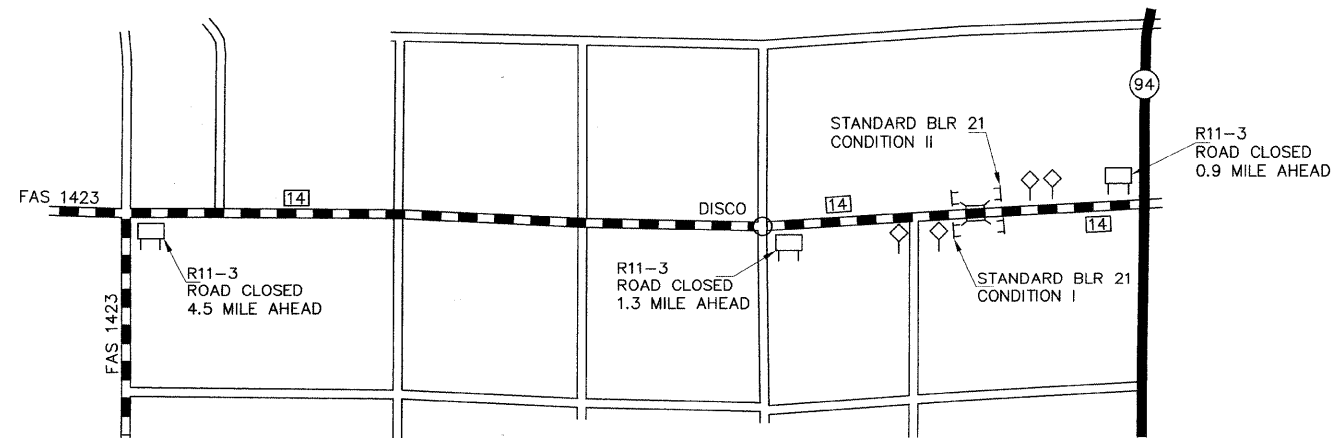

TRAFFIC CONTROL PLAN

SUMMARY OF QUANTITIES

ITEM NUMBER	ITEM	UNIT	TOTAL QUANTITY
20200100	EARTH EXCAVATION	CU YD	263
* 20300100	CHANNEL EXCAVATION	CU YD	200
* 20400800	FURNISHED EXCAVATION	CU YD	1,092
25000200	SEEDING, CLASS 2	ACRE	0.4
25000400	NITROGEN FERTILIZER NUTRIENT	POUND	36
25000500	PHOSPHOROUS FERTILIZER NUTRIENT	POUND	36
25000600	POTASSIUM FERTILIZER NUTRIENT	POUND	36
25000700	AGRICULTURAL GROUND LIMESTONE	TON	1.0
25100115	MULCH, METHOD 2	ACRE	0.4
28100205	STONE RIPRAP, CLASS A3	TON	170
35100100	AGGREGATE BASE COURSE, TYPE A	TON	935
40200800	AGGREGATE SURFACE COURSE, TYPE B	TON	38
40300100	BITUMINOUS MATERIALS (PRIME COAT)	GALLON	470
40300300	BITUMINOUS MATERIALS (COVER AND SEAL COATS)	GALLON	935
40300500	COVER COAT AGGREGATE	TON	18
40300600	SEAL COAT AGGREGATE	TON	18
40603310	HOT-MIX ASPHALT SURFACE COURSE, MIX "C", N50	TON	23
* 50100100	REMOVAL OF EXISTING STRUCTURES	EACH	1
50300225	CONCRETE STRUCTURES	CU YD	29.2
* 50400405	PRECAST PRESTRESSED CONCRETE DECK BEAMS (21" DEPTH)	SQ FT	1,610
50800205	REINFORCEMENT BARS, EPOXY COATED	POUND	3,230
Δ 50900205	STEEL RAILING, TYPE S-1	FOOT	108
51200956	FURNISHING METAL SHELL PILES 12"X0.179"	FOOT	414
51202305	DRIVING PILES	FOOT	414
51203200	TEST PILE METAL SHELLS	EACH	1
51500100	NAME PLATES	EACH	1
542D0223	PIPE CULVERTS, CLASS D, TYPE 1 18"	FOOT	38
542D0229	PIPE CULVERTS, CLASS D, TYPE 1 24"	FOOT	40
58100200	WATERPROOFING MEMBRANE SYSTEM	SQ YD	179
Δ 63000001	STEEL PLATE BEAM GUARDRAIL, TYPE A, 6 FOOT POSTS	FOOT	25
Δ 63100075	TRAFFIC BARRIER TERMINAL, TYPE 5A	EACH	2
67100100	MOBILIZATION	L SUM	1
Δ LR631020	TRAFFIC BARRIER TERMINAL, TYPE 1	EACH	2
* X2810208	STONE RIPRAP, CLASS A4 (SPECIAL)	TON	349
* X7010216	TRAFFIC CONTROL AND PROTECTION, (SPECIAL)	L SUM	1

* DENOTES SPECIAL PROVISION
Δ SPECIALTY ITEMS
CONSTRUCTION TYPE CODE 0011-(X080)

GENERAL NOTES

THE REMOVAL OF EXISTING ROADWAY WHICH MAY BE NECESSARY FOR THE CONSTRUCTION OF THE NEW BRIDGE AND APPROACHES SHALL BE REMOVED AS EARTH EXCAVATION AND NO ADDITIONAL COMPENSATION WILL BE ALLOWED. ALL WASTE OR UNDESIRABLE MATERIAL AS IDENTIFIED BY THE ENGINEER SHALL BE DISPOSED OF OUTSIDE THE LIMITS OF THE RIGHT OF WAY AT THE CONTRACTORS EXPENSE.

ALL EXISTING PRIVATELY OWNED UTILITIES REQUIRING ADJUSTMENT WILL BE MADE BY THE UTILITY COMPANY INVOLVED. WHERE NO PROVISIONS HAVE BEEN MADE FOR ADJUSTMENTS ON THE PLANS, NO ADDITIONAL COMPENSATION WILL BE ALLOWED DUE TO DELAYS OR INCONVENIENCES CAUSED BY THE SAID UTILITY ADJUSTMENTS.

THE LOCATION OF THE UNDERGROUND UTILITIES SHOWN ON THE PLANS REPRESENTS THE BEST KNOWLEDGE OF THE COUNTY. IT SHALL BE THE CONTRACTOR'S RESPONSIBILITY TO VERIFY LOCATIONS OF UNDERGROUND INSTALLATIONS BEFORE STARTING CONSTRUCTION OPERATIONS. THE CONTRACTOR SHALL INDEMNIFY THE COUNTY, ITS OFFICERS AND EMPLOYEES AGAINST ALL CLAIMS DUE TO DAMAGE TO CORPORATE OR PRIVATE PROPERTY RESULTING FROM HIS CONSTRUCTION OPERATIONS AS DESCRIBED IN ARTICLES 107.2 AND 107.26 OF THE STANDARD SPECIFICATIONS.

THE CONTRACTOR MAY BE REQUIRED TO CONDUCT SOME OF HIS GRADING AND TRENCHING OPERATIONS AROUND TRANSMISSION POLES AND UNDER TRANSMISSION LINES. THE ADDED COST OF SO DOING SHALL BE INCLUDED IN THE COST OF EARTH EXCAVATION.

WHERE SECTION OR SUBSECTION MONUMENTS ARE ENCOUNTERED, THE ENGINEER SHALL BE NOTIFIED BEFORE SUCH MONUMENTS ARE REMOVED. THE CONTRACTOR SHALL PROTECT AND PRESERVE PROPERTY MARKERS UNTIL THE OWNER, AN AUTHORIZED SURVEYOR, OR AGENT, HAS WITNESSED OR OTHERWISE REFERENCED THEIR LOCATION.

ALL ELEVATIONS SHOWN REFER TO AN U.S.G.S. MEAN SEA LEVEL DATUM.

THE REMOVAL OF EXISTING ENTRANCE CULVERTS SHALL BE INCLUDED IN THE COST OF EARTH EXCAVATION.

PSBA
POPPING, STONE, BACH & ASSOCIATES, INC.
ARCHITECTS ENGINEERS PLANNERS SURVEYORS

REVISIONS	
NAME	DATE

HANCOCK COUNTY
SECTION 94-00091-00-BR
SUMMARY OF QUANTITIES
TYPICAL CROSS SECTIONS
GENERAL NOTES
TRAFFIC CONTROL PLAN

SCALE: VERT. _____
HORIZ. _____
DATE _____ DRAWN BY: GPR
CHECKED BY: _____