

COUNTY	RTE. NO.	SECTION	SHT. NO.
ADAMS	CH# 14	94-00091-00-BR	5

STA. 9+22 TO STA. 10+13

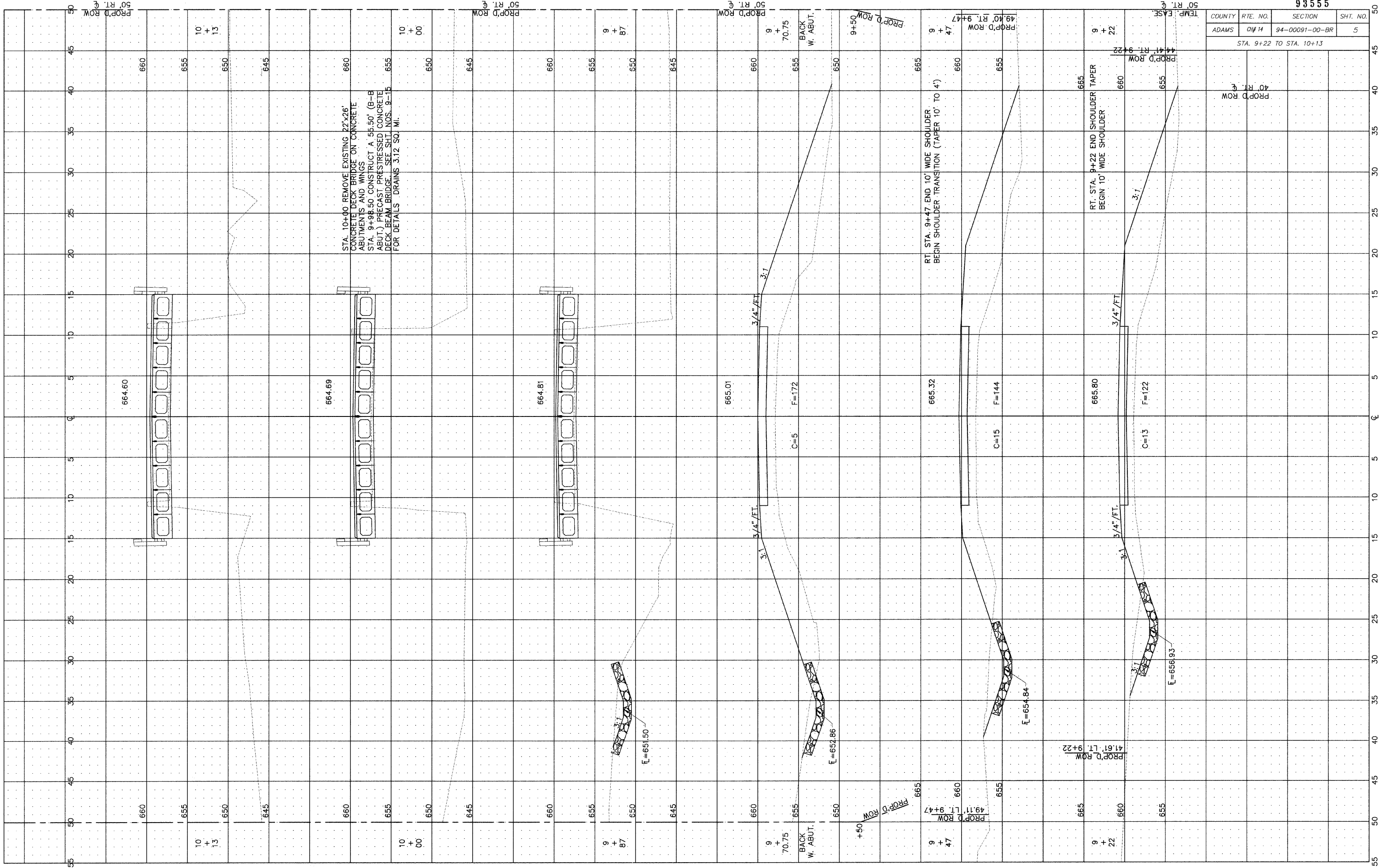

STA. 10+00 REMOVE EXISTING 22'x26' CONCRETE DECK BRIDGE ON CONCRETE ABUTMENTS AND WINGS
 STA. 9+98.50 CONSTRUCT A .55.50' (B-B ABUT.) PRECAST PRESTRESSED CONCRETE DECK BEAM BRIDGE. SEE SHT. NOS. 9-15 FOR DETAILS. DRAINS 3.12 SQ. MI.

RT. STA. 9+47 END 10' WIDE SHOULDER. BEGIN SHOULDER TRANSITION (TAPER 10' TO 4')

RT. STA. 9+22 END SHOULDER TAPER BEGIN 10' WIDE SHOULDER