

STORM SEWERS

26	12 TO 14	140 FT. 21" SS2 @ 0.64% TRENCH BACKFILL 120.4 CU. YDS.	35	21 TO 22	125 FT. 15" SS2 @ 0.68% TRENCH BACKFILL 82.4 CU. YDS.
27	13 TO 14	30 FT. 12" SS1 WMQ @ 10.83% TRENCH BACKFILL 0.7 CU. YDS.	36	22 TO 23	125 FT. 15" SS2 @ 0.68% TRENCH BACKFILL 49.8 CU. YDS.
28	14 TO 15	60 FT. 24" SS2 WMQ @ 2.72% TRENCH BACKFILL 64.5 CU. YDS.	37	23 TO 24	73 FT. 15" SS2 @ 1.66% TRENCH BACKFILL 55.6 CU. YDS.
29	15 TO EX	90 FT. 24" SS2 WMQ @ 0.30% TRENCH BACKFILL 92.6 CU. YDS.	48	34 TO 22	39 FT. 12" SS1 @ 2.33% TRENCH BACKFILL 4.0 CU. YDS.
34	20 TO 21	48 FT. 15" SS2 @ 0.60% TRENCH BACKFILL 2.4 CU. YDS.			

DRAINAGE STRUCTURES

13	PRCF END SECTION, 12" STA. 213+60, 50.00' RT. F.L. = 610.50	21	INLET TY. B-3V STA. 212+50, 19.54' RT. T.C. = 610.42 15" S.E. F.L. = 604.15 15" W. F.L. = 604.05
14	MH 5' DIA., TY. A-3V STA. 213+43.60, 22.26' RT. T.C. = 611.11 12" S.E. F.L. = 607.25 21" E. F.L. = 603.95 24" N.W. F.L. = 603.85	22	INLET TY. B-3V STA. 211+25, 19.54' RT. T.C. = 609.17 15" E. F.L. = 603.20 12" N. F.L. = 605.50 15" W. F.L. = 603.10
15	MH 4' DIA., TY. 1, CLOSED LID STA. 212+88, 0.00' RT. TOP = 610.78 24" E. F.L. = 602.22 24" N. F.L. = 602.12	23	INLET TY. B-3V STA. 210+00, 19.54' RT. T.C. = 607.94 15" E. F.L. = 602.25 15" W. F.L. = 602.15
20	INLET TY. B, TY.1 CLOSED LID STA. 212+88, 48.00' RT. TOP = 611.75 12" S. F.L. = 604.69 15" N.W. F.L. = 604.44	34	INLET TY. A-3V STA. 211+25, 19.54' LT. T.C. = 609.41 12" S. F.L. = 606.41

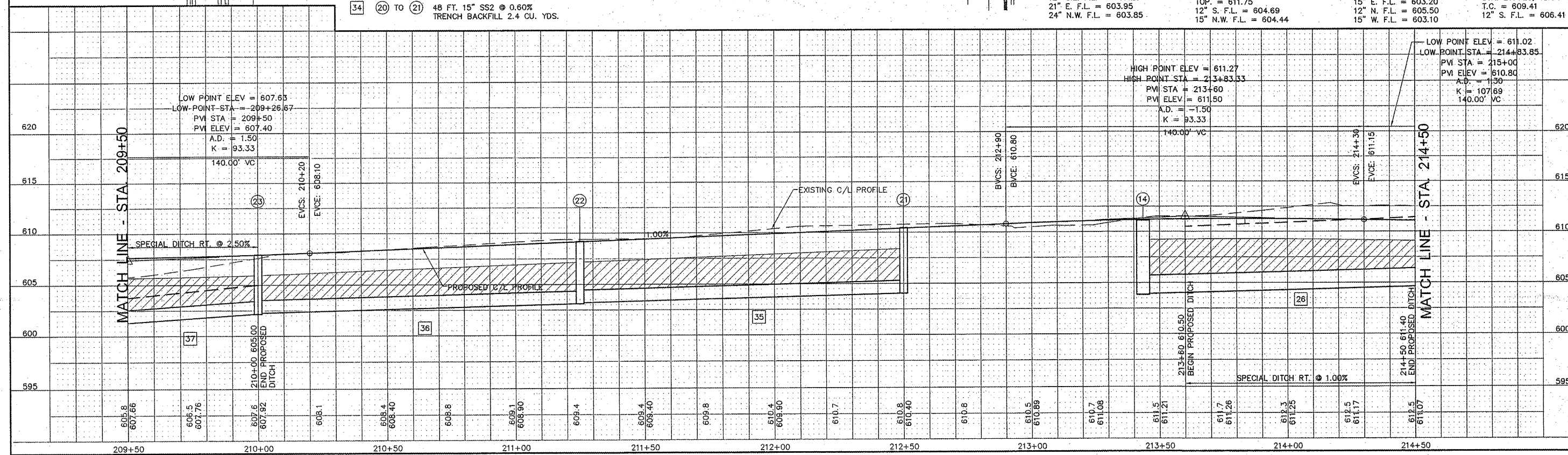

CONTRACT NO. 97476

SCALE IN FEET

REVISIONS

Sheppard, Morgan & Schwaab, Inc.
CONSULTING ENGINEERS AND LAND SURVEYORS
215 Market Street, P.O. Box E, Alton, IL 62002 618462-9755 Email: mail@smsengineers.com
10 Central Industrial Drive, Granite City, IL 62040 618877-8700 Email: mail@smsengineers.com
DESIGN FIRM # 184-000992

SMS ENGINEERS

BENCHMARKS: SEE SHEET NO. 3

VILLAGE OF GODFREY, ILLINOIS
SECTION 04-00019-00-PV
CROSSTOWN ROAD - PHASE 1 A
PLAN AND PROFILE

DWG. NO.	GCTR ROADWAY PP 15.dwg
REF. BK	PG
JOB NO.	237334
DSN. BY:	DEG
DWN. BY:	CAD
CHK. BY:	DEG
DATE:	APRIL, 2011
SCALE:	1" = 20' H. 1" = 5' V.
SHEET	9 OF 38