



REVISIONS

Sheppard, Morgan & Schwab, Inc.
CONSULTING ENGINEERS AND LAND SURVEYORS
215 Market Street, P.O. Box E, Alton, IL 62002 618429-9755 E-mail: mail@smsengineers.com
10 Central Industrial Drive, Granite City, IL 62040 618877-8100 E-mail: mail@smsengineers.com
DESIGN FIRM # 184-000992



VILLAGE OF GODFREY, ILLINOIS
SECTION 04-00019-00-PV
CROSSTOWN ROAD - PHASE 1 A
PLAN AND PROFILE

DWG. NO. GCTR ROADWAY PP 16.DWG
REF. SK PG.
JOB NO. 237334
DSN. BY: DEG
DWN. BY: CAD
CHK. BY: DEG
DATE: APRIL, 2011
SCALE: 1" = 20' H.
1" = 5' V.
SHEET 10 OF 38

MATCH LINE - STA. 214+50

MATCH LINE - STA. 219+50

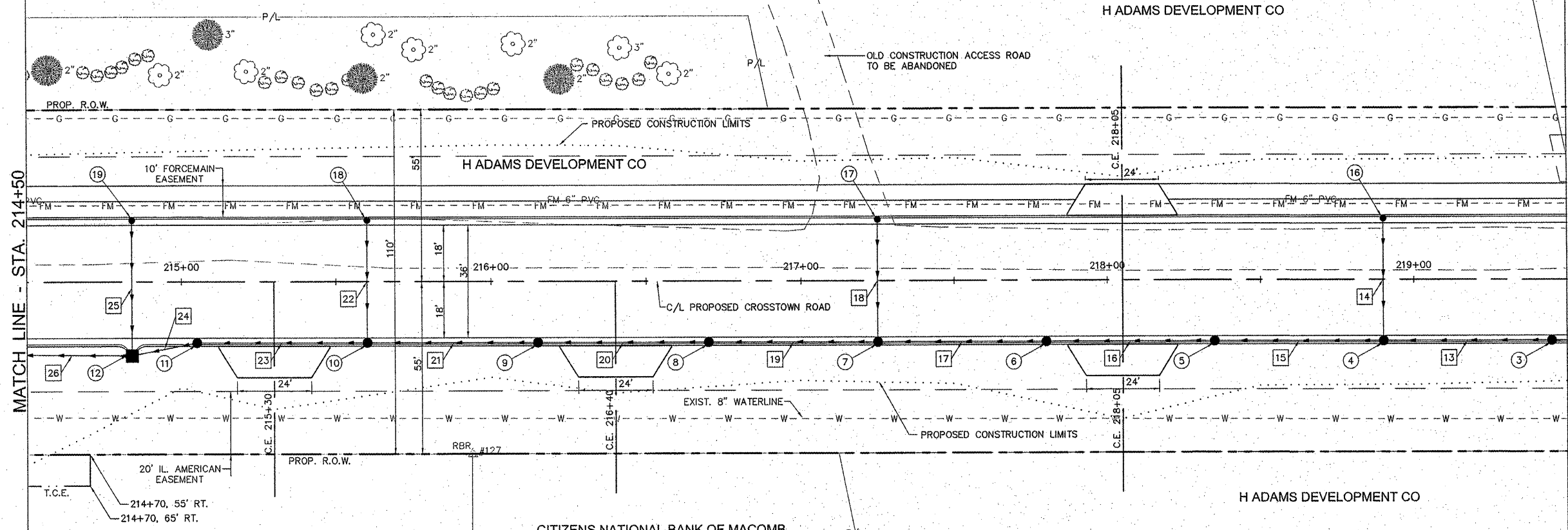

DRAINAGE STRUCTURES

- | | | | | |
|--|--|--|---|---|
| <p>③ INLET TY. B-3V
STA. 219+45, 19.54' RT.
T.C. = 614.38
12" E. F.L. = 610.70
12" W. F.L. = 610.60</p> | <p>⑥ INLET TY. B-3V
STA. 217+80, 19.54' RT.
T.C. = 613.06
15" E. F.L. = 608.75
15" W. F.L. = 608.65</p> | <p>⑨ INLET TY. B-3V
STA. 216+15, 19.54' RT.
T.C. = 611.74
18" E. F.L. = 607.10
18" W. F.L. = 607.00</p> | <p>⑫ INLET BOX, SPECIAL
STA. 214+83.85, 23.08' RT.
T.C. = 611.04
12" N. F.L. = 607.37
18" E. F.L. = 605.10
21" W. F.L. = 604.85</p> | <p>⑱ INLET TY. A-3V
STA. 215+60, 19.54' LT.
T.C. = 611.54
12" S. F.L. = 608.54</p> |
| <p>④ INLET TY. B-3V
STA. 218+90, 19.54' RT.
T.C. = 613.94
12" N. F.L. = 610.27
12" E. F.L. = 610.05
12" W. F.L. = 609.95</p> | <p>⑦ INLET TY. B-3V
STA. 217+25, 19.54' RT.
T.C. = 612.62
12" N. F.L. = 608.95
15" E. F.L. = 608.23
15" W. F.L. = 608.13</p> | <p>⑩ INLET TY. B-3V
STA. 215+60, 19.54' RT.
T.C. = 611.30
12" N. F.L. = 607.63
18" E. F.L. = 606.34
18" W. F.L. = 606.24</p> | <p>⑭ INLET TY. A-3V
STA. 218+90, 19.54' LT.
T.C. = 614.18
12" S. F.L. = 611.18</p> | <p>⑲ INLET TY. A-3V
STA. 214+83.85, 19.54' LT.
T.C. = 611.28
12" S. F.L. = 608.28</p> |
| <p>⑤ INLET TY. B-3V
STA. 218+35, 19.54' RT.
T.C. = 613.50
12" E. F.L. = 609.40
15" W. F.L. = 609.15</p> | <p>⑧ INLET TY. B-3V
STA. 216+70, 19.54' RT.
T.C. = 612.18
15" E. F.L. = 607.65
18" W. F.L. = 607.40</p> | <p>⑪ INLET TY. B-3V
STA. 215+05, 19.54' RT.
T.C. = 611.06
18" E. F.L. = 605.41
18" W. F.L. = 605.31</p> | <p>⑰ INLET TY. A-3V
STA. 217+25, 19.54' LT.
T.C. = 612.86
12" S. F.L. = 609.86</p> | |

STORM SEWERS

- | | |
|--|--|
| <p>⑬ ③ TO ④ 55 FT. 12" SSI @ 1.00%
TRENCH BACKFILL 9.0 CU. YDS.</p> | <p>⑳ ⑧ TO ⑨ 55 FT. 18" SSI @ 0.55%
TRENCH BACKFILL 14.1 CU. YDS.</p> |
| <p>⑭ ⑬ TO ④ 39 FT. 12" SSI @ 2.33%
TRENCH BACKFILL 4.0 CU. YDS.</p> | <p>㉑ ⑨ TO ⑩ 55 FT. 18" SS2 @ 1.20%
TRENCH BACKFILL 15.5 CU. YDS.</p> |
| <p>⑮ ④ TO ⑤ 55 FT. 12" SSI @ 1.00%
TRENCH BACKFILL 10.1 CU. YDS.</p> | <p>㉒ ⑱ TO ⑩ 39 FT. 12" SSI @ 2.33%
TRENCH BACKFILL 4.0 CU. YDS.</p> |
| <p>⑯ ⑤ TO ⑥ 55 FT. 15" SSI @ 0.73%
TRENCH BACKFILL 11.7 CU. YDS.</p> | <p>㉓ ⑩ TO ⑪ 55 FT. 18" SS2 @ 1.50%
TRENCH BACKFILL 19.0 CU. YDS.</p> |
| <p>⑰ ⑥ TO ⑦ 55 FT. 15" SSI @ 0.76%
TRENCH BACKFILL 12.4 CU. YDS.</p> | <p>㉔ ⑪ TO ⑫ 21 FT. 18" SS2 @ 1.00%
TRENCH BACKFILL 14.7 CU. YDS.</p> |
| <p>⑱ ⑦ TO ⑧ 39 FT. 12" SSI @ 2.33%
TRENCH BACKFILL 4.0 CU. YDS.</p> | <p>㉕ ⑲ TO ⑫ 39 FT. 12" SS1 @ 2.33%
TRENCH BACKFILL 5.9 CU. YDS.</p> |
| <p>⑲ ⑦ TO ⑧ 55 FT. 15" SSI @ 0.87%
TRENCH BACKFILL 13.0 CU. YDS.</p> | <p>㉖ ⑫ TO ⑬ SEE PREVIOUS SHEET FOR PIPE DETAILS</p> |

BENCHMARKS: SEE SHEET NO. 3

MATCH LINE - STA. 214+50

MATCH LINE - STA. 219+50

