

CONTRACT NO.			
F.A.U. RTE.	SECTION	COUNTY	TOTAL SHEETS
8979	09-00017-01-PV	MADISON	34
STA. 33+50.00		TO STA. 39+90.94	
FED. ROAD DIST. NO.	ILLINOIS	FEDERAL AID PROJECT	
CONTRACT NO. 97479			

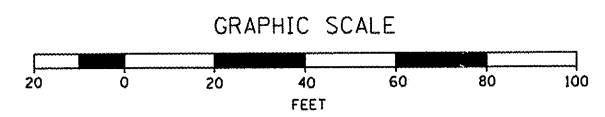

LEGEND	
	PVMT REM
	CCC&G OR CONC CURB REM
	TREE REM

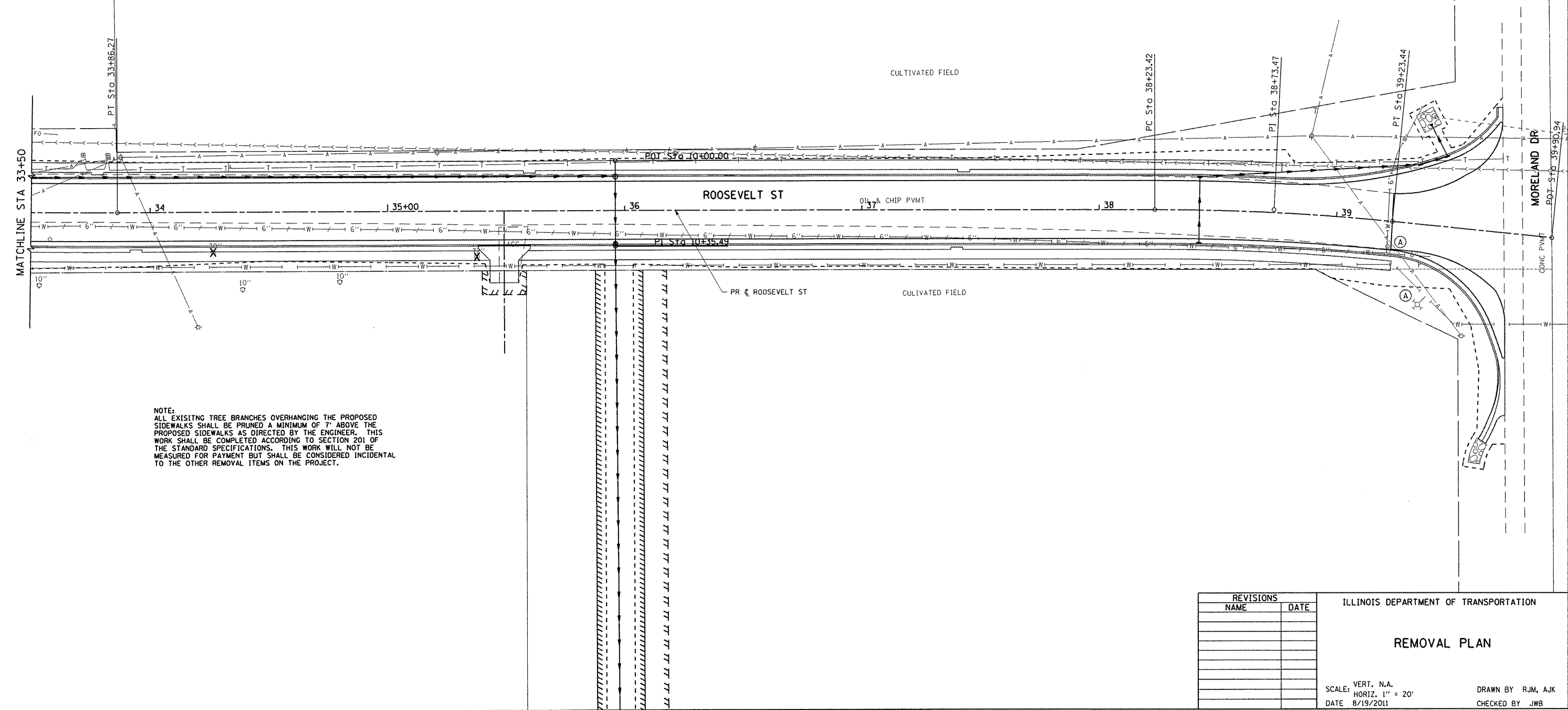

NOTE:
 ALL EXISTING TREE BRANCHES OVERHANGING THE PROPOSED SIDEWALKS SHALL BE PRUNED A MINIMUM OF 7' ABOVE THE PROPOSED SIDEWALKS AS DIRECTED BY THE ENGINEER. THIS WORK SHALL BE COMPLETED ACCORDING TO SECTION 201 OF THE STANDARD SPECIFICATIONS. THIS WORK WILL NOT BE MEASURED FOR PAYMENT BUT SHALL BE CONSIDERED INCIDENTAL TO THE OTHER REMOVAL ITEMS ON THE PROJECT.

PLOT DATE = 8/24/2011
 PLOT SCALE = 42.353' / IN.
 USER NAME = Aaron Klenke

REVISIONS	
NAME	DATE

ILLINOIS DEPARTMENT OF TRANSPORTATION

REMOVAL PLAN

SCALE: VERT. N.A.
 HORIZ. 1" = 20'
 DATE 8/19/2011

DRAWN BY RJM, AJK
 CHECKED BY JWB

REMOVAL PLAN: ROOSEVELT STREET - STA. 33+50.00 TO STA. 39+90.94