

F.A.P. RTE.	SECTION	COUNTY	TOTAL SHEETS	SHEET NO.
316	D2	STEPHENSON	4	1

••D2 PP 2023-1

CONTRACT NO. 64R98
D-92-033-23

11-18-2022 LETTING ITEM 068

STATE OF ILLINOIS
DEPARTMENT OF TRANSPORTATION
DIVISION OF HIGHWAYS

FOR INDEX OF SHEETS & STATE STANDARDS
SEE SHEET NO. 2

**PROPOSED
HIGHWAY PLANS**

F.A.P. ROUTE 316 (IL 26)
SECTION D2 PP 2023-01
STEPHENSON COUNTY
C-92-125-22



LOCATION OF SECTION INDICATED THIS: —

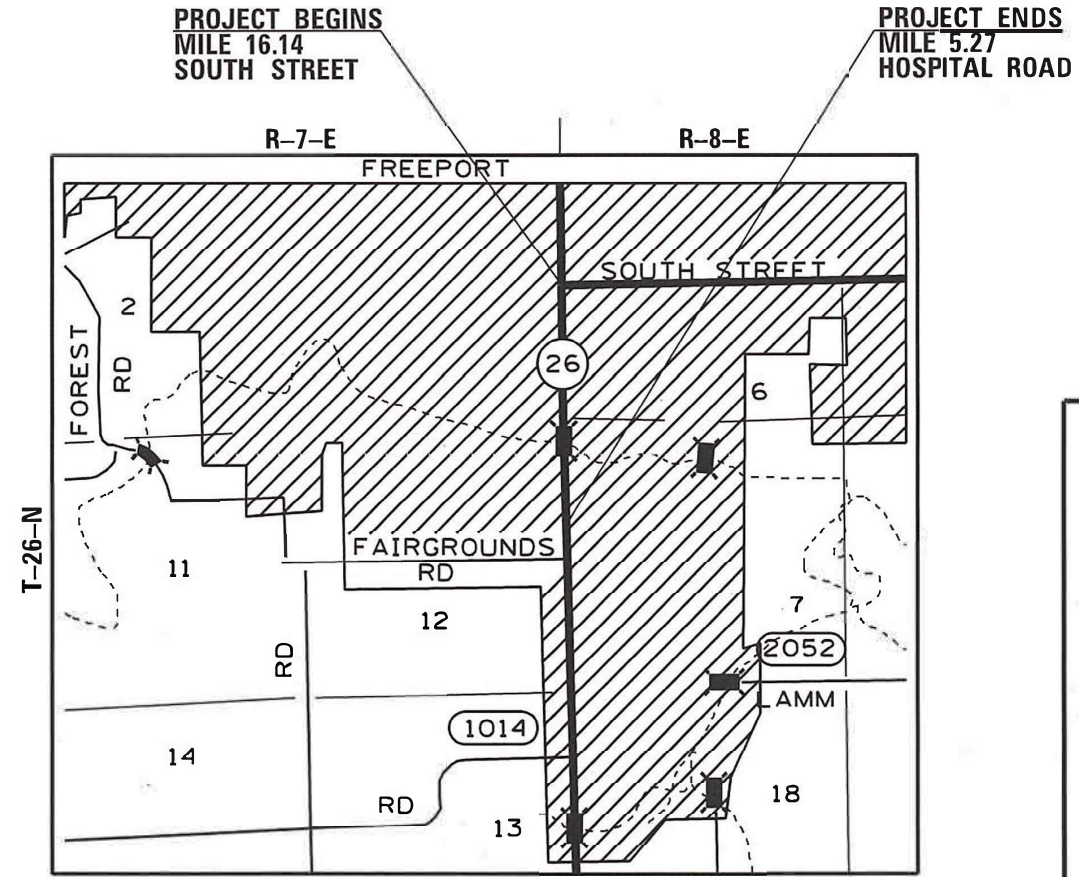

GROSS LENGTH OF PROJECT = 4224 FOOT = 0.8 MILES
NET LENGTH OF PROJECT = 4224 FOOT = 0.8 MILES

TOWNSHIP (SECTION):
FLORENCE (1, 12)
SILVER CREEK (6, 7)

J.U.L.I.E.
JOINT UTILITY LOCATION INFORMATION FOR EXCAVATION
1-800-892-0123

CONTRACT NO. 64R98

STATE OF ILLINOIS
DEPARTMENT OF TRANSPORTATION
DIVISION OF HIGHWAYS

SUBMITTED August 22 20 22
[Signature]
REGION ENGINEER

October 14, 2022
[Signature]
ENGINEER OF DESIGN AND ENVIRONMENT

October 14, 2022
[Signature]
DIRECTOR OF HIGHWAYS PROJECT IMPLEMENTATION

PRINTED BY THE AUTHORITY
OF THE STATE OF ILLINOIS

PROJECT ENGINEER: SCOTT KULLERSTRAND

SQUAD LEADER: LANCE NICKLAUS 815-284-5407

INDEX

- 1 Cover Sheet
- 2 Index of Sheets / State Standards
- 3 Summary of Quantities
- 4 General Notes

STATE STANDARDS

- | | |
|-----------|--|
| 420001-10 | PAVEMENT JOINTS |
| 420701-03 | PAVEMENT WELDED WIRE REINFORCEMENT |
| 442101-09 | CLASS B PATCHES |
| 701006-05 | OFF-ROAD OPERATIONS, 2L, 2W, 15' (4.5m) TO 24" (600mm) FROM PAVEMENT EDGE |
| 701101-05 | OFF-ROAD OPERATIONS, MULTILANE, 15'(4.5m) TO 24"(600mm) FROM PAVEMENT EDGE |
| 701106-02 | OFF-ROAD OPERATIONS, MULTILANE, MORE THAN 15'(4.5m) AWAY |
| 701602-10 | URBAN LANE CLOSURE, MULTILANE, 2W WITH BIDIRECTIONAL LEFT TURN LANE |
| 701701-10 | URBAN LANE CLOSURE, MULTILANE INTERSECTION |
| 701901-08 | TRAFFIC CONTROL DEVICES |
| 720011-01 | METAL POST FOR SIGNS, MARKERS AND DELINEATORS |
| 728001-01 | TELESCOPING STEEL SIGN SUPPORT |
| 729001-01 | APPLICATIONS OF TYPES A AND B METAL POST (FOR SIGNS & MARKERS) |

DISTRICT STANDARDS

- | | |
|------|---|
| 94.2 | Traffic Control & Protection at Turn Bays (To Remain Open to Traffic) |
| 34.1 | Work Zone Sign Details |

SUMMARY OF QUANTITIES

FAP 316 (IL 26)
SECTION 02 PP 2023-1
STEPHENSON COUNTY
CONTRACT #64R88
SHEET 3 OF 4

URBAN

100% State
0066

CODE NO.	ITEM	UNIT	TOTAL QUANTITY
44200050	WELDED WIRE REINFORCEMENT	SQ. YDS.	1,870
44200970	CLASS B PATCHES, TYPE II 10"	SQ. YDS.	1,217
44200974	CLASS B PATCHES, TYPE III 10"	SQ. YDS.	1,480
44200976	CLASS B PATCHES, TYPE IV 10"	SQ. YDS.	390
44201299	DOWEL BARS 1 1/2"	EACH	4860
44213200	SAW CUT	FOOT	11722
44213204	TIE BARS 3/4"	EACH	957
67100100	MOBILIZATION	L SUM	1
70102632	TRAFFIC CONTROL AND PROTECTION, STANDARD 701602	L SUM	1
70102635	TRAFFIC CONTROL AND PROTECTION, STANDARD 701701	L SUM	1
70103815	TRAFFIC CONTROL SURVEILLANCE	CAL DAY	15
70106800	CHANGEABLE MESSAGE SIGN	CAL MO	4

REV. 9/19/22

GENERAL NOTES

Closed expansion joints on jointed pavements shall be re-established during the patching operations. Class B Patches - when the pavement requires patching at the location of the expansion joint, a new joint should be established using a dowelled expansion patch as shown on Highway Standard 442101. When the joint is closed, but does not require patching, an expansion joint may be formed by sawing the pavement and filling the saw cut with a preformed expansion joint filler meeting the requirements of Section 1051 of the Standard Specifications as shown on Standard 420001.

When laying out for patching, the minimum distance between new patches (saw cut to saw cut) shall be 15 feet. When patch spacing is less than 15 feet, the pavement between patches shall also be removed and replaced.

Any raised reflective pavement markers removed during the patching operation shall not be replaced.

When laying out patches near an intersection contact Scott Kullerstrand in the office to see if detector loops Will be effected.

FILE NAME = 64R98 GN.DOCX	USER NAME =	DESIGNED - Engineering Systems	REVISED -	STATE OF ILLINOIS DEPARTMENT OF TRANSPORTATION	GENERAL NOTES	ROUTE	SECTION	COUNTY	TOTAL SHEETS	SHEET NO.		
		DRAWN -	REVISED -			FAP	D2 PP 2023-1	STEPHENSON	4	4		
	PLOT SCALE =	CHECKED -	REVISED -			316	CONTRACT NO. 64R98					
	PLOT DATE = 6/7/2022 3:19 PM	DATE - 7/29/2021 10:38 AM	REVISED -			SCALE:	SHEET NO.	OF	SHEETS	STA.	TO STA.	ILLINOIS