

ELEVATION - WALL 1

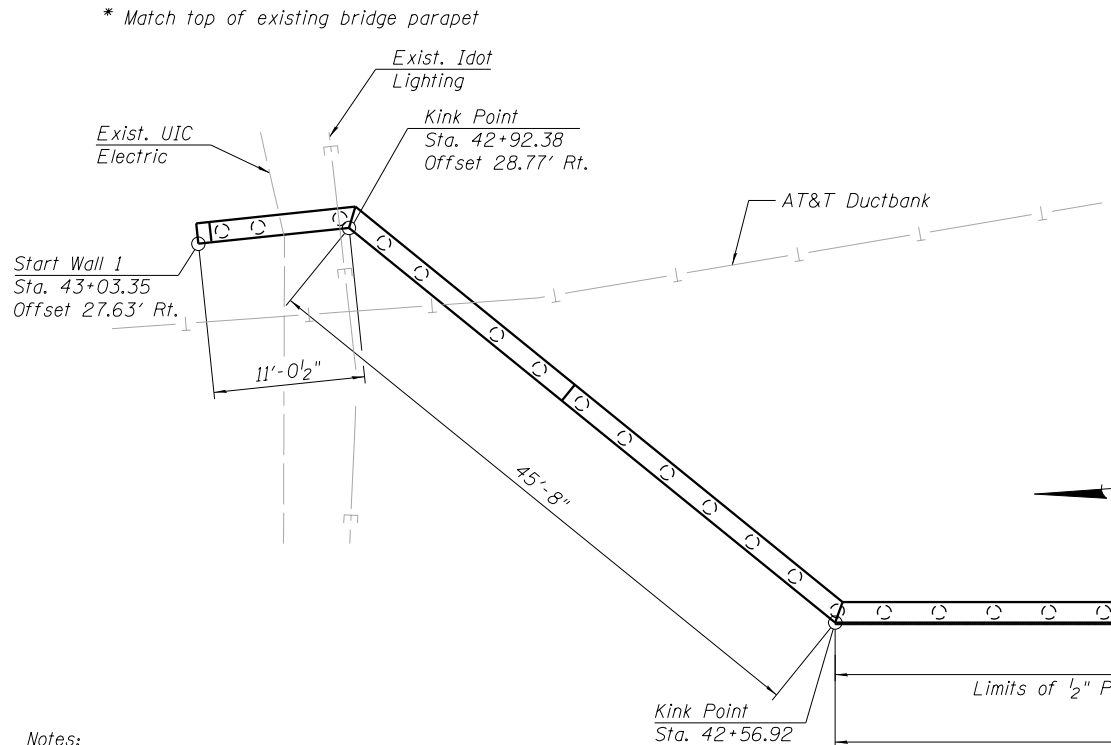

PLAN - WALL 1

Notes:
 For Section A-A and Bill of Material, see Sheet 3 of 7.
 Bars indicated 20x3-#5 etc. indicate 20 lines of bars with 3 lengths per line.
 Preformed Flexible Foam Expansion Joint Filler (called out as PJF in plans) shall follow Article 1051.09 of IDOT Standard Specifications. Cost included with Concrete Structures.
 Skate deterrents shall be spaced at ±2'-0" centers. See Detail B on sheet 5 of 7. Cost included with Concrete Structures.
 Rubbed Finish shall be applied to the F.F. and top of wall only.

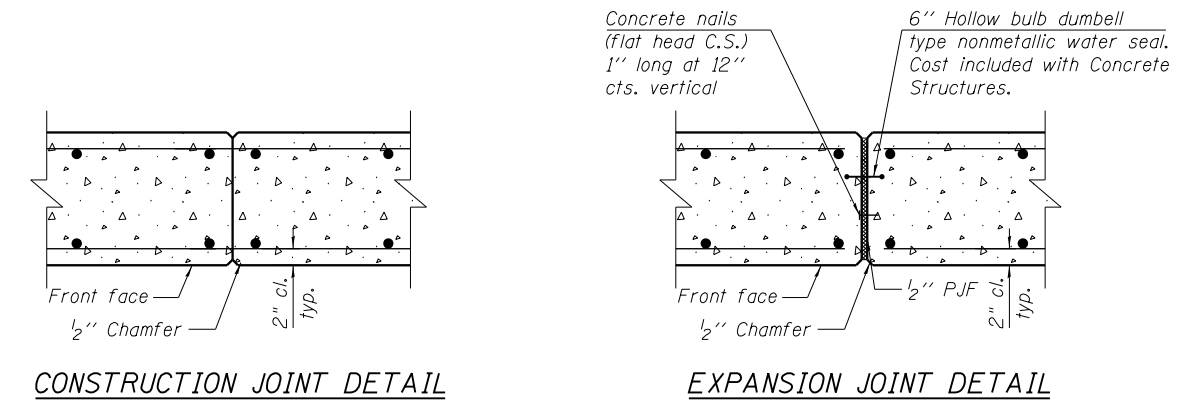

CONSTRUCTION JOINT DETAIL

EXPANSION JOINT DETAIL

1:50:41 PM 01/16/17 08-60x62-5002-Wall1.dgn



USER NAME = BAWIort	DESIGNED = WJC	REVISED
CHECKED = DL	REVISED	
PLOT SCALE = 14.0000' / in.	DRAWN = WJC	REVISED
PLOT DATE = 8/19/2014	CHECKED = DL/KAH	REVISED

STATE OF ILLINOIS
 DEPARTMENT OF TRANSPORTATION

RETAINING WALL 1
 PLAN AND ELEVATION

SHEET NO. 2 OF 7 SHEETS

MUN	SECTION	COUNTY	TOTAL SHEETS	SHEET NO.
2090	2013-0741	COOK	58	49
CONTRACT NO.			60X62	

ILLINOIS FED. AID PROJECT