

**LEGEND**

- DRUM WITH STEADY BURNING MONODIRECTIONAL LIGHT AT 40' C-C SPACING
- ⌋ BARRICADE TYPE III WITH FLASHING LIGHTS, QUANTITY AS REQUIRED FOR PROPER CLOSURE TO SATISFACTION OF THE ENGINEER
- ▮ VERTICAL PANEL
- TEMPORARY PAVEMENT MARKING
- ▬ TEMPORARY CONCRETE BARRIER
- ▨ IMPACT ATTENUATORS, TEMPORARY (NON-REDIRECTIVE), TEST LEVEL 3 (UNLESS NOTED OTHERWISE)
- ▧ TEMPORARY PAVEMENT CONSTRUCTED IN PRE-STAGE
- ⊥ TRAFFIC SIGN
- ➔ DIRECTION OF TRAFFIC
- ▨ WORK ZONE

**STAGING DESCRIPTIONS:**

**PRESTAGE:**

THE MEDIAN TO THE SOUTH OF THE CONSTRUCTION LIMITS AND THE MEDIAN TO THE NORTH OF THE CONSTRUCTION LIMITS WILL BE USED FOR A TEMPORARY CROSSOVER. SONSTRUCT USING TRAFFIC CONTROL AND PROTECTION STANDARD 701601 AND TRAFFIC CONTROL AT TRANSITIONS.

TEMPORARY PAVEMENT WILL BE INSTALLED IN LOCATIONS SHOWN IN THE STAGE 1 SHEETS FROM STA. 623+35 TO STA. 629+00, STA. 633+09.18 TO STA. 634+60.21, AND STA. 637+66 TO STA. 641+70.

INSTALL TEMPORARY LIGHTING SYSTEMS FOR CROSSOVERS ON NORTH AND SOUTH SIDE OF THE BRIDGE.

INLETS IN THE MEDIAN ADJUSTED WITH NEW TYPE 1 FRAME, CLOSED LID.

**STAGE 1:**

NORTHBOUND LANES OF THE BRIDGE AND ROADWAY WILL BE RECONSTRUCTED. USING TRAFFIC CONTROL AND PROTECTION STANDARD 701416 AND TRAFFIC CONTROL AT TRANSITIONS.

**STAGE 2:**

SOUTHBOUND LANES OF THE BRIDGE AND ROADWAY WILL BE RECONSTRUCTED. USING TRAFFIC CONTROL AND PROTECTION STANDARD 701416 AND TRAFFIC CONTROL AT TRANSITIONS.

**STAGE 3:**

REMOVE ALL REMAINING TEMPORARY PAVEMENT AND INSTALL MEDIAN IMPROVEMENTS.

PROPOSED CURB AND GUTTER AND TOPSOIL FOR LANDSCAPED MEDIAN COMPLETED USING TRAFFIC CONTROL AND PROTECTION STANDARD 701601 AND TRAFFIC CONTROL AT TRANSITIONS.

INLETS IN THE MEDIAN ADJUSTED WITH A NEW TYPE 8 GRATE.

**STAGING NOTES:**

IL 40 WILL REMAIN OPEN TO TWO-WAY TRAFFIC AT ALL TIMES. THIS SHALL BE ACCOMPLISHED IN ACCORDANCE WITH ARTICLE 107.14 OF THE STANDARD SPECIFICATIONS, THE MAINTENANCE OF TRAFFIC PLANS AND SPECIAL PROVISIONS.

STAGE 1&2 EARTHWORK QUANTITIES HAVE BEEN COMPUTED UP TO THE BACK OF THE PROPOSED CURB BETWEEN STATIONS 628+50 TO 637+00. NECESSARY EARTHWORK DURING THESE STAGES PAST THESE POINTS WILL NOT BE PAID FOR SEPARATELY AND SHALL BE INCLUDED IN THE COST OF THE VARIOUS EARTHWORK PAY ITEMS FOR THE PROJECT. EARTHWORK NECESSARY FOR CONSTRUCTION OF INSIDE MEDIANS HAVE BEEN INCLUDED IN STAGE 3.

FURNISHING BARRICADES, SPECIAL SIGNS AND OTHER INCIDENTALS NECESSARY TO COMPLETE THE MAINTENANCE OF TRAFFIC PLANS WILL NOT BE MEASURED FOR PAYMENT. THIS WORK SHALL BE CONSIDERED INCLUDED IN THE TRAFFIC CONTROL AND PROTECTION PAY ITEMS. TEMPORARY PAVEMENT MARKING AND WORK ZONE PAVEMENT MARKING REMOVAL WILL BE PAID FOR ACCORDING TO THE STANDARD SPECIFICATIONS.

DROP-OFFS 12" TO 18" FROM THE EDGE OF PAVEMENT ARE ALLOWED FOR A MAXIMUM OF 48 HOURS WITHOUT PROTECTION WITH TEMPORARY CONCRETE BARRIER. DROP-OFFS 12" TO 18" LONGER THAN 48 HOURS AND DROP-OFFS OVER 18" MUST BE PROTECTED WITH TEMPORARY CONCRETE BARRIER.

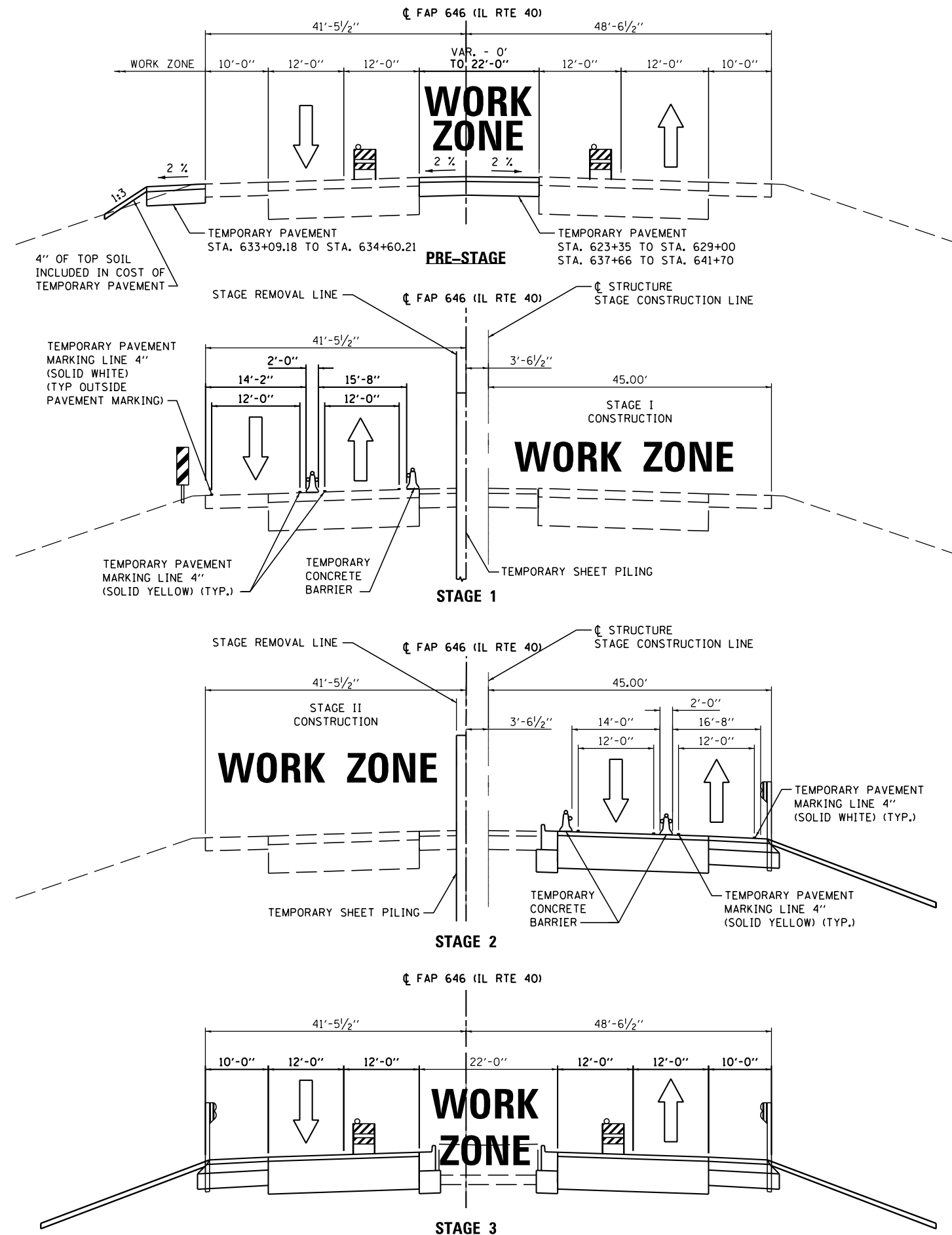

FILE NAME = s:\p1\6380--6395\6346\025\microsa\Shet\0264C17-sht-staging00.dgn



USER NAME = brianf	DESIGNED - VLF	REVISED -
	DRAWN - DJW	REVISED -
PLOT SCALE = 100.0000' / in.	CHECKED - MAG	REVISED -
PLOT DATE = 8/14/2014	DATE - 8-14-14	REVISED -

**STATE OF ILLINOIS  
DEPARTMENT OF TRANSPORTATION**

**MAINTENANCE OF TRAFFIC  
NOTES AND TYPICAL SECTIONS**

SCALE: NTS SHEET 1 OF 1 SHEETS STA. TO STA.

F.A.P. RTE. 646	SECTION 101 BR-3	COUNTY WHITESIDE	TOTAL SHEETS 130	SHEET NO. 32
CONTRACT NO. 64C17			FED. ROAD DIST. NO. 2 ILLINOIS FED. AID PROJECT	