

Existing Structure: Built as S.B.I. Rte. 68 Sec. 101 B-1 at Sta. 78+50 in 1964
 Existing spread P.P.C. Bms. with 7" concrete slab superstructure and R.C.
 cuts will be widened in Kind. Traffic shall be maintained over the
 existing structure during construction.

STATE OF ILLINOIS
 DEPARTMENT OF TRANSPORTATION
 DIVISION OF HIGHWAYS

Apply in two courses if thickness
 of Class I is more than 1 1/2"

PROJECT NO.	SECTION	COUNTY	TOTAL SHEETS	SHEET NO.
403	101 BR	WHITESIDE	589	270
SHEET NO. 11 SHEETS				

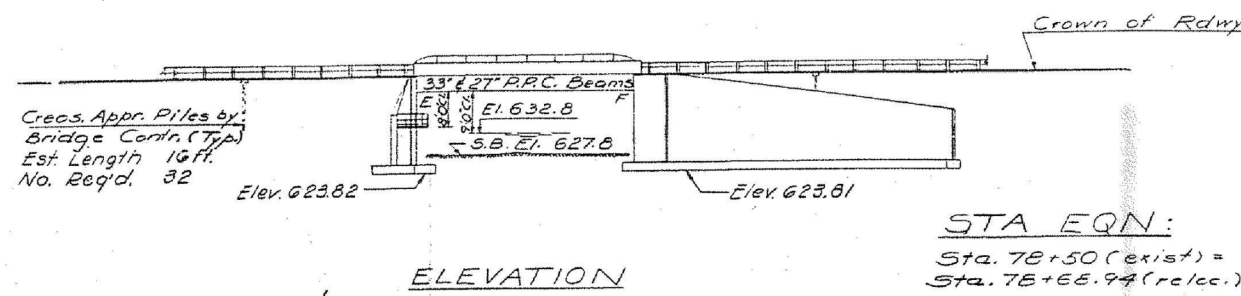

ELEVATION

STA EQN:
 Sta. 78+50 (exist) =
 Sta. 78+66.94 (relcc.)

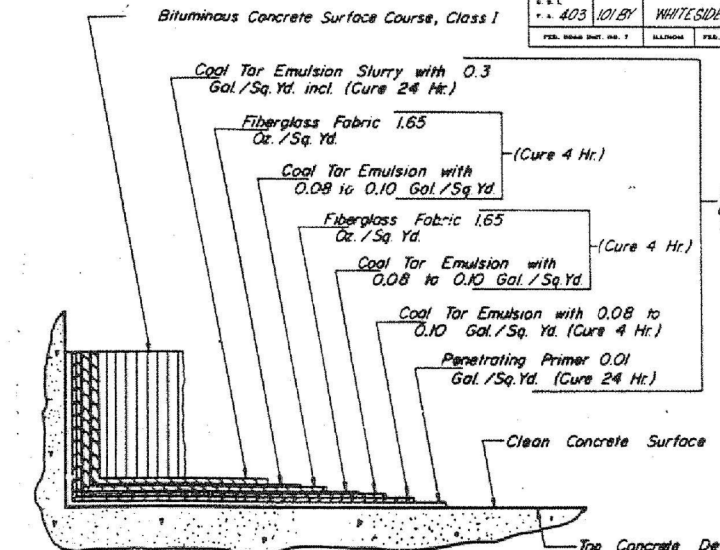

DETAIL OF DECK SURFACING

GENERAL NOTES
 All reinforcement bars shall be lapped 24 diameters unless otherwise shown.
 It shall be the responsibility of the Contractor to verify all dimensions and conditions existing in the field prior to construction and ordering of materials.
 An alternate strand pattern using Extra High Strength Prestressing strand (270 ksi) is permitted.
 Expansion bolts shall consist of self drilling expansion anchors and 3/4" hooked bolts. Hooked bolts shall extend a minimum of 12" into new concrete unless otherwise shown.
 The concrete rail section above the mandatory construction joint at the top of the slab top of P.P.C. Bms. shall be constructed of Class X Concrete, except the aggregates shall conform to the requirements of Handrail Concrete.
 The Basic Lead Silica Chromate paint system shall be used for shop painting of structural steel.
 Expansion guards which are not cast in the precast unit shall be fabricated and erected in accordance with Article 503.07(c) of the Standard Specifications and are included in quantity of structural steel.
 Protective Coat shall not be applied to surfaces to which Coal Tar Interlayer Protective Coat is applied.

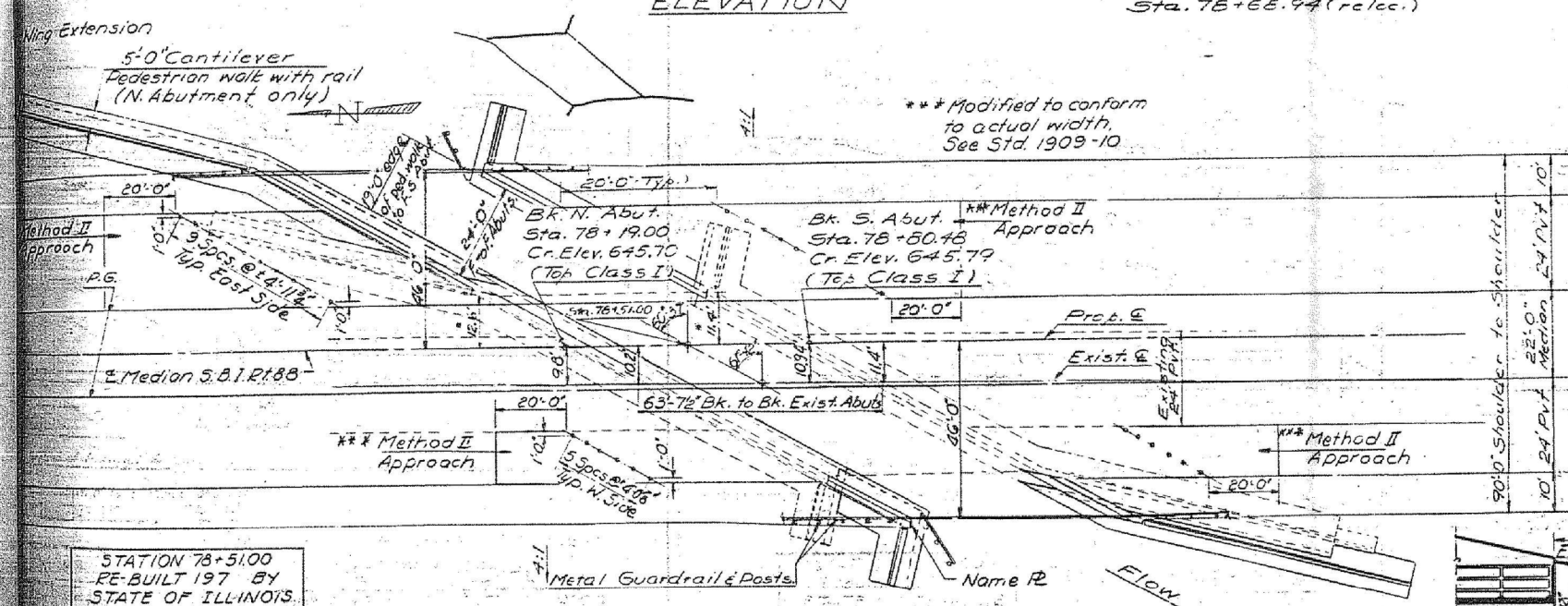

PLAN

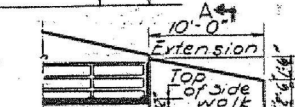

ELEVATION-WING EXTENSION

Weld wire fabric
 6" x 6" mesh weighing
 58#/100 Sq. Ft.
 Cost Incidental

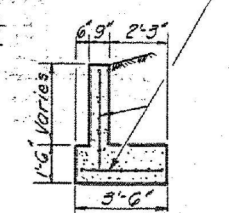

SEC. A-A

BILL OF MATERIALS

Item	Unit	Super	Sub	Total
Timber Buffers Complete	L. Sum			L. Sum
Structure Excavation	Cu Yds			760
Bituminous Concrete Surf. Cse Class I	Tons	45		45
Concrete Removal	Cu Yds	11	344	355
Expansion Bolts (3/4")	Each	111	511	622
Class X Concrete	Cu Yds	642	6576	7218
P.P.C. Deck Bms (27")	Sq. Ft	1483		1483
P.P.C. Deck Bms (33")	Sq. Ft	494		494
Aluminum Paving	Lin. Ft.	112		112
Reinforcement Bars	Lbs.	8540	71470	80010
Coal Tar Interlayer Protect. Coat	Sq. Yds	448		448
Name Plates	Each		1	1
Preformed Joint Sealer	Lin. Ft.	184		184
Structural Steel	Lbs.	3580		3580
Untreated Piles (Up to 30')	Lin. Ft.		5628	5628
Test Piles (Timber)	Each		4	4
Protective Coat	Sq. Yds	42		42
Crested Piles (Up to 20')	Lin. Ft.		512	512

**Includes 2.9 Cu. Yds. Wing Extension.

STATION 78+51.00
 RE-BUILT 197 BY
 STATE OF ILLINOIS
 S.B.I. RT-88 SEC. 101 BY
 LOADING HS 20

NAME PLATE
 See Std. 213

WATERWAY INFORMATION
 Flow controlled and W.W. opening
 has been determined by navigation
 & recreational requirements.

DESIGNED: *John Lee*
 CHECKED: *Carlson*
 DRAWN: *F. Mercado*
 APPROVED: *John Lee*

EXAMINED: *John Lee*
 PASSED: *John Lee*

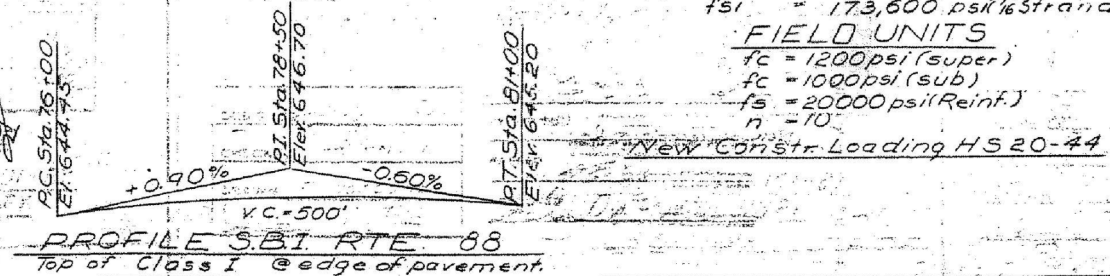

PROFILE S.B.I. RTE 88
 Top of Class I @ edge of pavement.

PRECAST PRESTRESSED UNITS

f'c = 5000 psi
 f'ci = 4000 psi
 f's = 248,000 psi (7/16 strands)
 f'si = 173,600 psi (1/2 strands)
 n = 10

FIELD UNITS

f'c = 1200 psi (super)
 f'c = 1000 psi (sub)
 f's = 200,000 psi (Reinf.)
 n = 10

New Constr. Loading HS 20-44

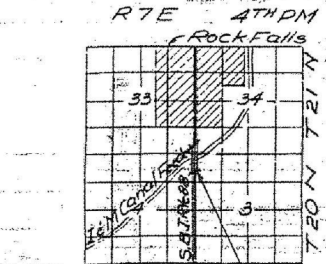

Proposed Struct.
 LOCATION SKETCH

GENERAL PLAN & ELEVATION
 S.B.I. RT-88 OVER IIM CANAL
 S.B.I. RT-88 (EA. 40) SEC. 101 BY
 WHITESIDE COUNTY
 STA. 78+51.00

For Information only

FILE NAME = s:\p1\6380--6395\6346\025\macro\Struct\Structural\Plans\0980015-64C17-033-EPPE.dgn