

Notes:
 See sheet 6 of 11 for Sections C-C & D-D and View B-B.
 $a_{100}(E)$ and $a_{101}(E)$ bar spacings measured along \varnothing Rdwy.
 The joint opening shall be determined per Article 520.04 except that on jointless structures, the distance described as the bridge length between the nearest fixed bearings each way from the joint shall be taken as half the bridge length plus the approach slab length. The minimum dimension shall be $1\frac{1}{2}$ " for installation purposes.

***Cost included with Concrete Superstructure.

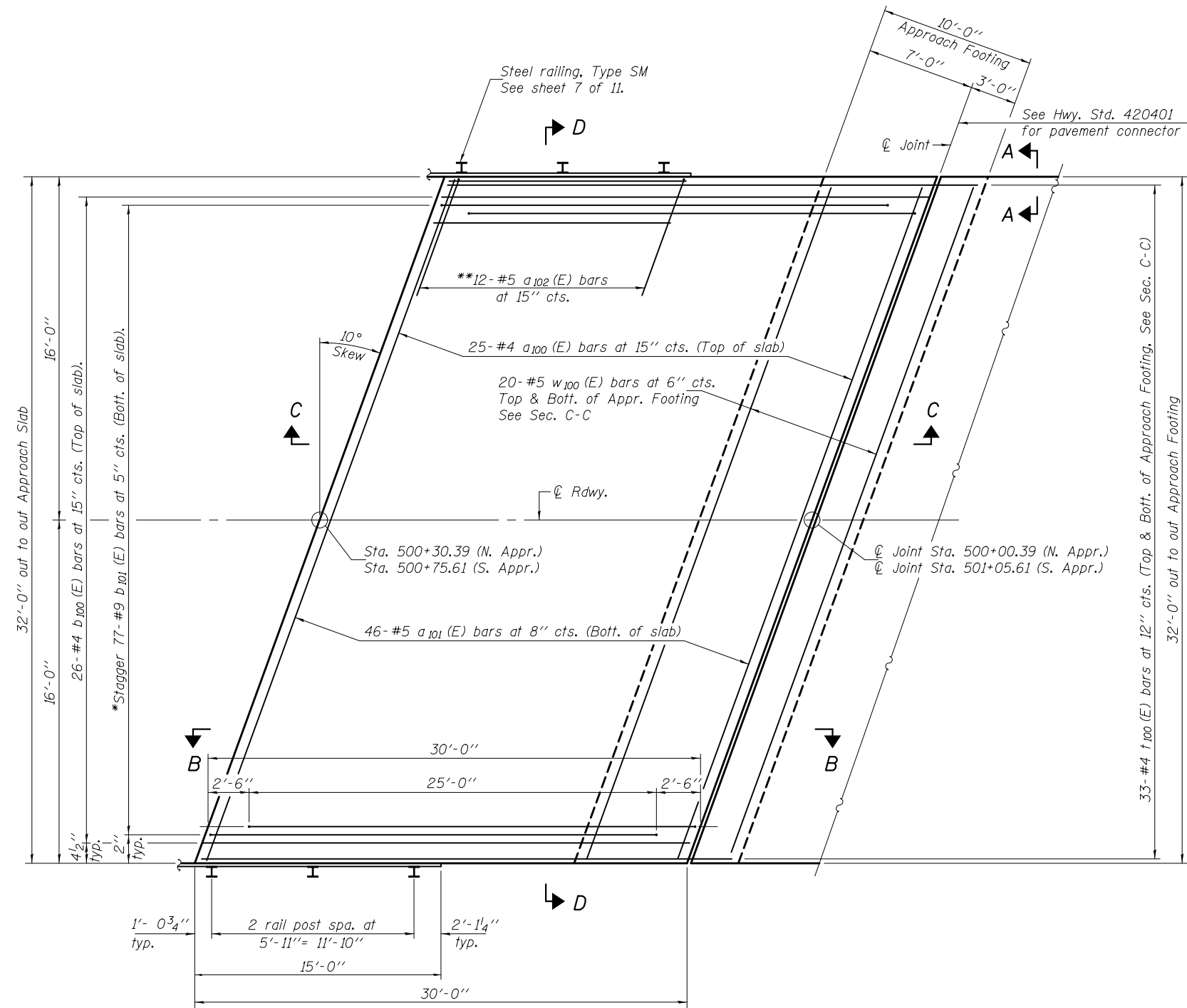

PLAN
 (S. Approach shown - N. Approach similar by 180° rotation)

*Tilt #9 $b_{101}(E)$ bars as required to maintain clearance.
 **Space between $a_{100}(E)$ bars, typ. each end.

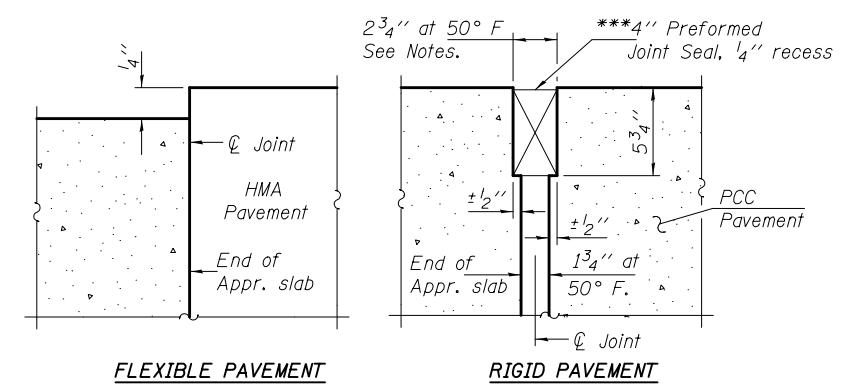

DETAIL A

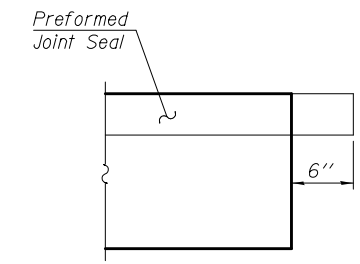

VIEW A-A

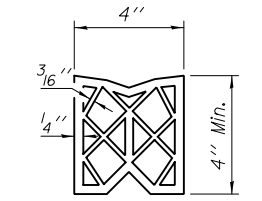

PREFORMED JOINT SEAL

DESIGNED - Fess Teklehaimanot	EXAMINED - <i>Joanne F. [Signature]</i> ACTING ENGINEER OF BRIDGE DESIGN	DATE - SEPTEMBER 3, 2014	STATE OF ILLINOIS DEPARTMENT OF TRANSPORTATION	BRIDGE APPROACH SLAB DETAILS STRUCTURE NO. 038-0184	F.A.S. RTE. - 1324	SECTION - 38BR	COUNTY - IROQUOIS	TOTAL SHEETS - 35	SHEET NO. - 18	
CHECKED - Ray Ahanchi	PASSED - <i>Carl [Signature]</i> ACTING ENGINEER OF BRIDGES AND STRUCTURES	REVISED -			CONTRACT NO. 66A72					
DRAWN - h.t. duong		REVISED -			ILLINOIS FED. AID PROJECT					
CHECKED - FT/GRA					SHEET NO. 5 OF 11 SHEETS					