

PROPOSED PLAN (S.W. RAMP)

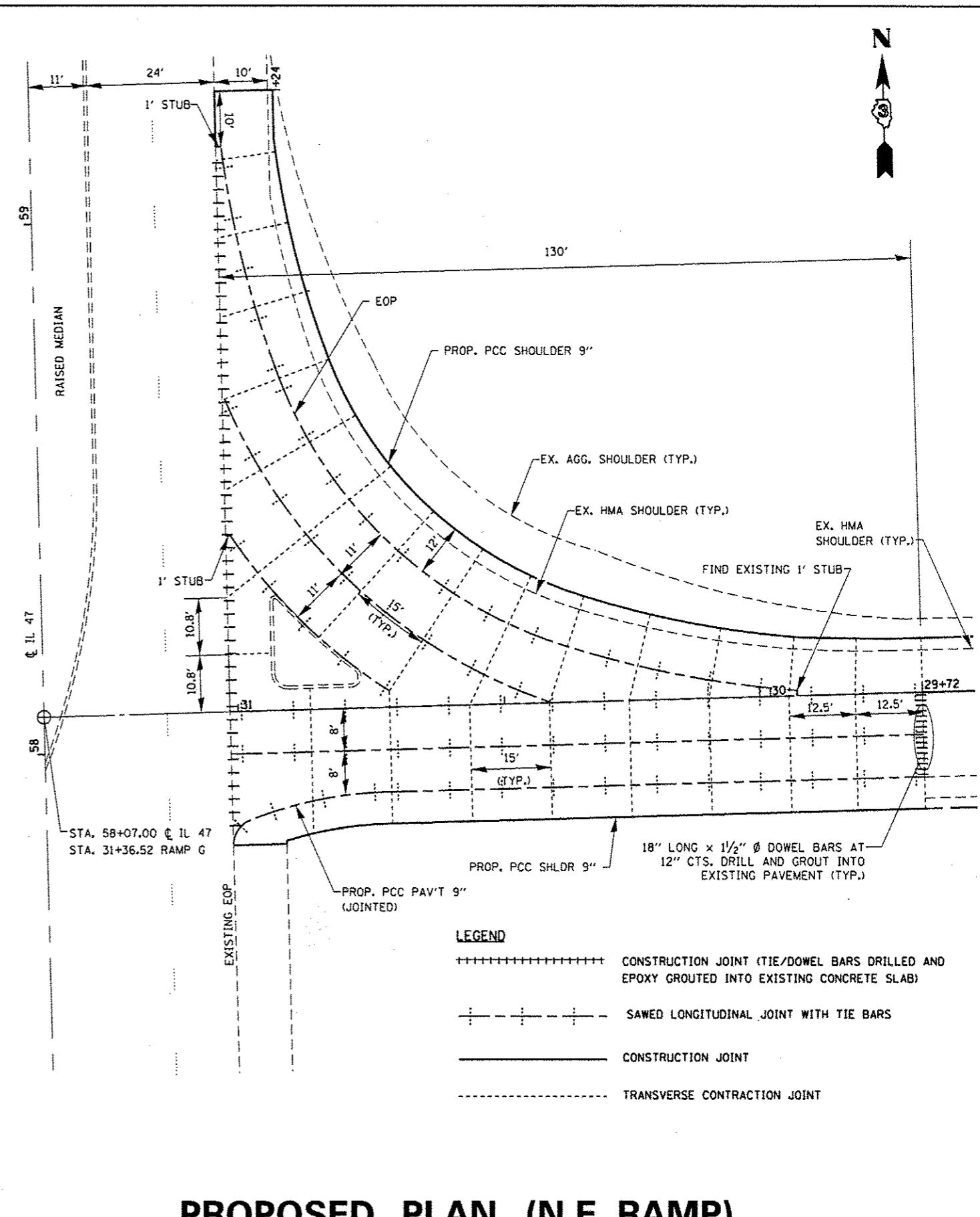

PROPOSED PLAN (N.E. RAMP)

LEGEND

- +++++ CONSTRUCTION JOINT (TIE/DOWEL BARS DRILLED AND EPOXY GROUTED INTO EXISTING CONCRETE SLAB)
- - - - SAWED LONGITUDINAL JOINT WITH TIE BARS
- _____ CONSTRUCTION JOINT
- - - - TRANSVERSE CONTRACTION JOINT

LEGEND

- +++++ CONSTRUCTION JOINT (TIE/DOWEL BARS DRILLED AND EPOXY GROUTED INTO EXISTING CONCRETE SLAB)
- - - - SAWED LONGITUDINAL JOINT WITH TIE BARS
- _____ CONSTRUCTION JOINT
- - - - TRANSVERSE CONTRACTION JOINT

FILE NAME *	USER NAME * ahmedh	DESIGNED - HASAN AHMED	REVISED - 6/5/2014 H.A.
c:\pav\work\pav\ahmedh\0377528\036604-shr-details.dgn		DRAWN - HASAN AHMED	REVISED -
		CHECKED - RON WOODSHANK	REVISED -
#MODELNAME*	PLOT DATE = 6/5/2014	DATE - 4/12/2014	REVISED -

STATE OF ILLINOIS
DEPARTMENT OF TRANSPORTATION

RAMP DETAILS

SCALE: SHEET 1 OF 1 SHEETS STA. TO STA.

F.A.I. RTE.	SECTION	COUNTY	TOTAL SHEETS	SHEET NO.
55	(32-3)BIK	GRUNDY	12	9
CONTRACT NO. 66D64				
ILLINOIS FED. AID PROJECT				