

PROPOSED HIGHWAY PLANS

FAI ROUTE 55 (I-55)
SECTION (32-3HB)K

RAMP PAVEMENT REPLACEMENT
GRUNDY COUNTY

C-93-073-14

F.A.I. RTE.	SECTION	COUNTY	TOTAL SHEETS	SHEET NO.
55	(32-3HB)K	GRUNDY	12	1
ILLINOIS		CONTRACT NO. 66D64		

INDEX OF SHEETS

1. COVER SHEET
2. GENERAL NOTES
- 3-4. SUMMARY OF QUANTITIES
5. TYPICAL SECTIONS
6. SCHEDULES
7. PRE-STAGE SHOULDER WORK
8. STAGING
9. RAMP DETAILS
- 10-11. PAVEMENT MARKING DETAILS
12. TEMPORARY INFORMATION SIGNING DETAILS

HIGHWAY STANDARDS

000001-06	STANDARD SYMBOLS, ABBREVIATIONS AND PATTERNS
001001-02	AREAS OF REINFORCEMENT BARS
001006	DECIMAL OF AN INCH AND OF A FOOT
420001-07	PAVEMENT JOINTS
420701-02	PAVEMENT FABRIC
483001-04	PCC SHOULDER
606301-04	PC CONCRETE ISLANDS AND MEDIANS
701101-04	OFF-ROAD OPERATIONS MULTILANE, 15' (4.5 m) TO 24" (600 mm) FROM PAVEMENT EDGE
701106-02	OFF-ROAD OPERATIONS, MULTILANE, MORE THAN 15' (4.5 m) AWAY
701801-09	URBAN LANE CLOSURE, MULTILANE, 1W OR 2W WITH NONTRAVERSABLE MEDIAN
701456-03	PARTIAL EXIT RAMP CLOSURE FREEWAY/EXPRESSWAY
701901-03	TRAFFIC CONTROL DEVICES
782001	PRISMATIC CURB REFLECTORS

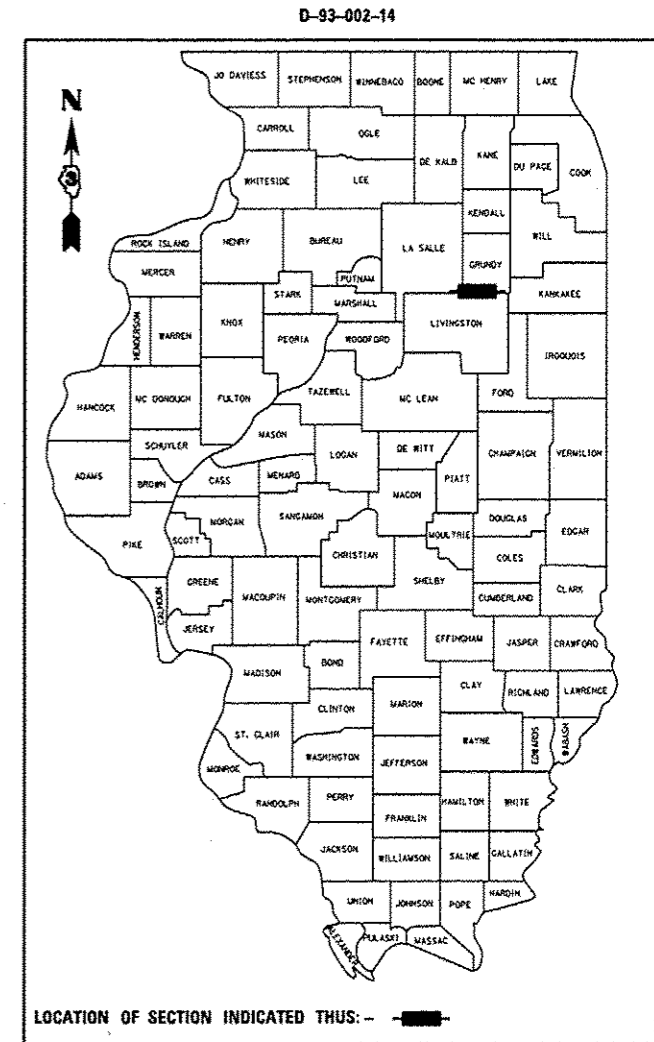

FUNCTIONAL CLASSIFICATION

INTERSTATE/OTHER ARTERIAL		
I-55 (RAMP G) 1950 (2006)	I-55 (RAMP E) 1350 (2006)	IL 47 5000 (2013)
P.V. = 73.1 %	P.V. = 72.2 %	P.V. = 68.5 %
M.U. = 20.5 %	M.U. = 20.4 %	M.U. = 20.5 %
S.U. = 6.4 %	S.U. = 7.4 %	S.U. = 11.0 %

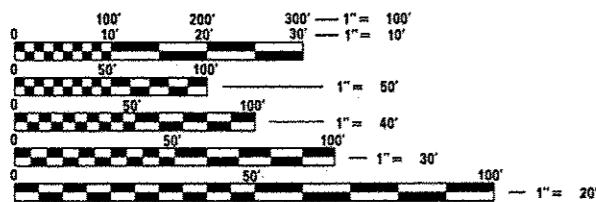

FULL SIZE PLANS HAVE BEEN PREPARED USING STANDARD ENGINEERING SCALES. REDUCED SIZED PLANS WILL NOT CONFORM TO STANDARD SCALES. IN MAKING MEASUREMENTS ON REDUCED PLANS, THE ABOVE SCALES MAY BE USED.

J.U.L.I.E.
JOINT UTILITY LOCATION INFORMATION FOR EXCAVATION
1-800-892-0123
OR 811

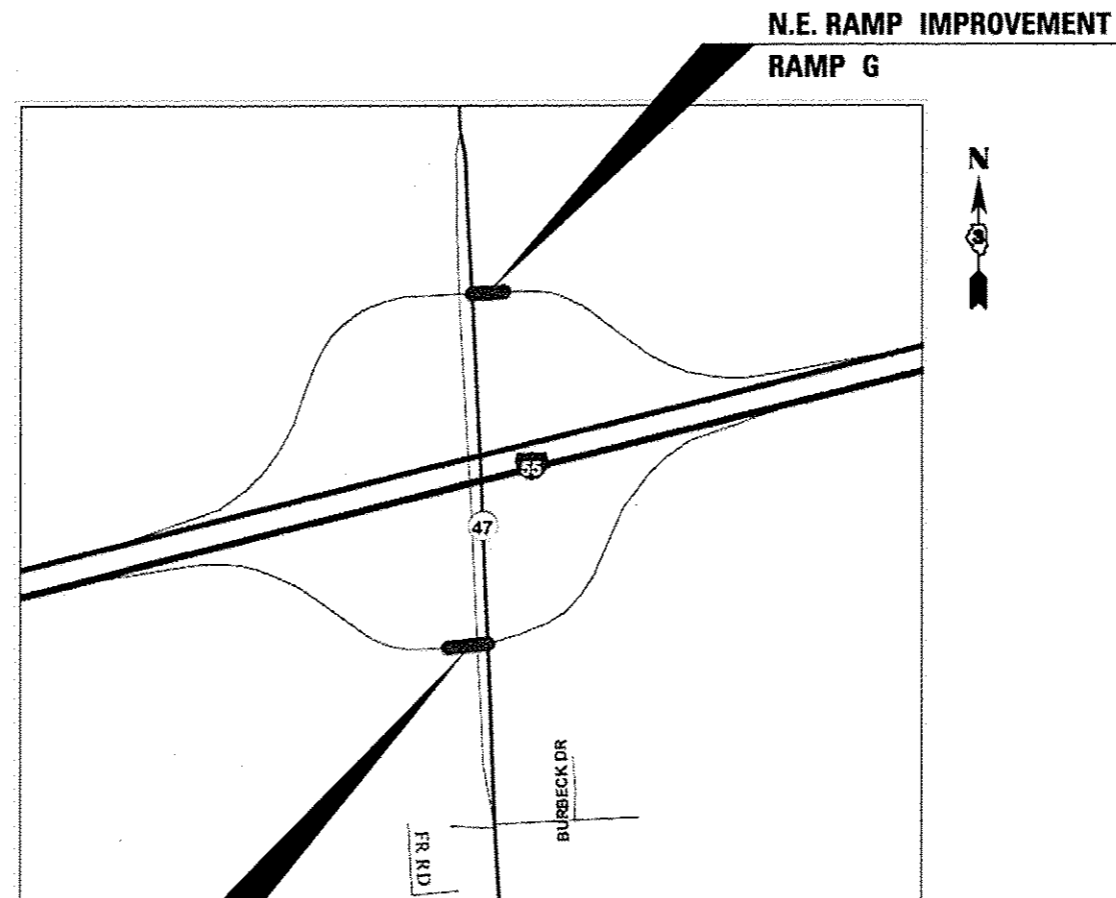

LOCATION MAP
NOT TO SCALE
POINT LOCATION

PROJECT ENGINEER: JOE KANNEL, P.E.
UNIT CHIEF: RON WOODSHANK
TOWNSHIP: GOODFARM
CONTRACT NO. 66D64

STATE OF ILLINOIS
DEPARTMENT OF TRANSPORTATION
DIVISION OF HIGHWAYS

SUBMITTED August 28 2014
Paul Loete, P.E.
DEPUTY DIRECTOR OF HIGHWAYS, REGION ENGINEER

Oct 17 2014
John D. Baranzoli, P.E.
ENGINEER OF DESIGN AND ENVIRONMENT

Oct 17 2014
Omer Osman, P.E.
DIRECTOR OF HIGHWAYS, CHIEF ENGINEER

**PRINTED BY THE AUTHORITY
OF THE STATE OF ILLINOIS**

GENERAL NOTES

THE THICKNESS OF HMA SHOWN ON THE PLANS IS THE NOMINAL THICKNESS. DEVIATIONS FROM THE NOMINAL THICKNESS WILL BE PERMITTED WHEN SUCH DEVIATIONS OCCUR DUE TO IRREGULARITIES IN THE EXISTING SURFACE OR BASE ON WHICH THE HMA IS PLACED.

PLAN DIMENSIONS AND DETAILS RELATIVE TO EXISTING PLANS ARE SUBJECT TO NOMINAL CONSTRUCTION VARIATIONS. THE CONTRACTOR SHALL FIELD VERIFY EXISTING DIMENSIONS AND DETAILS AFFECTING NEW CONSTRUCTION AND MAKE NECESSARY APPROVED ADJUSTMENTS PRIOR TO CONSTRUCTION OR ORDERING OF MATERIALS. SUCH VARIATIONS SHALL NOT BE CAUSE FOR ADDITIONAL COMPENSATION FOR A CHANGE IN SCOPE OF WORK; HOWEVER, THE CONTRACTOR WILL BE PAID FOR THE QUANTITY ACTUALLY FURNISHED AT THE UNIT PRICE BID FOR THE WORK.

THE ENGINEER WILL BE THE SOLE JUDGE CONCERNING CURING TIME FOR THE VARIOUS HMA LIFTS.

ALL EXCAVATED MATERIAL, WHICH INCLUDES DIGGING OR GRADING OF ANY SOIL OR FILL MATERIAL, WITH THE EXCEPTION OF AGGREGATE FILLS, MUST BE INCORPORATED WITHIN THE IDOT RIGHT OF WAY DUE TO ENVIRONMENTAL DOCUMENTATION REQUIREMENTS.

DURING THE CONSTRUCTION PROCESS THE EXCAVATED MATERIAL SHALL BE WINDROWED. WHEN THE CONCRETE SHOULDERS HAVE SUFFICIENTLY CURED THE EXCAVATED MATERIAL SHALL BE GRADED AND SHAPED NEXT TO THE IMPROVED SHOULDERS TO MATCH THE EXISTING EMBANKMENT SLOPE

ABANDONED UNDERGROUND UTILITIES THAT CONFLICT WITH CONSTRUCTION SHALL BE DISPOSED OF OUTSIDE THE LIMITS OF THE RIGHT OF WAY ACCORDING TO ARTICLE 202.03 OF THE STANDARD SPECIFICATIONS AND AS DIRECTED BY THE ENGINEER. THIS WORK WILL NOT BE PAID FOR SEPARATELY, BUT WILL BE INCLUDED IN THE COST OF EARTH EXCAVATION.

ANY REFERENCE TO A STANDARD IN THESE PLANS SHALL BE INTERPRETED TO MEAN THE EDITION AS INDICATED BY THE SUBNUMBER SHOWN IN THE LIST OF STANDARDS OR THE COPY INCLUDED IN THESE PLANS.

THE FOLLOWING RATES OF APPLICATION HAVE BEEN USED IN CALCULATING PLAN QUANTITIES:

GRANULAR MATERIALS	2.05	TONS / CU YD
HMA RESURFACING	112	LBS / SQ YD / IN

THE CONTRACTOR SHALL CONTACT JULIE AT LEAST 48 HOURS PRIOR TO EXCAVATION TO DETERMINE WHICH UTILITIES ARE IN THE AREA.

COMMITMENTS

DATE: August 28, 2014

PREPARED BY: Dr. Basim
DISTRICT STUDIES & PLANS ENGINEER

EXAMINED BY: Heather Jung
DISTRICT CONSTRUCTION ENGINEER

Wayne J. Smith
DISTRICT MATERIALS ENGINEER

James A. Huesker
DISTRICT OPERATIONS ENGINEER

FILE NAME *	USER NAME * ahmedh	DESIGNED - HASAN AHMED	REVISED - 6/5/2014 H.A.	STATE OF ILLINOIS DEPARTMENT OF TRANSPORTATION	GENERAL NOTES	F.A.J. RTE.	SECTION	COUNTY	TOTAL SHEETS	SHEET NO.
ca:\pwwork\pwwork\ahmedh\d9377528\036864-shr-details.dgn	DRAWN - HASAN AHMED	REVISED -	55			(32-3NBK)	GRUNDY	12	2	
PLOT SCALE * 1/8"=1'-0"	CHECKED - RON WOODSHANK	REVISED -	CONTRACT NO. 66D64							
#MODELNAME*	DATE - 4/12/2014	REVISED -	SCALE:			SHEET 1 OF 1 SHEETS	STA. TO STA.	ILLINOIS FED. AID PROJECT		

CODE NO.	ITEM	UNIT	TOTAL QUANTITY	CONSTR. CODE
				STATE FUNDS 100% ROADWAY 0005 RURAL
20200100	EARTH EXCAVATION	CU YD	174	174
31101000	SUBBASE GRANULAR MATERIAL, TYPE B	TON	283	283
42000401	PORTLAND CEMENT CONCRETE PAVEMENT 9" (JOINTED)	SQ YD	998	998
42001200	PAVEMENT FABRIC	SQ YD	2065	2065
44000100	PAVEMENT REMOVAL	SQ YD	998	998
44000500	COMBINATION CURB AND GUTTER REMOVAL	FOOT	116	116
44004250	PAVED SHOULDER REMOVAL	SQ YD	604	604
48300400	PORTLAND CEMENT CONCRETE SHOULDERS 9"	SQ YD	1067	1067
60608700	COMBINATION CONCRETE CURB AND GUTTER, TYPE M-6.06 (ABUTTING EXISTING PAVEMENT)	FOOT	116	116
67100100	MOBILIZATION	L SUM	1	1
70100825	TRAFFIC CONTROL AND PROTECTION, STANDARD 701456	L SUM	1	1
70102630	TRAFFIC CONTROL AND PROTECTION, STANDARD 701601	L SUM	1	1
* 78003100	PREFORMED PLASTIC PAVEMENT MARKING, TYPE B - LETTERS AND SYMBOLS	SQ FT	78	78
* 78009004	MODIFIED URETHANE PAVEMENT MARKING - LINE 4"	FOOT	648	648

* SPECIALTY ITEM

FILE NAME *	USER NAME * ahmedh	DESIGNED - HASAN AHMED	REVISED - 6/5/2014 H.A.	STATE OF ILLINOIS DEPARTMENT OF TRANSPORTATION	SUMMARY	F.A.I. RTE.	SECTION	COUNTY	TOTAL SHEETS	SHEET NO.	
c:\pwwork\p\ahmedh\0377528\03666	64-sht-deta1a.dgn	DRAWN - HASAN AHMED	REVISED -			55	(32-3)HBK	GRUNDY	12	3	
PLOT SCALE = 1/8"=1'-0"	CHECKED - RON WOODSHANK	REVISOR -	REVISOR -			CONTRACT NO. 66D64					
MODELNAME	PLOT DATE = 6/5/2014	DATE - 4/12/2014	REVISOR -			SCALE:	SHEET 1	OF 2	SHEETS	STA.	TO STA.

CODE NO.	ITEM	UNIT	TOTAL QUANTITY	CONSTR. CODE
				STATE FUNDS 100% ROADWAY 0005 RURAL
* 78009008	MODIFIED URETHANE PAVEMENT MARKING - LINE 8"	FOOT	230	230
* 78009012	MODIFIED URETHANE PAVEMENT MARKING - LINE 12"	FOOT	102	102
* 78009024	MODIFIED URETHANE PAVEMENT MARKING - LINE 24"	FOOT	80	80
78200300	PRISMATIC CURB REFLECTOR	EACH	22	22
X4400110	TEMPORARY PAVEMENT REMOVAL	SQ YD	40	40
X4402810	ISLAND SURFACE REMOVAL AND REPLACEMENT	SQ FT	284	284
X7010216	TRAFFIC CONTROL AND PROTECTION, (SPECIAL)	L SUM	1	1
X7830060	GROOVING FOR RECESSED PAVEMENT MARKING, LETTERS AND SYMBOLS	SQ FT	78	78
Z0018911	DRILL AND GROUT #6 TIE BARS	EACH	142	142
Z0018900	DRILL AND GROUT DOWEL BARS	EACH	32	32
Z0024478	FLEXIBLE DELINEATORS	EACH	4	4
Z0030850	TEMPORARY INFORMATION SIGNING	SQ FT	63	63
Z0062456	TEMPORARY PAVEMENT	SQ YD	40	40

* SPECIALTY ITEM

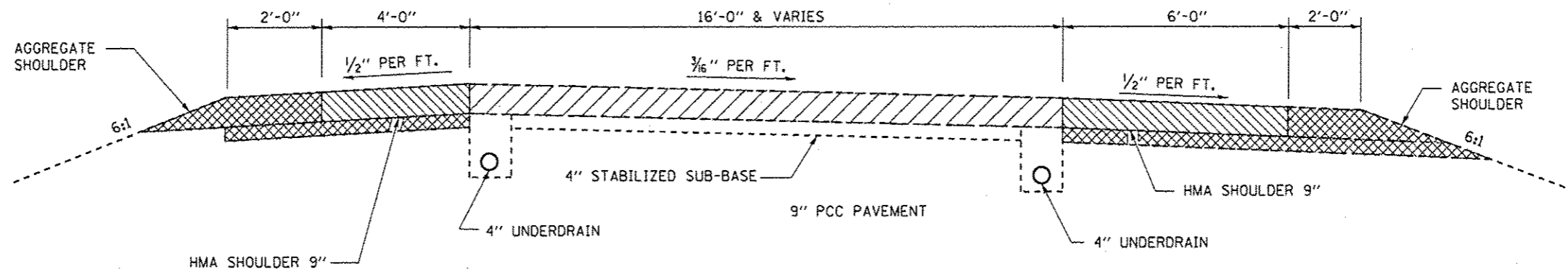

EXISTING TYPICAL SECTION

LEGEND

- 9" PCC PAVEMENT REMOVAL
- 9" HMA SHOULDER REMOVAL
- EARTH EXCAVATION

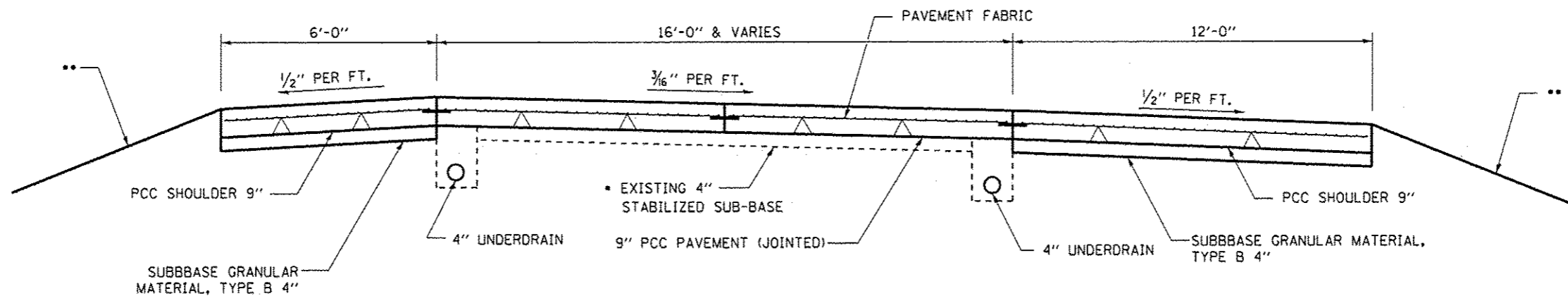

PROPOSED TYPICAL SECTION

- EXISTING STABILIZED SUBBASE IS TO REMAIN UNDISTURBED UNLESS UNSUITABLE FOR NEW PAVEMENT.
- GRADE AND SHAPE WITH EXCAVATED MATERIALS TO MATCH EXISTING SLOPE

FILE NAME *	USER NAME * ahmedh	DESIGNED - HASAN AHMED	REVISED - 6/5/2014 H.A.	STATE OF ILLINOIS DEPARTMENT OF TRANSPORTATION	TYPICAL SECTIONS	F.A.I. RTE.	SECTION	COUNTY	TOTAL SHEETS	SHEET NO.	
of:\pwork\pwork\ahmedh\0377528\036664-sht-details.dgn		DRAWN - HASAN AHMED	REVISED -			55	(32-3HBK)	GRUNDY	12	5	
PLOT SCALE = 1/8" = 1'-0"		CHECKED - RON WOODSHANK	REVISED -			CONTRACT NO. 66064					
MODELNAME#		DATE - 4/12/2014	REVISED -			ILLINOIS FED. AID PROJECT					
					SCALE: 1" = 10'-0"		SHEET 1 OF 1 SHEETS		STA. TO STA.		

REMOVAL SCHEDULE					
LOCATION	ISLAND SURFACE REMOVAL AND REPLACEMENT	EARTH EXCAVATION	COMBINATION CURB AND GUTTER REMOVAL	PAVED SHOULDER REMOVAL	PAVEMENT REMOVAL
	SQ FT	CU YD	FOOT	SQ YD	SQ YD
S.W. RAMP	142	86	58	303	490
N.E. RAMP	142	88	58	309	510
TOTALS	284	174	116	612	1000

MAINLINE SCHEDULE					
LOCATION	PCC PAVEMENT 9" (JOINTED)	PCC SHOULDER 9" (JOINTED)	DRILL & GROUT #6 TIE BARS	DRIL & GROUT DOWEL BARS	COMBINATION CURB AND GUTTER TYPE M-6.06
	SQ YD	SQ YD	EACH	EACH	SQ FT
S.W. RAMP	488	527	70	16	58
N.E. RAMP	510	540	72	16	58
TOTALS	998	1067	142	32	116

PAVEMENT MARKER SCHEDULE		
LOCATION	PRISMATIC CURB REFLECTOR	FLEXIBLE DELINEATOR
	EACH	EACH
S.W. RAMP	11	-
N.E. RAMP	11	-
IL 47 MAINLINE	-	4
TOTALS	22	4

AGGREGATE SCHEDULE	
LOCATION	SUBBASE GRANULAR MATL. 4"
	TON
S.W. RAMP	140
N.E. RAMP	143
TOTALS	283

TEMPORARY ISLAND		
LOCATION	TEMPORARY PAVEMENT	TEMPORARY PAVEMENT REMOVAL
	SQ YD	SQYD
S.W. RAMP	20	20
N.E. RAMP	20	20
TOTALS	40	40

PAVEMENT MARKING SCHEDULE					
LOCATION	24" WHITE	12" WHITE	8" WHITE	4" WHITE	4" YELLOW
	FOOT	FOOT	FOOT	FOOT	FOOT
S.W. RAMP	40	51	115	192	125
N.E. RAMP	40	51	115	199	132
TOTALS	80	102	230	391	257

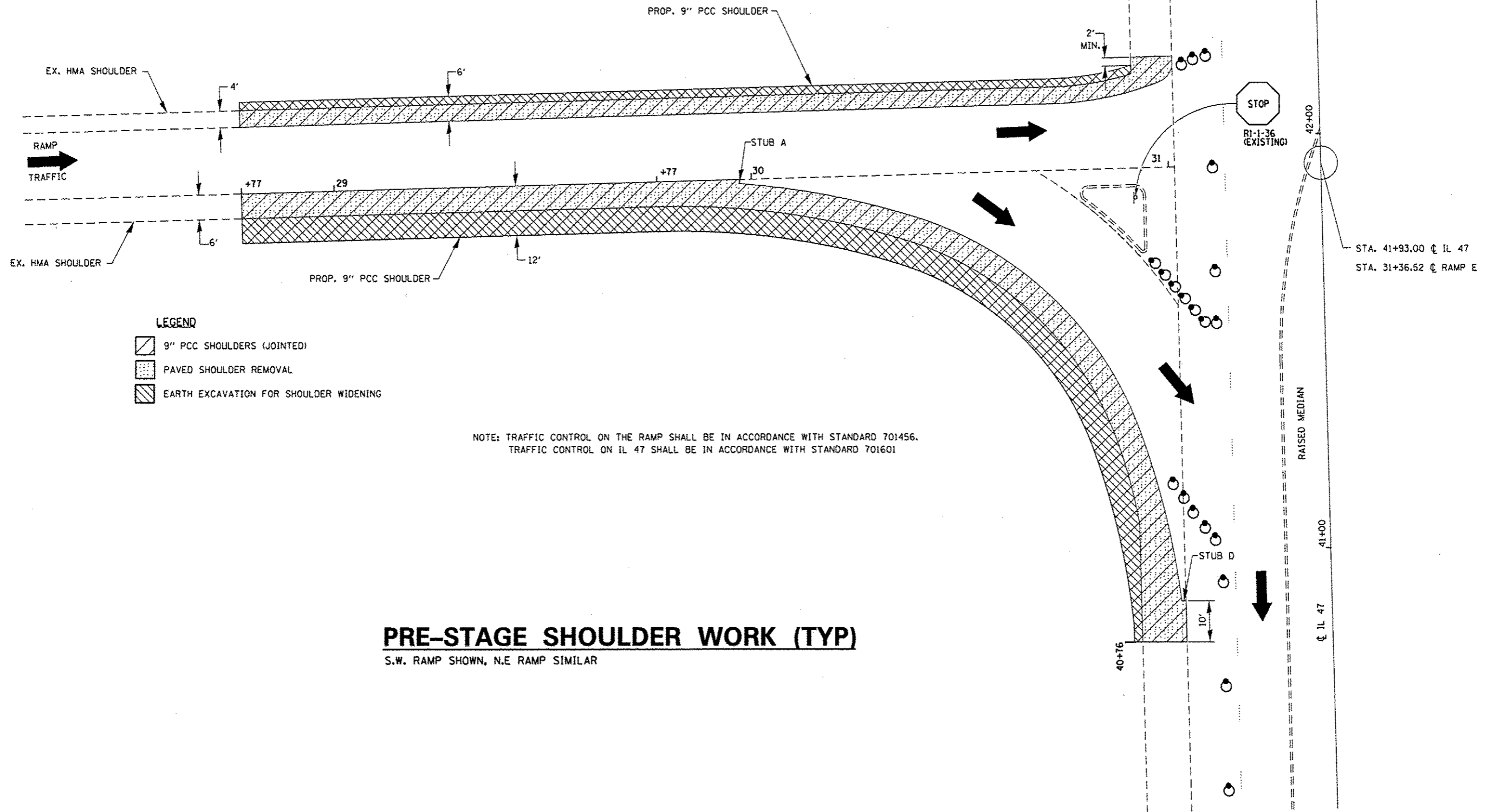

LEGEND

- 9" PCC SHOULDERS (JOINTED)
- PAVED SHOULDER REMOVAL
- EARTH EXCAVATION FOR SHOULDER WIDENING

NOTE: TRAFFIC CONTROL ON THE RAMP SHALL BE IN ACCORDANCE WITH STANDARD 701456.
 TRAFFIC CONTROL ON IL 47 SHALL BE IN ACCORDANCE WITH STANDARD 701601

PRE-STAGE SHOULDER WORK (TYP)



S.W. RAMP SHOWN, N.E. RAMP SIMILAR

FILE NAME *	USER NAME * ahmedh	DESIGNED - HASAN AHMED	REVISED - 4/28/14 H.A.	STATE OF ILLINOIS DEPARTMENT OF TRANSPORTATION	PRE-STAGE SHOULDER WORK	F.A.I. RTE.	SECTION	COUNTY	TOTAL SHEETS	SHEET NO.
c:\pwwork\pwwork\ahmedh\03377528\036664-sht-details.dgn	DRAWN - HASAN AHMED	REVISED -	55			(32-3HB)K	GRUNDY	12	7	
PLOT SCALE * 1/8"=1'-0"	CHECKED - RON WOODSHANK	REVISED -	CONTRACT NO. 66D64							
PLOT DATE * 6/5/2014	DATE - 4/12/2014	REVISED -	ILLINOIS FED. AID PROJECT							
SCALE:		SHEET 1 OF 1 SHEETS		STA. TO STA.						

STAGE 1 (TYP)

S.W. RAMP SHOWN, N.E. RAMP SIMILAR

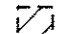
LEGEND

-  ISLAND SURFACE REMOVAL, CC&G REMOVAL, EARTH EX.
-  TEMPORARY PAVEMENT

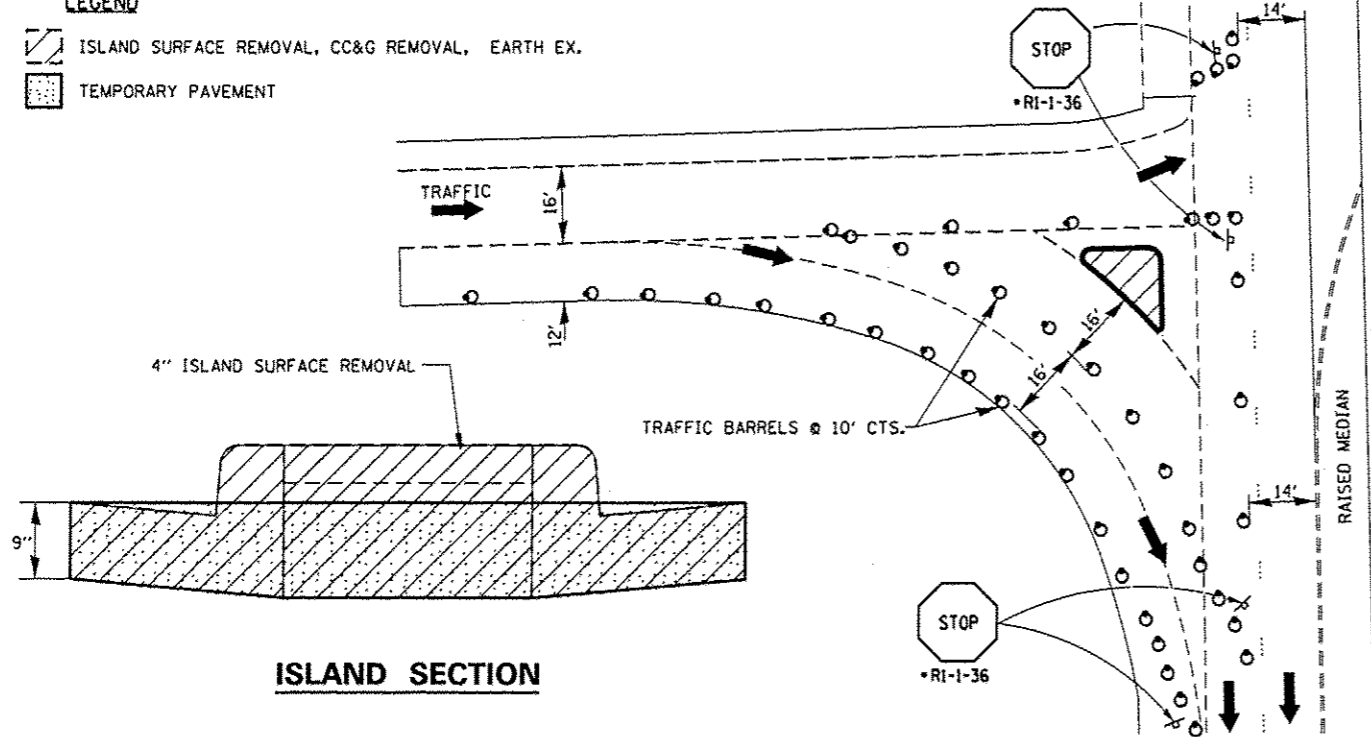

ISLAND SECTION

*NOTE: REMOVE ANY EXISTING SIGNAGE AND REPLACE WITH TEMPORARY SIGNS SHOWN

STAGE 1 PLAN

STAGE 2 (TYP)

S.W. RAMP SHOWN, N.E. RAMP SIMILAR

LEGEND

-  9" PCC PAVEMENT (JOINTED)

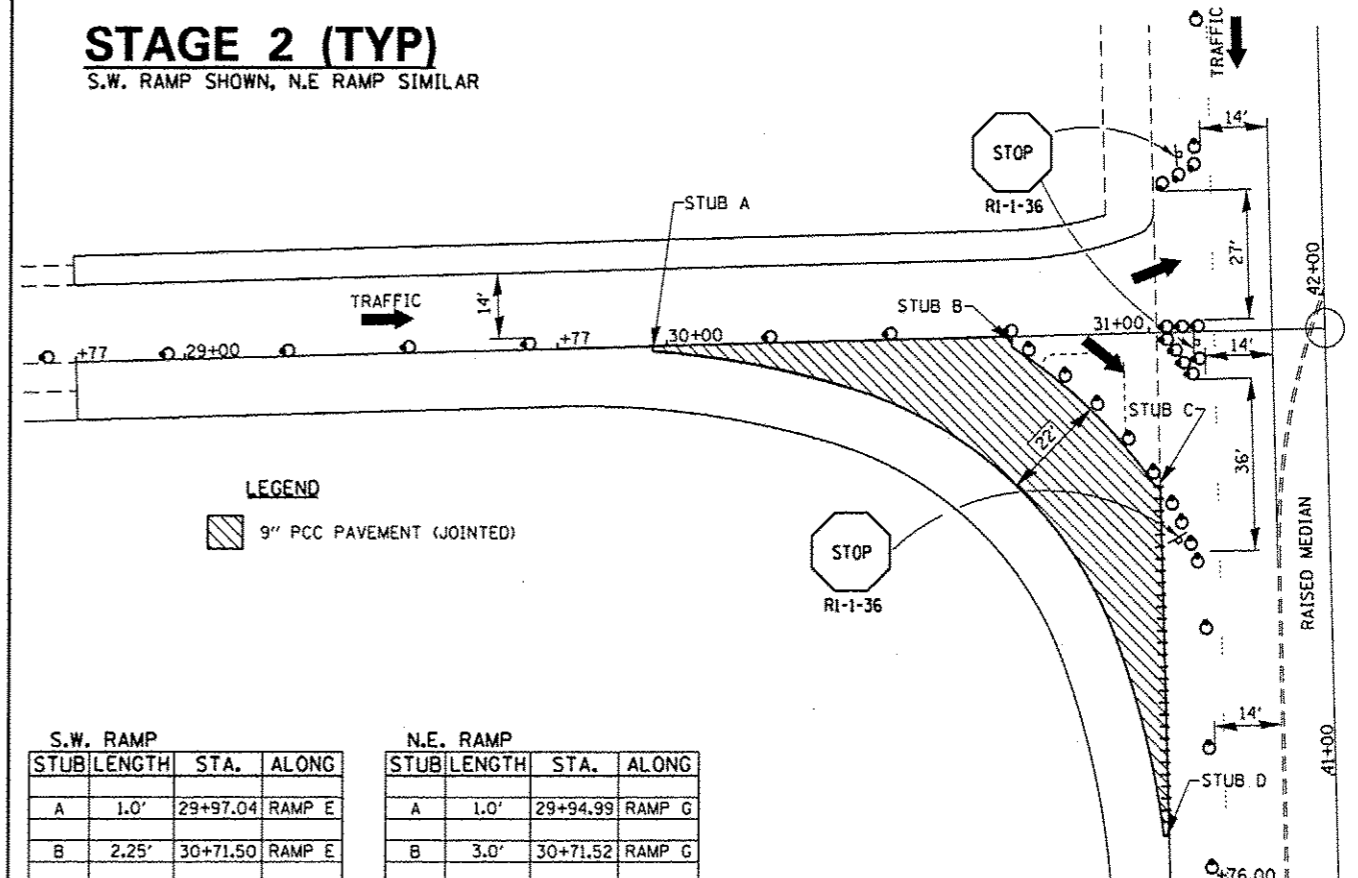

S.W. RAMP				N.E. RAMP			
STUB	LENGTH	STA. ALONG		STUB	LENGTH	STA. ALONG	
A	1.0'	29+97.04	RAMP E	A	1.0'	29+94.99	RAMP G
B	2.25'	30+71.50	RAMP E	B	3.0'	30+71.52	RAMP G
C	1.0'	41+61.12	IL 47	C	1.0'	58+40.14	IL 47
D	1.0'	40+88.12	IL 47	D	1.0'	59+13.52	IL 47

STAGE 2 PLAN

STAGE 3 (TYP)

S.W. RAMP SHOWN, N.E. RAMP SIMILAR

LEGEND

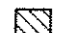
-  9" PCC PAVEMENT (JOINTED)

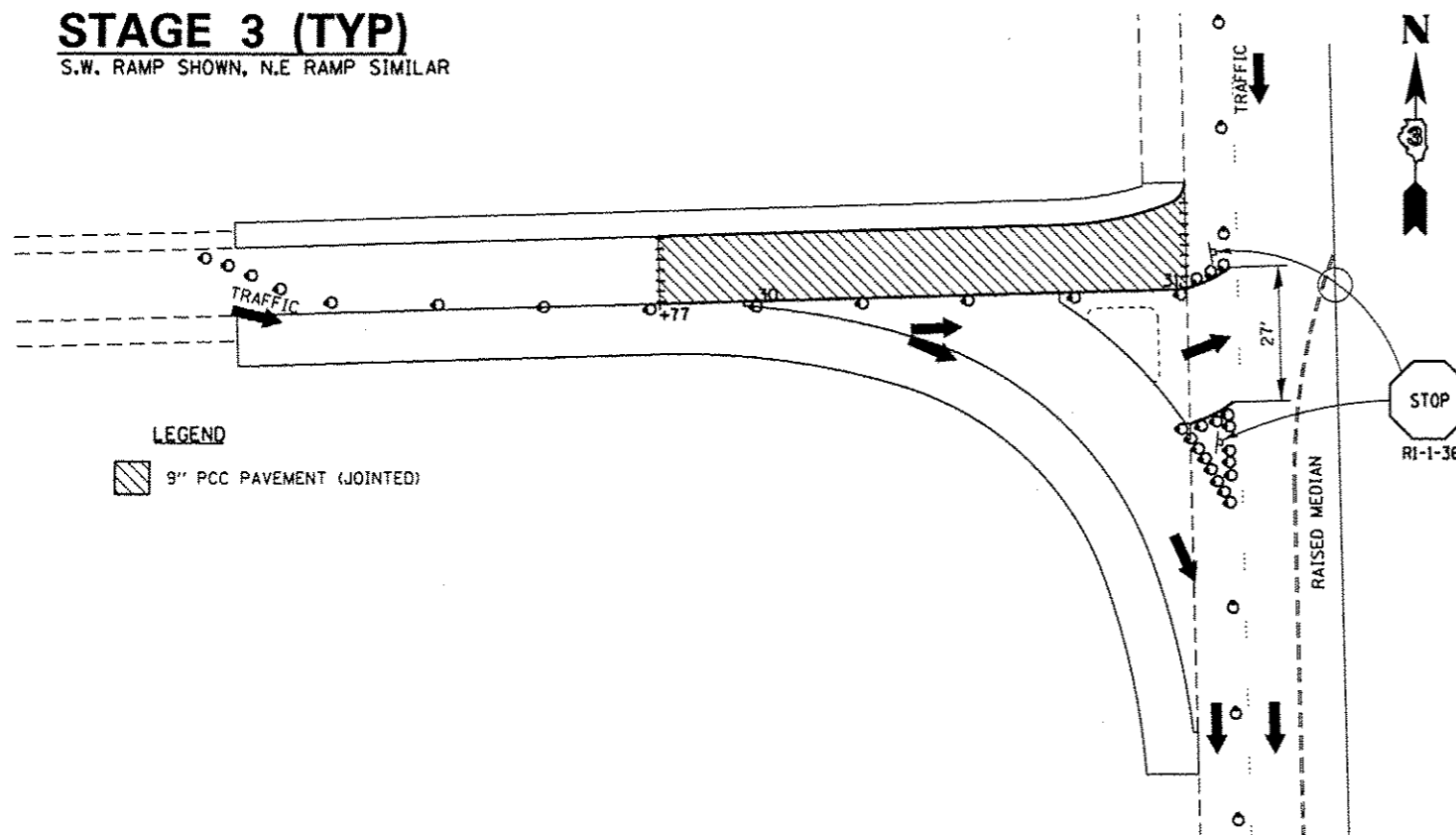

STAGE 4 (TYP)

SEE STAGE 1 FOR TRAFFIC STAGING

LEGEND

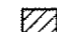
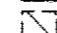
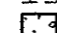
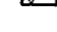
-  9" PCC PAVEMENT REMOVAL AND REPLACEMENT
-  TEMPORARY PAVEMENT REMOVAL
-  ISLAND SURFACE REPLACEMENT & COMBO CURB & GUTTER TYPE M-6.06 (ABUTTING EX. PAV'T)
-  SUBBASE GRANULAR MATERIAL, TYPE B

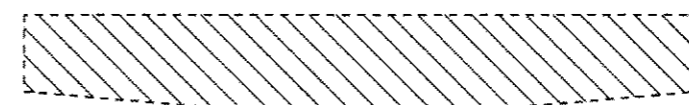

ISLAND SECTION (REMOVAL OF STAGE 1 TEMP. PAV'T)

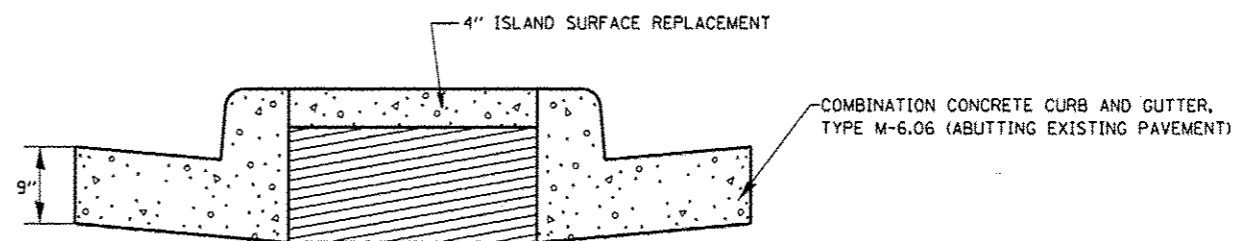

ISLAND SECTION (RECONSTRUCTION)

FILE NAME *	USER NAME * ahmedh	DESIGNED - HASAN AHMED	REVISED - 4/28/14 H.A.
at:\p\work\p\uidat\ahmedh\d0377526\0366064-ahd-details.dgn		DRAWN - HASAN AHMED	REVISED -
		CHECKED - RON WOODSHANK	REVISED -
MODELNAME*	PLOT DATE * 6/3/2014	DATE - 4/12/2014	REVISED -

STATE OF ILLINOIS
DEPARTMENT OF TRANSPORTATION

STAGING

SCALE: SHEET 1 OF 1 SHEETS STA. TO STA.

F.A.I. RTE.	SECTION	COUNTY	TOTAL SHEETS	SHEET NO.
55	(32-38)IK	GRUNDY	12	8
CONTRACT NO. 66D64				
ILLINOIS FED. AID PROJECT				

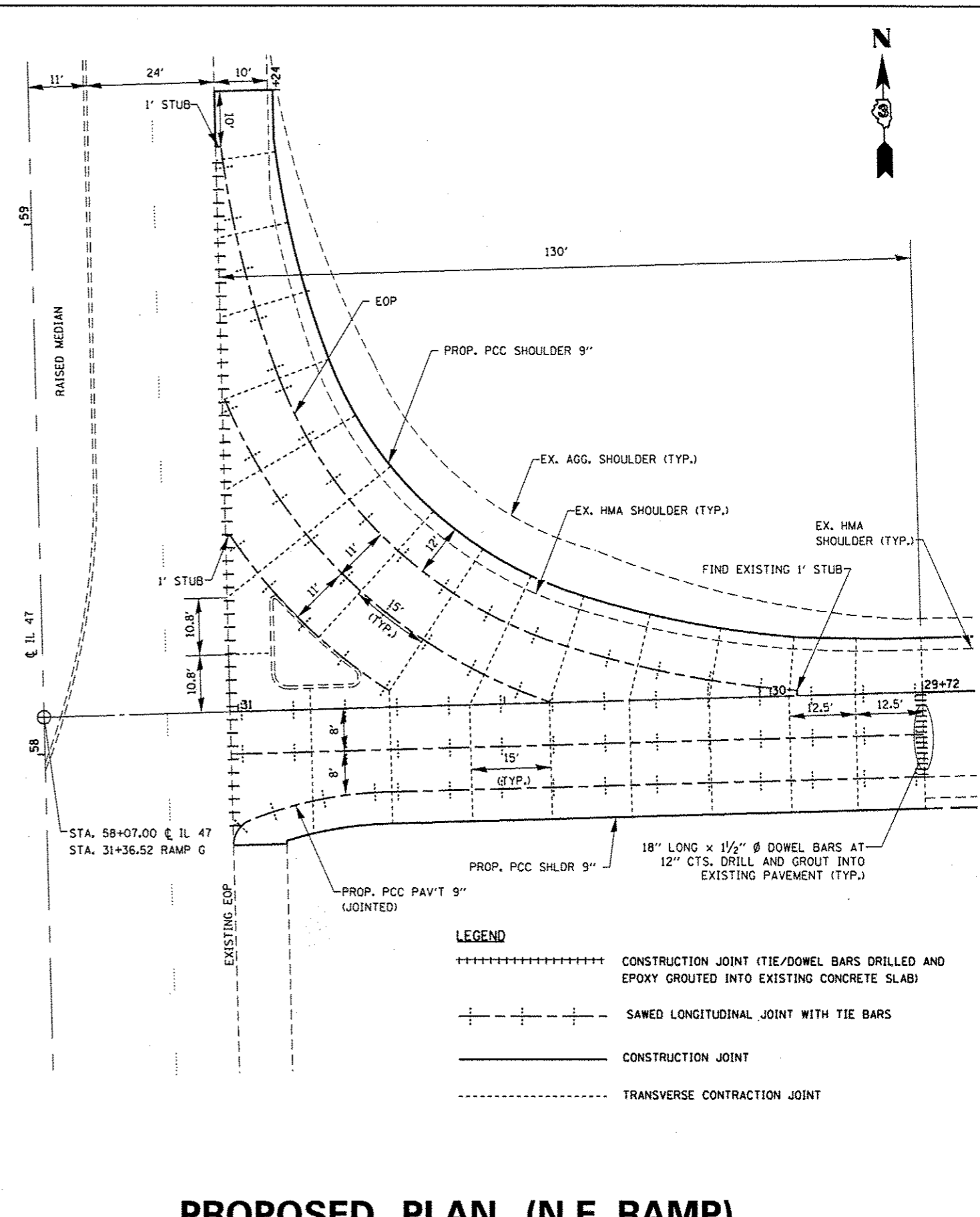
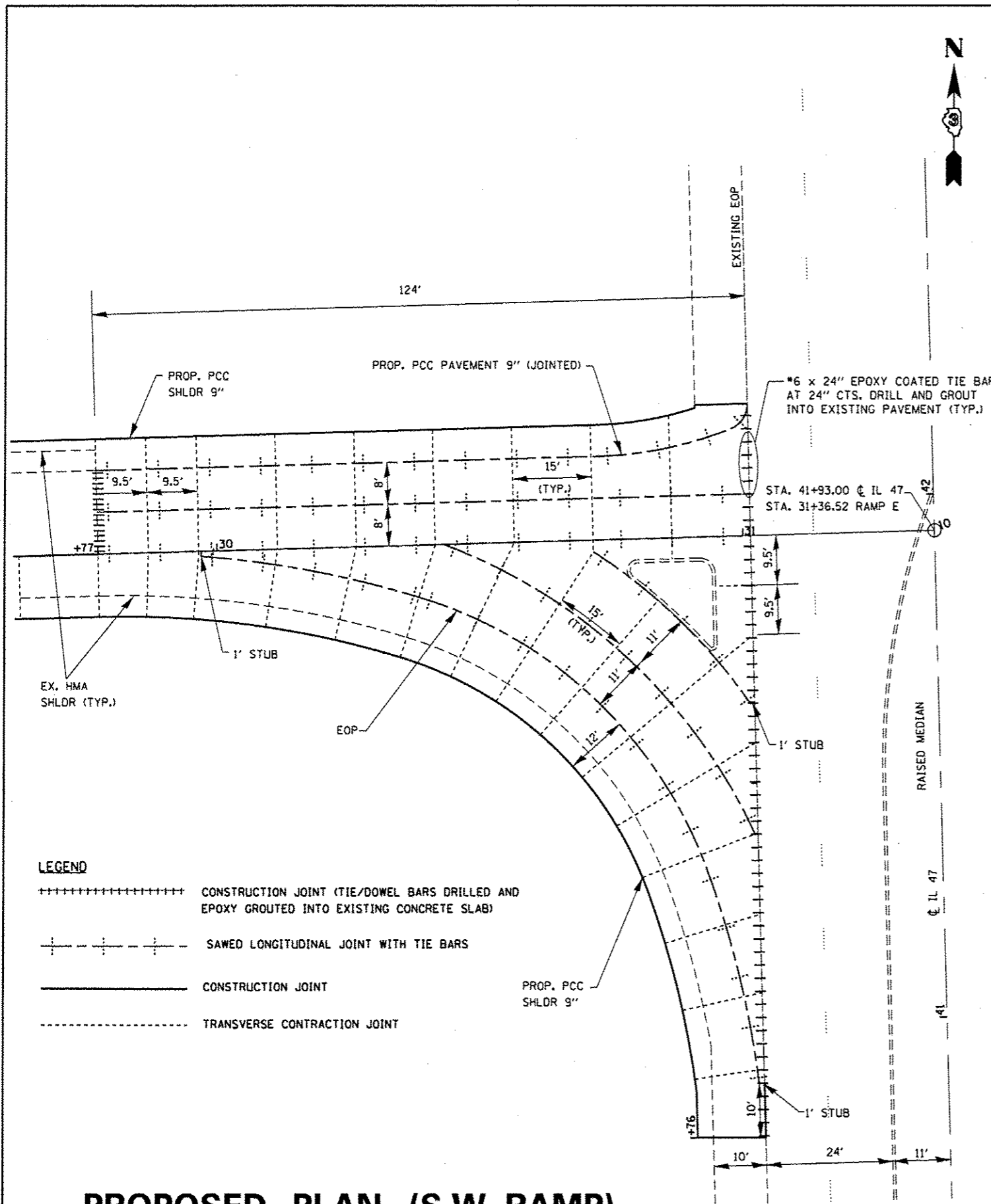

FILE NAME *	USER NAME * ahmedh	DESIGNED - HASAN AHMED	REVISED - 6/5/2014 H.A.
c:\p\work\p\widot\ahmedh\0377528\036604-shr-details.dgn		DRAWN - HASAN AHMED	REVISED -
		CHECKED - RON WOODSHANK	REVISED -
#MODELNAME*	PLOT DATE = 6/5/2014	DATE - 4/12/2014	REVISED -

**STATE OF ILLINOIS
DEPARTMENT OF TRANSPORTATION**

RAMP DETAILS			
SCALE:	SHEET 1	OF 1 SHEETS	STA. TO STA.

F.A.I. RTE.	SECTION	COUNTY	TOTAL SHEETS	SHEET NO.
55	(32-3)BIK	GRUNDY	12	9
CONTRACT NO. 66D64				
ILLINOIS FED. AID PROJECT				

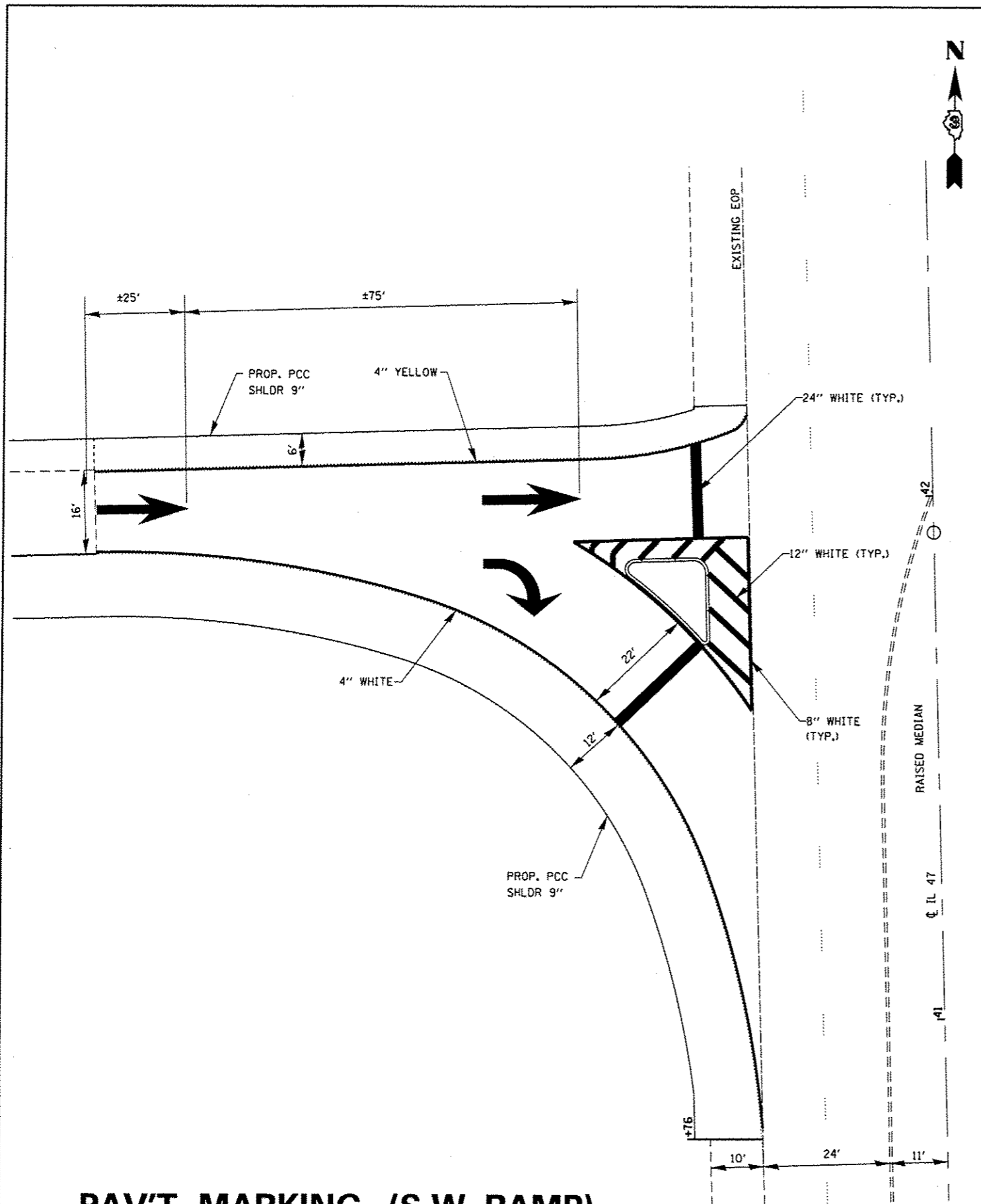

PAV'T MARKING (S.W. RAMP)

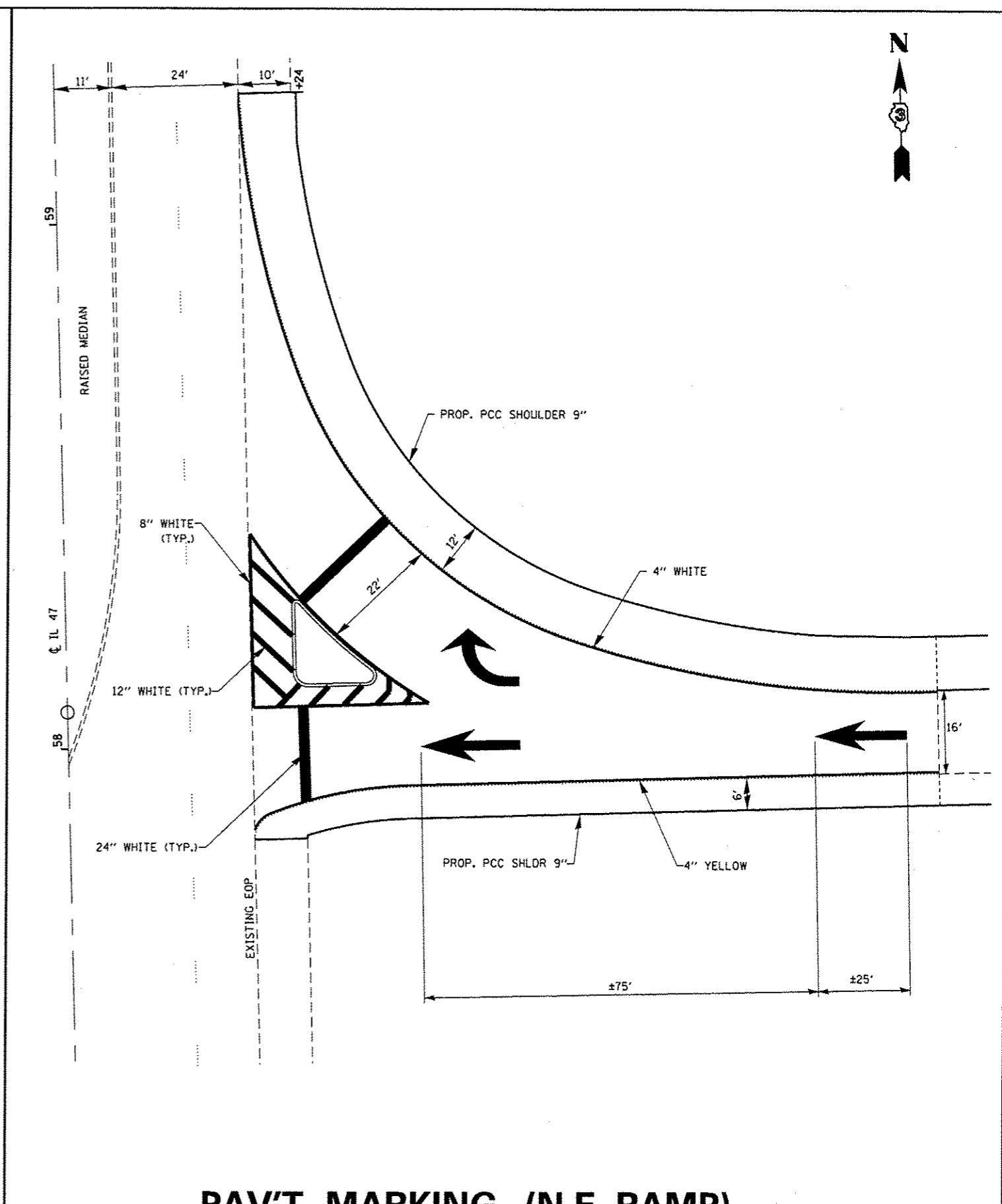

PAV'T MARKING (N.E. RAMP)

FILE NAME *	USER NAME * ahmadh	DESIGNED - HASAN AHMED	REVISED - 6/5/2014 H.A.
o:\p\work\p\idat\ahmadh\8377520\03660	S4-shr-details.dgn	DRAWN - HASAN AHMED	REVISED -
	PLOT SCALE = 100.0000' / 1"	CHECKED - RON WOODSHANK	REVISED -
#MODELNAME#	PLOT DATE = 6/5/2014	DATE - 4/12/2014	REVISED -

**STATE OF ILLINOIS
DEPARTMENT OF TRANSPORTATION**

PAVEMENT MARKING DETAILS

SCALE: SHEET 1 OF 2 SHEETS STA. TO STA.

F.A.I. RTE.	SECTION	COUNTY	TOTAL SHEETS	SHEET NO.
55	(32-3H)K	GRUNDY	12	10
CONTRACT NO. 66D64				
ILLINOIS FED. AID PROJECT				

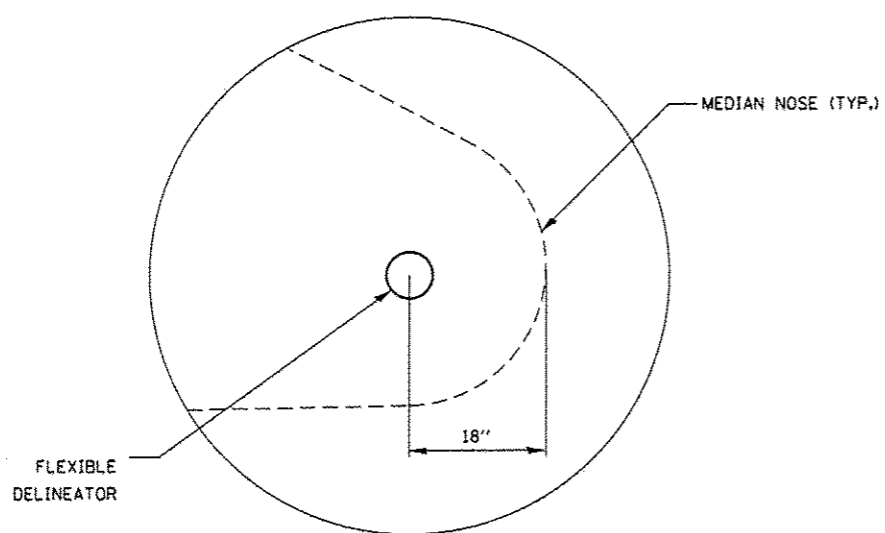
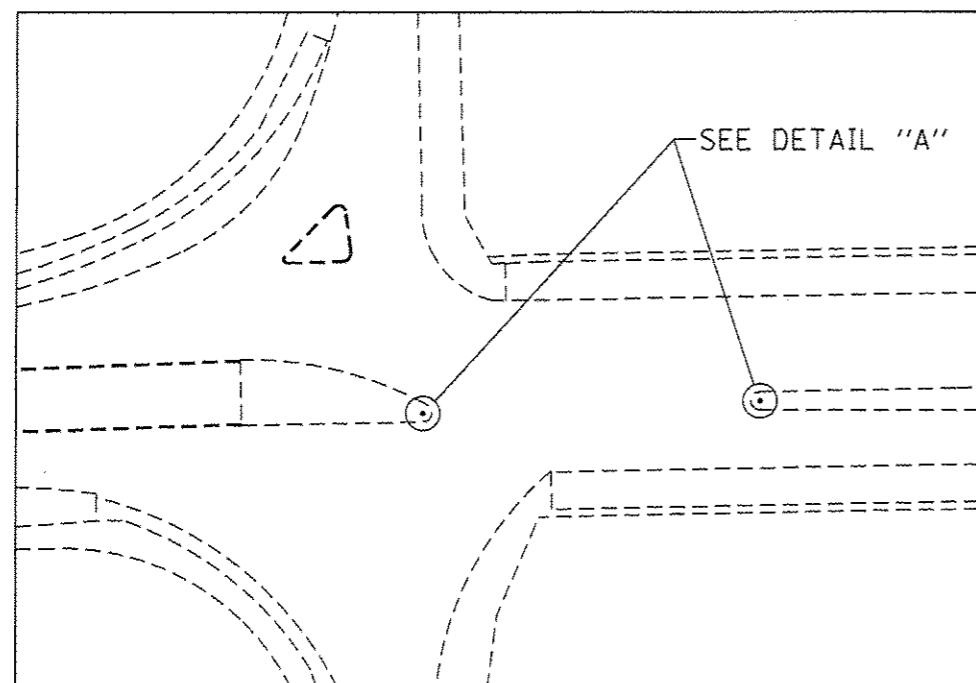

DETAIL "A"

FLEXIBLE DELINEATORS AT MEDIAN NOSES

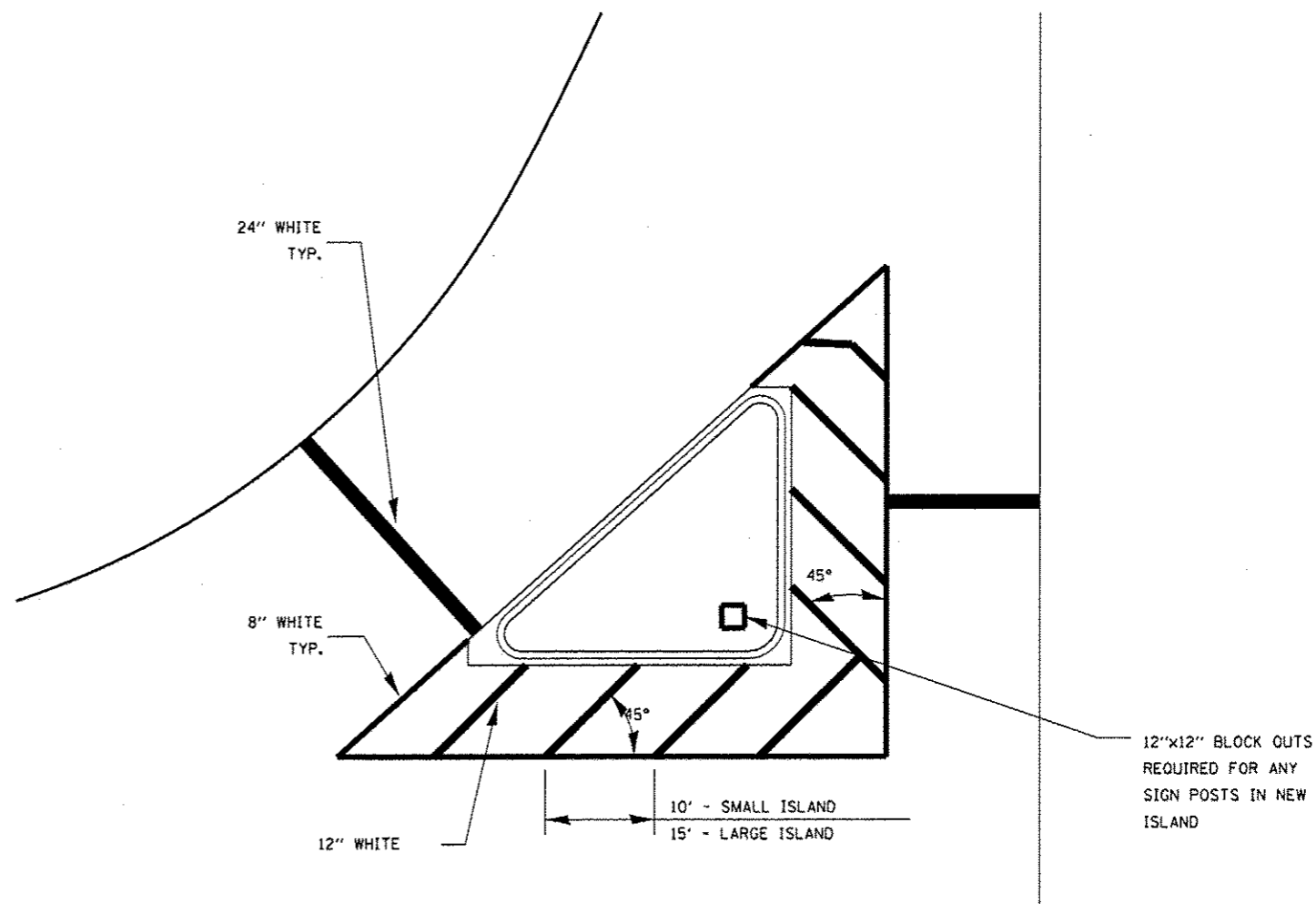

TYPICAL ISLAND

FILE NAME *	USER NAME * ahmedh	DESIGNED - HASAN AHMED	REVISED - 6/5/2014 H.A.
d:\p\work\p\widat\ahmedh\d0377928\036604-sht-details.dgn		DRAWN - HASAN AHMED	REVISED -
		CHECKED - RON WOODSHANK	REVISED -
MODELNAME#	PLOT DATE = 6/5/2014	DATE - 4/12/2014	REVISED -

**STATE OF ILLINOIS
DEPARTMENT OF TRANSPORTATION**

PAVEMENT MARKING DETAILS

SCALE: SHEET 2 OF 2 SHEETS STA. TO STA.

F.A.I. RTE.	SECTION	COUNTY	TOTAL SHEETS	SHEET NO.
55	(32-3HB)K	GRUNDY	12	11
CONTRACT NO. 66D64				
ILLINOIS/FED. AID PROJECT				

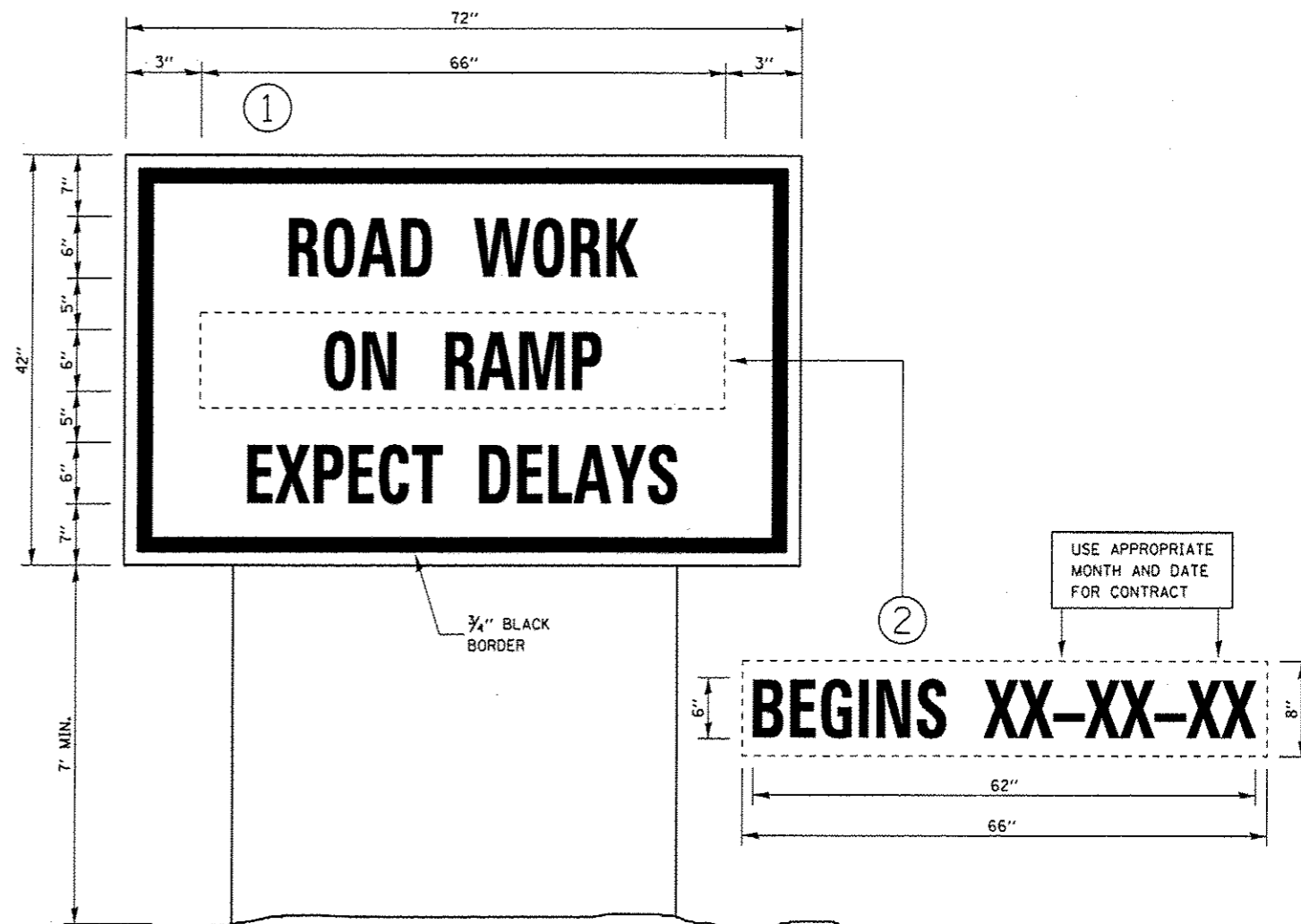
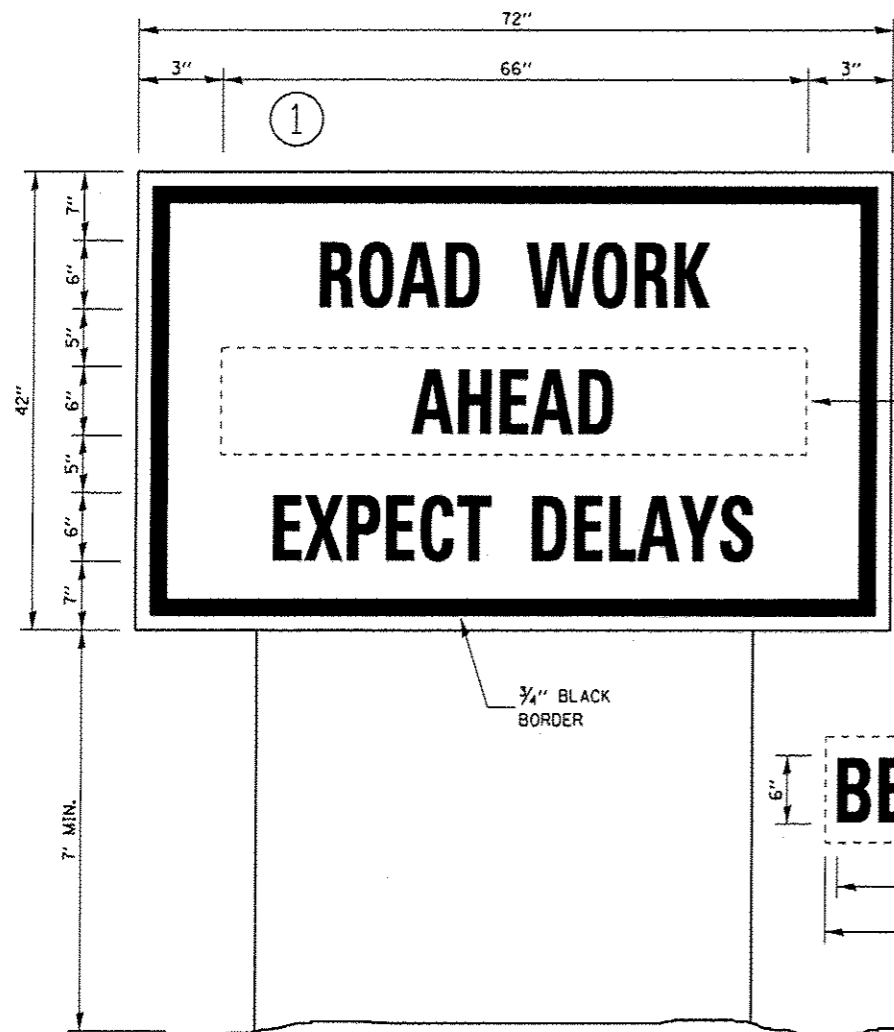

TEMPORARY INFORMATION SIGNING

TEMPORARY INFORMATION SIGNING

NOTES:

1. USE 6" D BLACK LETTERING ON FLOURESENT ORANGE BACKGROUND.
2. ERECT SIGNS AT LOCATIONS IN ADVANCE OF THE "ROAD CONSTRUCTION AHEAD" SIGNS AS DIRECTED BY THE ENGINEER.
3. ERECT SIGN ① WITH INSTALLED PANEL ② A MINIMUM OF ONE WEEK PRIOR TO THE START OF THE LANE CLOSURE.
4. REMOVE PANEL ② ON THAT DATE.
5. SEE SPECIAL PROVISION "TEMPORARY INFORMATION SIGNING" FOR ADDITIONAL INFORMATION.
6. WILL BE PAID FOR PER SO FT AS "TEMPORARY INFORMATION SIGNING". EACH SIGN = 21 SO FT AND THE DATE PANEL ② WILL NOT BE MEASURED SEPARATELY FOR PAYMENT.

NOTES:

1. USE 6" D BLACK LETTERING ON FLOURESENT ORANGE BACKGROUND.
2. ERECT SIGNS AT LOCATIONS IN ADVANCE OF THE "ROAD CONSTRUCTION AHEAD" SIGNS AS DIRECTED BY THE ENGINEER.
3. ERECT SIGN ① WITH INSTALLED PANEL ② A MINIMUM OF ONE WEEK PRIOR TO THE START OF THE DETOUR.
4. REMOVE PANEL ② ON THAT DATE.
5. SEE SPECIAL PROVISION "TEMPORARY INFORMATION SIGNING" FOR ADDITIONAL INFORMATION.
6. WILL BE PAID FOR PER SO FT AS "TEMPORARY INFORMATION SIGNING". EACH SIGN = 21 SO FT AND THE DATE PANEL ② WILL NOT BE MEASURED SEPARATELY FOR PAYMENT.

FILE NAME *	USER NAME * ahmedh	DESIGNED - HASAN AHMED	REVISED - 6/5/2014 H.A.	STATE OF ILLINOIS DEPARTMENT OF TRANSPORTATION	TEMPORARY INFORMATION SIGNING	F.A. RTE.	SECTION	COUNTY	TOTAL SHEETS	SHEET NO.	
ca\pwwork\pwwork\ahmedh\0377526\03665	64-shr-datas.dgn	DRAWN - HASAN AHMED	REVISED -			55	(32-3HB)K	GRUNDY	12	12	
	PLOT SCALE = 1/8" = 1' / 1/4"	CHECKED - RON WOODSHANK	REVISED -			CONTRACT NO. 66D64					
#MODELNAME#	PLOT DATE = 6/5/2014	DATE - 4/12/2014	REVISED -			SCALE:	SHEET 1	OF 1	SHEETS	STA.	TO STA.