

PLAN	SURVEYED	DATE
	PLOTTED	
	CHECKED	
	BY	
	NO.	

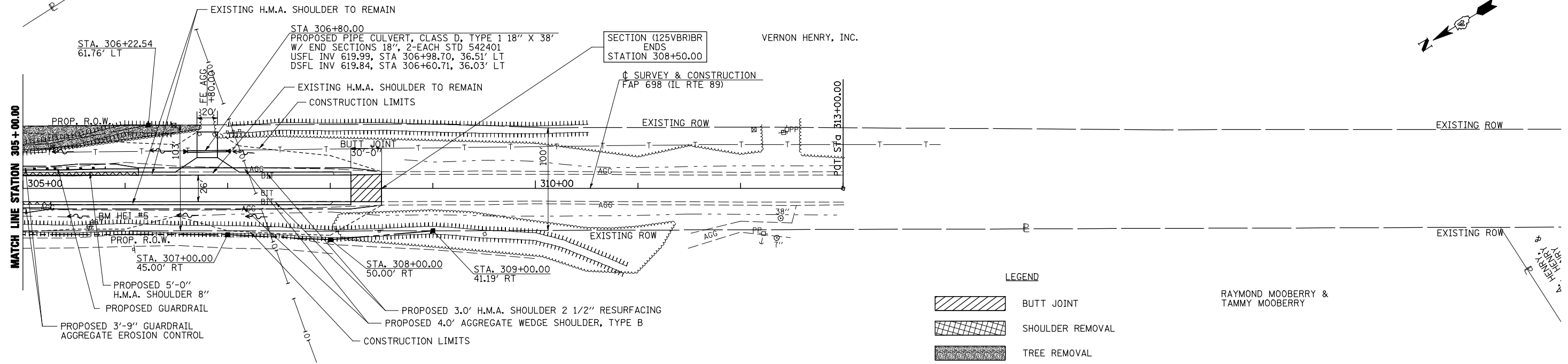

RAYMOND MOOBERRY & TAMMY MOOBERRY

SEC 19, T29N, R1W, 3RD PM

PROFILE	SURVEYED	DATE
	PLOTTED	
	CHECKED	
	BY	
	NO.	

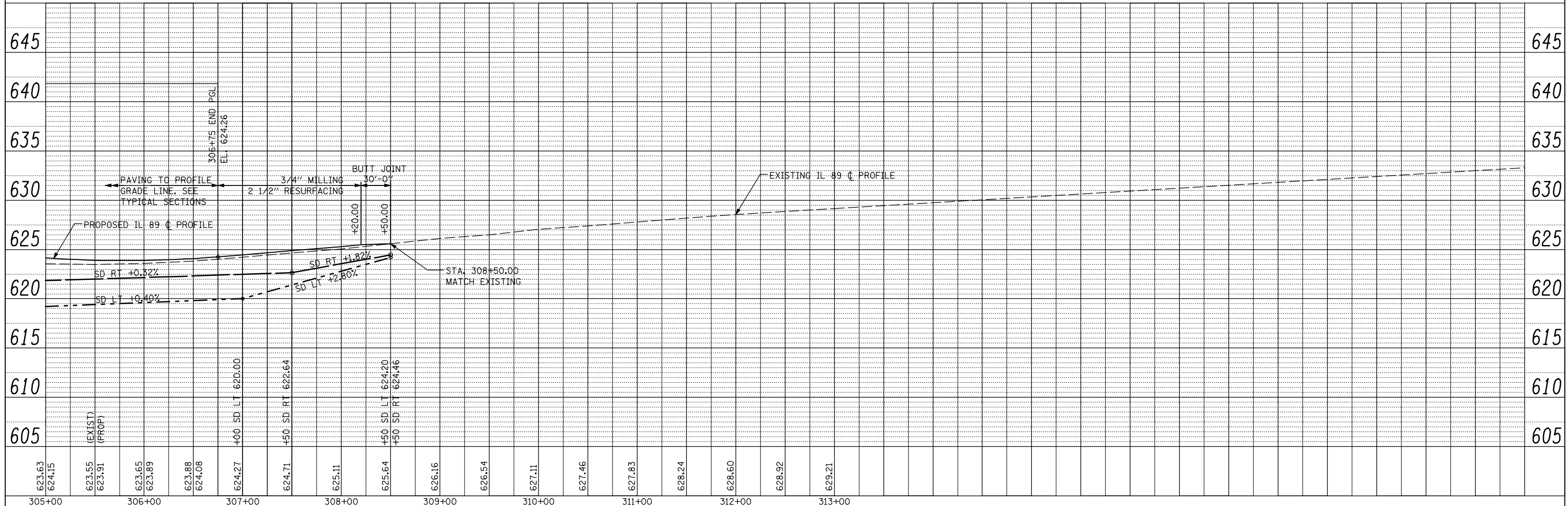

FILE NAME =	USER NAME = jdeen	DESIGNED - MVM	REVISED -
vs:\transportation\3013\cadd_sheets\468580\sh-t-plnr-f03.dgn		DRAWN - TJD	REVISED -
		CHECKED - AWM	REVISED -
		DATE - JULY 24, 2013	REVISED -

STATE OF ILLINOIS
DEPARTMENT OF TRANSPORTATION

FAP 698 (IL RTE 89) PLAN & PROFILE
STA 305+00 TO STA 313+00

SCALE: 1"=50' SHEET NO. 3 OF 3 SHEETS STA. 305+00.00 TO STA. 313+00.00

F.A. RTE.	SECTION	COUNTY	TOTAL SHEETS	SHEET NO.
698	(125VBR)BR	MARSHALL	148	22
FED. ROAD DIST. NO. 7 ILLINOIS FED. AID PROJECT			CONTRACT NO. 68580	