

VERNON HENRY, INC.

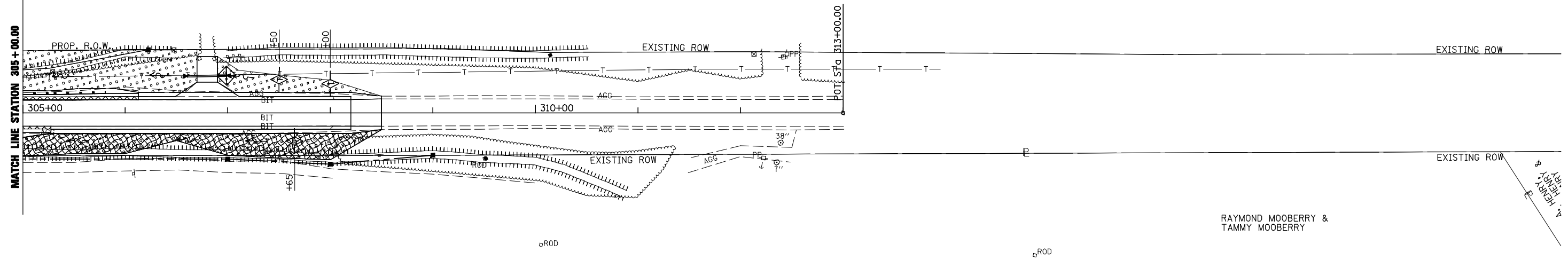

RAYMOND MOOBERRY & TAMMY MOOBERRY

A. HENRY & JOSEPHINE F. HENRY

LEGEND

- PERIMETER EROSION BARRIER
- TEMPORARY DITCH CHECKS
- INLET AND PIPE PROTECTION
- RIPRAP
- HEAVY DUTY EROSION CONTROL BLANKET
- SEEDING:  
0' - 10' FROM EDGE OF SHOULDER = CLASS 2A  
>10' FROM EDGE OF SHOULDER = CLASS 3

RAYMOND MOOBERRY & TAMMY MOOBERRY

SEC 19, T29N, R1W, 3RD PM

PLAN	SURVEYED	DATE
	PLOTTED	
	GRADES CHECKED	
	STRUCTURE NOTED	
	FILE NAME	
	NO.	

PROFILE	SURVEYED	DATE
	PLOTTED	
	GRADES CHECKED	
	STRUCTURE NOTED	
	FILE NAME	
	NO.	

FILE NAME =	USER NAME = jdeen	DESIGNED - MVM	REVISED -
v:\transportation\3013\cadd\sheets\468580\shet-eros02.dgn		DRAWN - TJD	REVISED -
	PLOT SCALE = 100.0000' / IN.	CHECKED - AWM	REVISED -
	PLOT DATE = 7/25/2013	DATE - JULY 24, 2013	REVISED -

STATE OF ILLINOIS  
DEPARTMENT OF TRANSPORTATION

FAP 698 (IL RTE 89) EROSION CONTROL PLAN  
STA 305+00 TO STA 313+00

SCALE: 1"=50' SHEET NO. 2 OF 2 SHEETS STA. 305+00.00 TO STA. 313+00.00

F.A.P. RTE.	SECTION	COUNTY	TOTAL SHEETS	SHEET NO.
698	(125VBR)BR	MARSHALL	148	25
FED. ROAD DIST. NO. 7 ILLINOIS FED. AID PROJECT			CONTRACT NO. 68580	