

**PLAN**

- \* Tilt #9 b<sub>11</sub>(E) bars as required to maintain clearance.
- \*\* Cut bars to fit at parapet.
- \*\*\*\* Closed cell joint filler according to Article 1051.08 of the Standard Specifications. Full depth of slab, full length of parapet. Typ. Each Parapet.

Notes:  
 See sheet 21 of 62 for Sections C-C & D-D and View E-E, d(E) and a<sub>1</sub>(E) bar spacings measured along  $\phi$  Rdwy.  
 The joint opening shall be determined per Article 520.04 of the Standard Specifications. The minimum dimension shall be 1 1/2" for installation purposes.

\*\*\* Cost included with Concrete Superstructure.

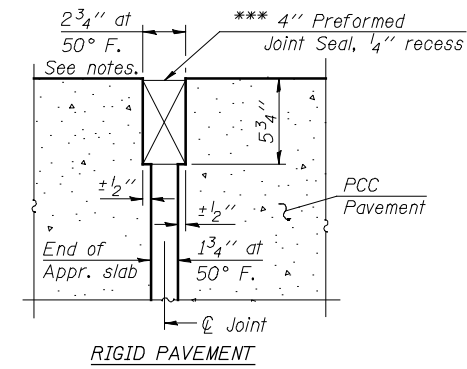

**DETAIL A**

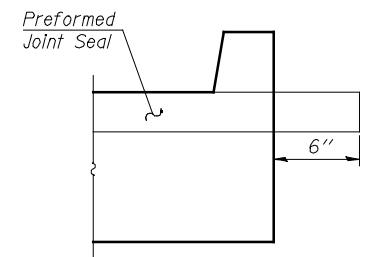
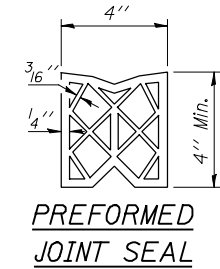

**VIEW F-F**

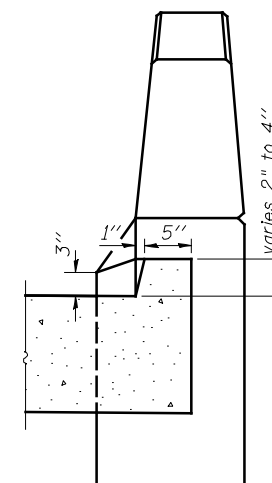

**VIEW B-B**