

ORIGINAL SURVEY	SURVEYED	BY	DATE
NOTE BOOK	PLOTTED		
	TEMPLATE		
	AREAS		
	CHECKED		

FINAL SURVEY	SURVEYED	BY	DATE
NOTE BOOK	PLOTTED		
	TEMPLATE		
	AREAS		
	CHECKED		

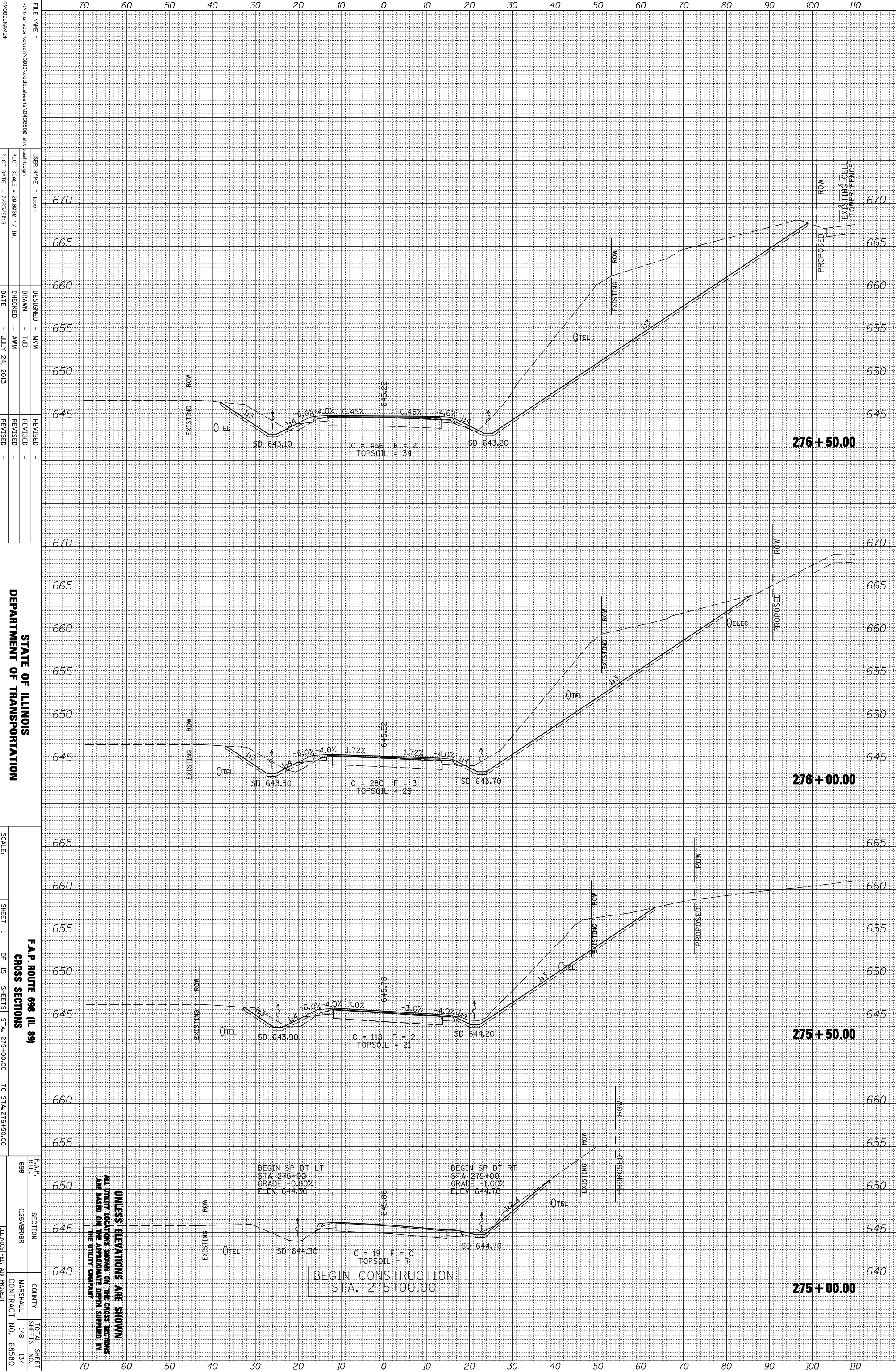

UNLESS ELEVATIONS ARE SHOWN
ALL UTILITY LOCATIONS SHOWN ON THE CROSS SECTIONS
ARE BASED ON THE APPROXIMATE DEPTH SUPPLIED BY
THE UTILITY COMPANY.

BEGIN CONSTRUCTION
STA. 275+00.00

FILE NAME = V:\transportation\2013\cadd\sheet\0468580-ah\sheet.dgn
DESIGNED - MMW
DRAWN - TJD
CHECKED - AMW
DATE - JULY 24, 2013
REVISIONS -
REVISION 1
REVISION 2
REVISION 3

STATE OF ILLINOIS
DEPARTMENT OF TRANSPORTATION
F.A.P. ROUTE 698 (IL 89)
CROSS SECTIONS
SHEET 1 OF 15 SHEETS STA. 275+00.00 TO STA. 276+50.00

F.A.P. ROUTE 698
SECTION 125VBRBR
COUNTY MARSHALL
CONTRACT NO. 68580
TOTAL SHEET NO. 134