

ORIGINAL SURVEY	SURVEYED	BY	DATE
NOTE BOOK	PLOTTED		
	TEMPLATE		
	AREAS		
	CHECKED		

FINAL SURVEY	SURVEYED	BY	DATE
NOTE BOOK	PLOTTED		
	TEMPLATE		
	AREAS		
	CHECKED		

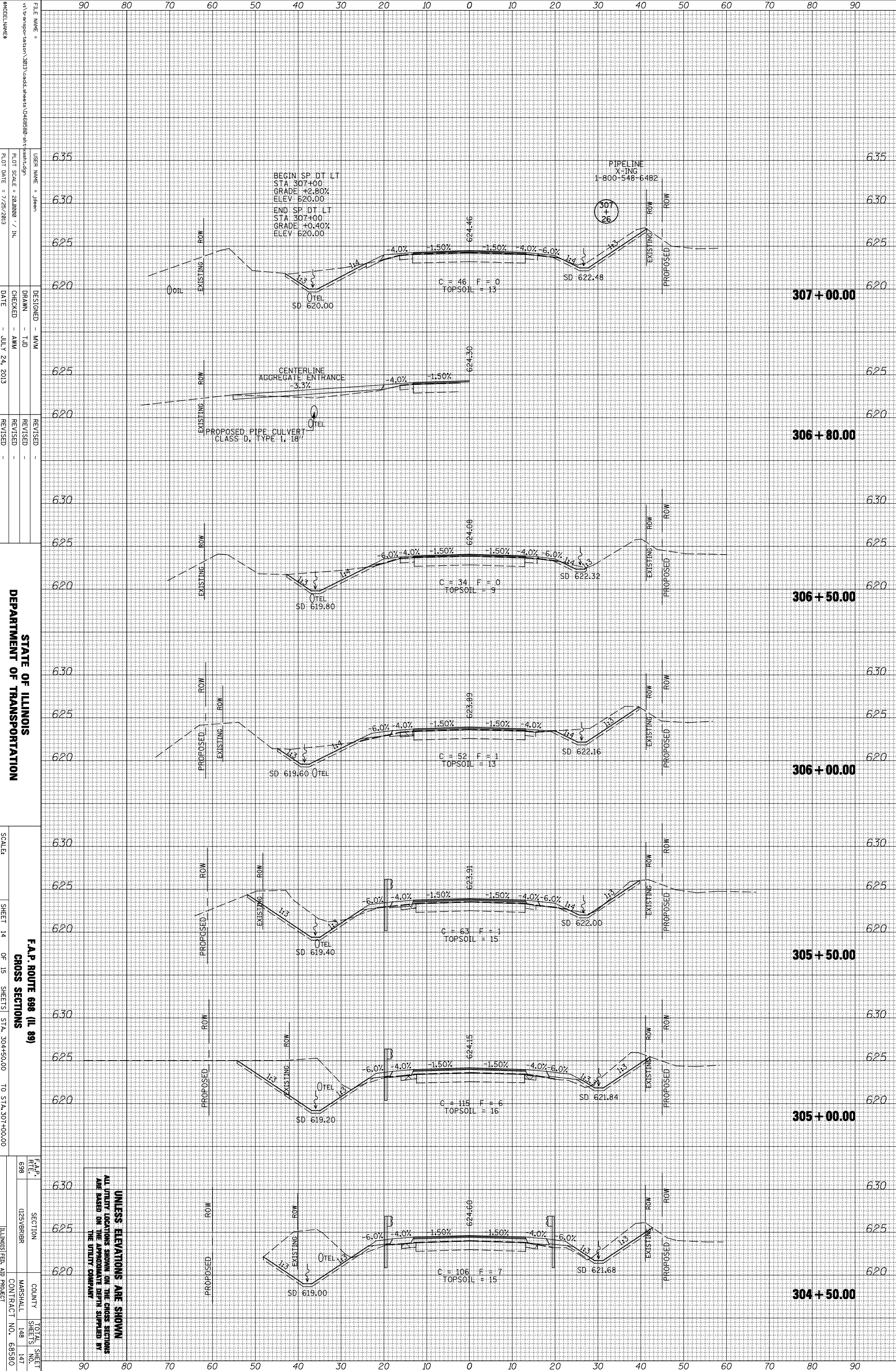

FILE NAME =
 USER NAME = Jdean
 DESIGNER = MMW
 DRAWN = TJD
 CHECKED = AMW
 DATE = JULY 24, 2013

STATE OF ILLINOIS
 DEPARTMENT OF TRANSPORTATION

SCALE:
 SHEET 14 OF 15 SHEETS STA. 304+50.00 TO STA. 307+00.00

F.A.P. ROUTE 698 (IL 89)
 CROSS SECTIONS
 SECTION 125VBRBR
 COUNTY MARSHALL
 CONTRACT NO. 68580

UNLESS ELEVATIONS ARE SHOWN
 ALL UTILITY LOCATIONS SHOWN ON THE CROSS SECTIONS
 ARE BASED ON THE APPROXIMATE DEPTH SUPPLIED BY
 THE UTILITY COMPANY

F.A.P. RTE.	SECTION	COUNTY	TOTAL SHEET NO.
698	125VBRBR	MARSHALL	148 147
		CONTRACT NO.	68580