

EXIST. CURVE CURV193
 PI STA. = 9+22.93
 Δ = 19° 18' 44" (RT)
 D = 2° 14' 42"
 R = 2,552.11'
 T = 434.23'
 L = 860.22'
 E = 36.68'

T.R. =
 S.E. RUN =
 P.C. STA. = 4+88.70
 P.T. STA. = 13+48.93

EXIST. CURVE CURV185
 PI STA. = 9+09.00
 Δ = 12° 32' 30" (RT)
 D = 4° 15' 52"
 R = 1,343.58'
 T = 147.64'
 L = 294.10'
 E = 8.09'

T.R. =
 S.E. RUN =
 P.C. STA. = 7+61.36
 P.T. STA. = 10+55.46

EXIST. CURVE CURV68
 PI STA. = 350+38.00
 Δ = 32° 24' 08" (LT)
 D = 2° 00' 32"
 R = 2,852.12'
 T = 828.67'
 L = 1,612.94'
 E = 117.95'

T.R. =
 S.E. RUN =
 P.C. STA. = 342+09.32
 P.T. STA. = 358+22.26

S.N. 057-0206
 STA. 343+46
 BRIDGE

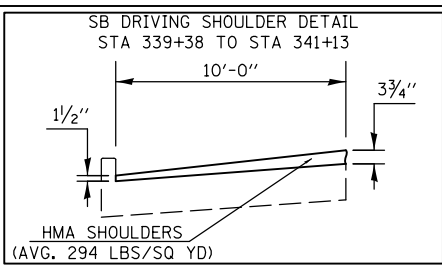
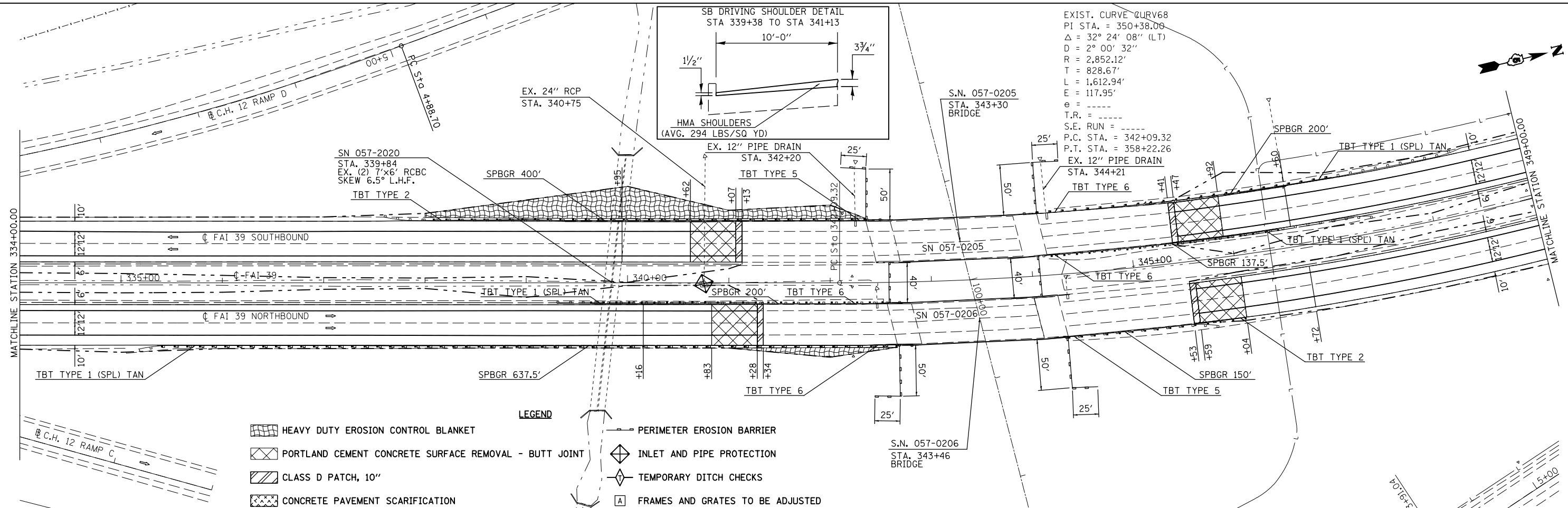
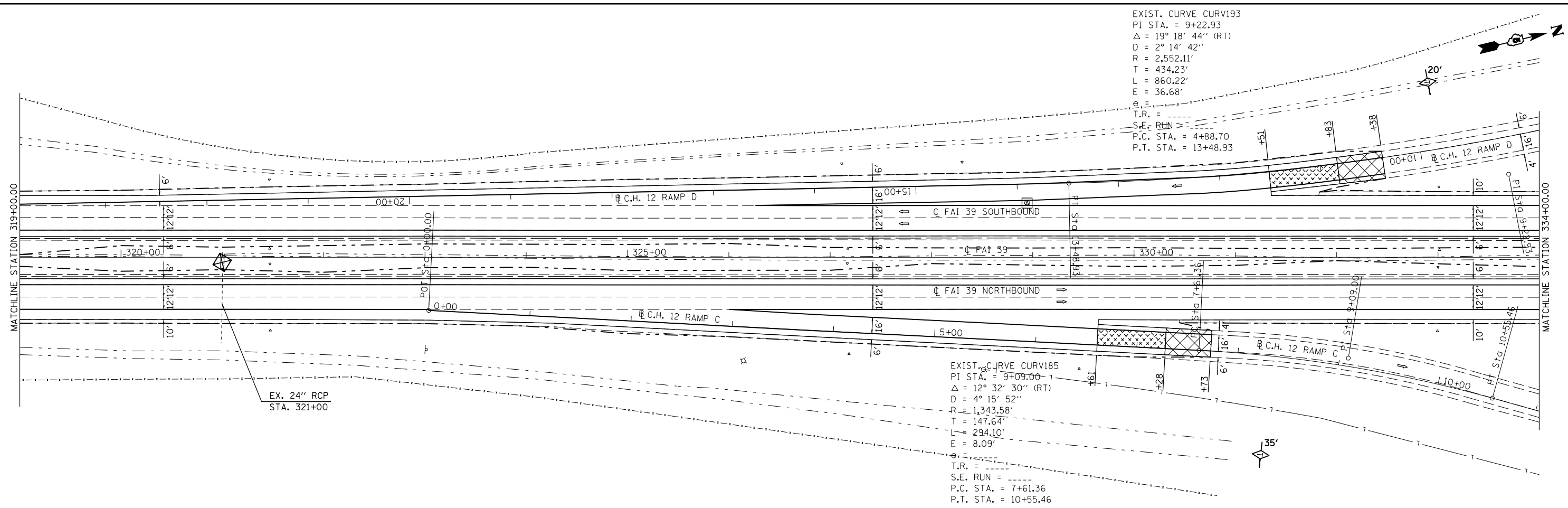

- LEGEND**
- HEAVY DUTY EROSION CONTROL BLANKET
 - PORTLAND CEMENT CONCRETE SURFACE REMOVAL - BUTT JOINT
 - CLASS D PATCH, 10'
 - CONCRETE PAVEMENT SCARIFICATION
 - PERIMETER EROSION BARRIER
 - INLET AND PIPE PROTECTION
 - TEMPORARY DITCH CHECKS
 - FRAMES AND GRATES TO BE ADJUSTED

FILE NAME =	USER NAME = bergenej	DESIGNED -	REVISED -
ei:\pw\work\p1dot\bergenej\0373914\0570206-shr-dblp1n.dgn		DRAWN -	REVISED -
		CHECKED -	REVISED -
		DATE -	REVISED -
#MODELNAME#	PLOT DATE = 8/7/2014		

**STATE OF ILLINOIS
 DEPARTMENT OF TRANSPORTATION**

**I 39
 PLAN SHEET**

SCALE: SHEET 2 OF 9 SHEETS STA. 319+00 TO STA. 349+00

F.A.I. RTE.	SECTION	COUNTY	TOTAL SHEETS	SHEET NO.
39	(57-3,57-4)RS	MCLEAN	90	30
CONTRACT NO. 70A20				
ILLINOIS FED. AID PROJECT				