

STATE OF ILLINOIS  
DEPARTMENT OF TRANSPORTATION  
DIVISION OF HIGHWAYS

**PROPOSED  
HIGHWAY PLANS**

FAP ROUTE 71 (IL 54)  
SECTION D5 EAB CONTROL 2015-1

EMERALD ASH BORER CONTROL  
KENNEY TO FARMER CITY  
DEWITT COUNTY  
C-95-037-14

FOR INDEX OF SHEETS, SEE SHEET NO. 2

F.A.P. RTE.	SECTION	COUNTY	TOTAL SHEETS	SHEET NO.
71	D5 EAB CONTROL 2015-1	DEWITT	5	1
		ILLINOIS	CONTRACT NO. 70A82	

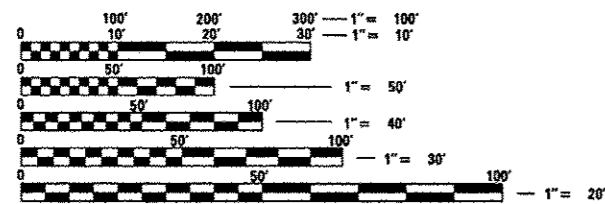
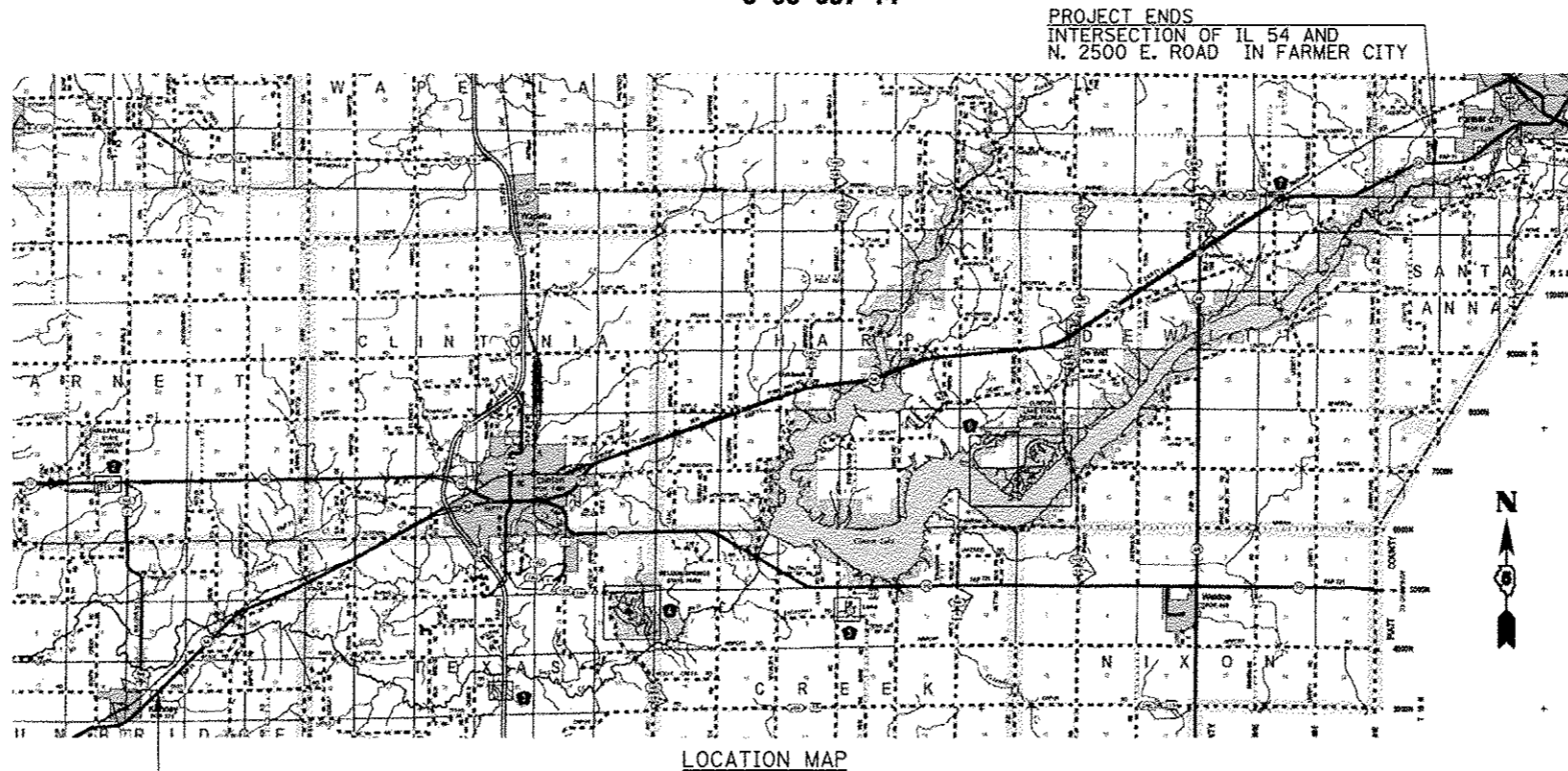

FULL SIZE PLANS HAVE BEEN PREPARED USING STANDARD ENGINEERING SCALES. REDUCED SIZED PLANS WILL NOT CONFORM TO STANDARD SCALES. IN MAKING MEASUREMENTS ON REDUCED PLANS, THE ABOVE SCALES MAY BE USED.

J.U.L.I.E.  
JOINT UTILITY LOCATION INFORMATION FOR EXCAVATION  
1-800-892-0123  
OR 811

TOWNSHIPS  
TEXAS, CLINTONIA, HARP, DEWITT AND SANTA ANNA

PROJECT ENGINEER **JASON STULTS**  
PROJECT MANAGER **RUSTIN KEYS**  
DESIGNER **BRIAN CASTRO**  
(217) 465-4181  
CONTRACT NO. 70A82

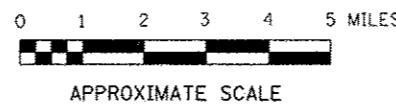

GROSS LENGTH = 114,787.20 FT. = 21.740 MILE  
NET LENGTH = 114,787.20 FT. = 21.740 MILE

STATE OF ILLINOIS  
DEPARTMENT OF TRANSPORTATION  
DIVISION OF HIGHWAYS

SUBMITTED JUNE 25 20 14

*Kensel A. Lamath*  
DEPUTY DIRECTOR OF HIGHWAYS, REGION ENGINEER

Aug 15 20 14  
*John D. Baranzelli, P.E.*  
ENGINEER OF DESIGN AND ENVIRONMENT

Aug 15 20 14  
*Omer Osman, P.E.*  
DIRECTOR OF HIGHWAYS, CHIEF ENGINEER

PRINTED BY THE AUTHORITY  
OF THE STATE OF ILLINOIS

## INDEX OF SHEETS

- 1 COVER
- 2 INDEX AND GENERAL NOTES
- 3 SUMMARY OF QUANTITIES
- 4 PRAIRIE REMNANT LOCATIONS
- 5 WETLAND LOCATION

## GENERAL NOTES

### G.N. - 100

ENGLISH UNITS OF MEASUREMENT SHALL GOVERN OVER AND SUPERSEDE ANY METRIC UNITS SHOWN IN THIS CONTRACT. WHERE INCLUDED, METRIC UNITS ARE FOR INFORMATION ONLY.

### G.N. - 201SP

TREES TO BE REMOVED ARE TO NOT BE WITHIN THE RAILROAD RIGHT-OF-WAY. TREES THAT ARE CUT WITHIN THE IDOT RIGHT-OF-WAY SHOULD NOT BE ALLOWED TO FALL WITHIN THE RAILROAD RIGHT-OF-WAY. THE CONTRACTOR IS NOT ALLOWED TO PERFORM WORK WITHIN THE RAILROAD RIGHT-OF-WAY WITHOUT AUTHORIZATION FROM THE RAILROAD. THE ENGINEER WILL MAKE FINAL DETERMINATION OF WHICH TREES ARE TO BE REMOVED.

## HIGHWAY STANDARDS

- 000001-06 STANDARD SYMBOLS, ABBREVIATIONS AND PATTERNS  
 001006 DECIMAL OF AN INCH AND OF A FOOT  
 701001-02 OFF-ROAD OPERATIONS, 2L, 2W, MORE THAN 15' (4.5 M) AWAY  
 701006-05 OFF-ROAD OPERATIONS, 2L, 2W, 15' (4.5 M) TO 24" (600 MM) FROM PAVEMENT EDGE  
 701201-04 LANE CLOSURE, 2L, 2W, DAY ONLY, FOR SPEEDS  $\geq$  45 MPH  
 701301-04 LANE CLOSURE, 2L, 2W, SHORT TIME OPERATIONS  
 701311-03 LANE CLOSURE, 2L, 2W, MOVING OPERATIONS - DAY ONLY  
 701901-03 TRAFFIC CONTROL DEVICES

FILE NAME =	USER NAME = cestrab	DESIGNED -	REVISED -	<b>STATE OF ILLINOIS DEPARTMENT OF TRANSPORTATION</b>	<b>INDEX, GENERAL NOTES AND HIGHWAY STANDARDS</b>	F.A.P. RTE.	SECTION	COUNTY	TOTAL SHEETS	SHEET NO.
c:\pwork\pvidat\cestrab\0402165\0570	02-shr\ind\gend\generalnotes.dgn	DRAWN -	REVISED -			71	D5 EAB CONTROL 2015-1	DEWITT	5	2
	PLOT SCALE = 48,000 1/1 in.	CHECKED -	REVISED -			CONTRACT NO. 70A82				
#MODELNAME#	PLOT DATE = 6/24/2014	DATE -	REVISED -			SCALE:	SHEET 2 OF 5 SHEETS	STA.	TO STA.	ILLINOIS FED. AID PROJECT

## SUMMARY OF QUANTITIES

CODE NO.	ITEM	UNIT	TOTAL QUANTITY
20100210	TREE REMOVAL (OVER 15 UNITS DIAMETER)	UNIT	2500
67100100	MOBILIZATION	L SUM	1.0
70100450	TRAFFIC CONTROL AND PROTECTION, STANDARD 701201	L SUM	1.0

FAP 71 (IL 54)
DEWITT COUNTY
RURAL (100% STATE)
0031

3

**NOTE:** TREE REMOVAL WITHIN PRAIRIE REMNANTS, AS DEFINED HEREIN AND BY THE ENGINEER, SHALL BE CONDUCTED IN A MANNER TO MINIMIZE ADVERSE EFFECTS TO THE PRAIRIE. NO MACHINERY SHALL BE PERMITTED WITHIN A PRAIRIE REMNANT.

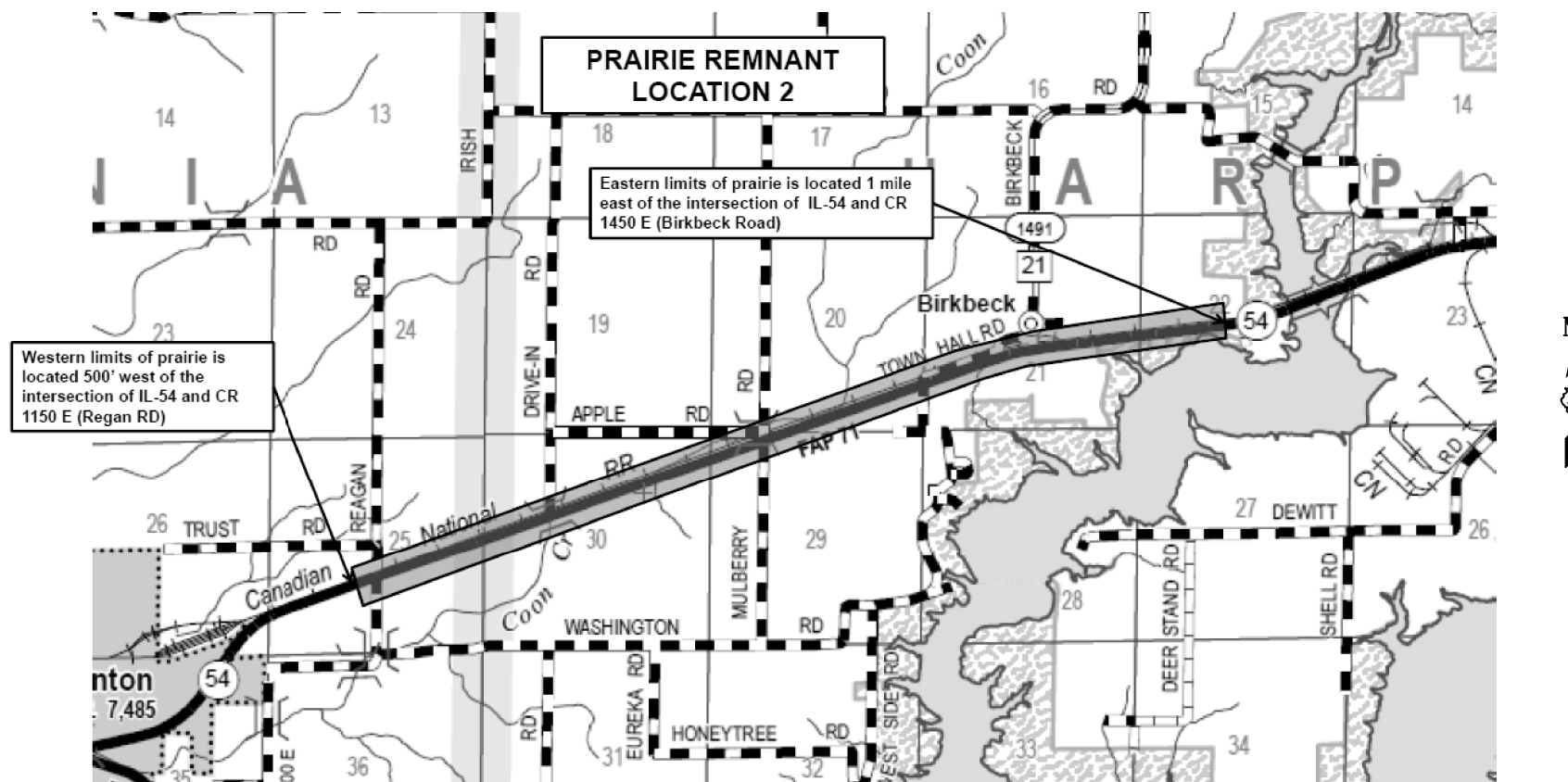
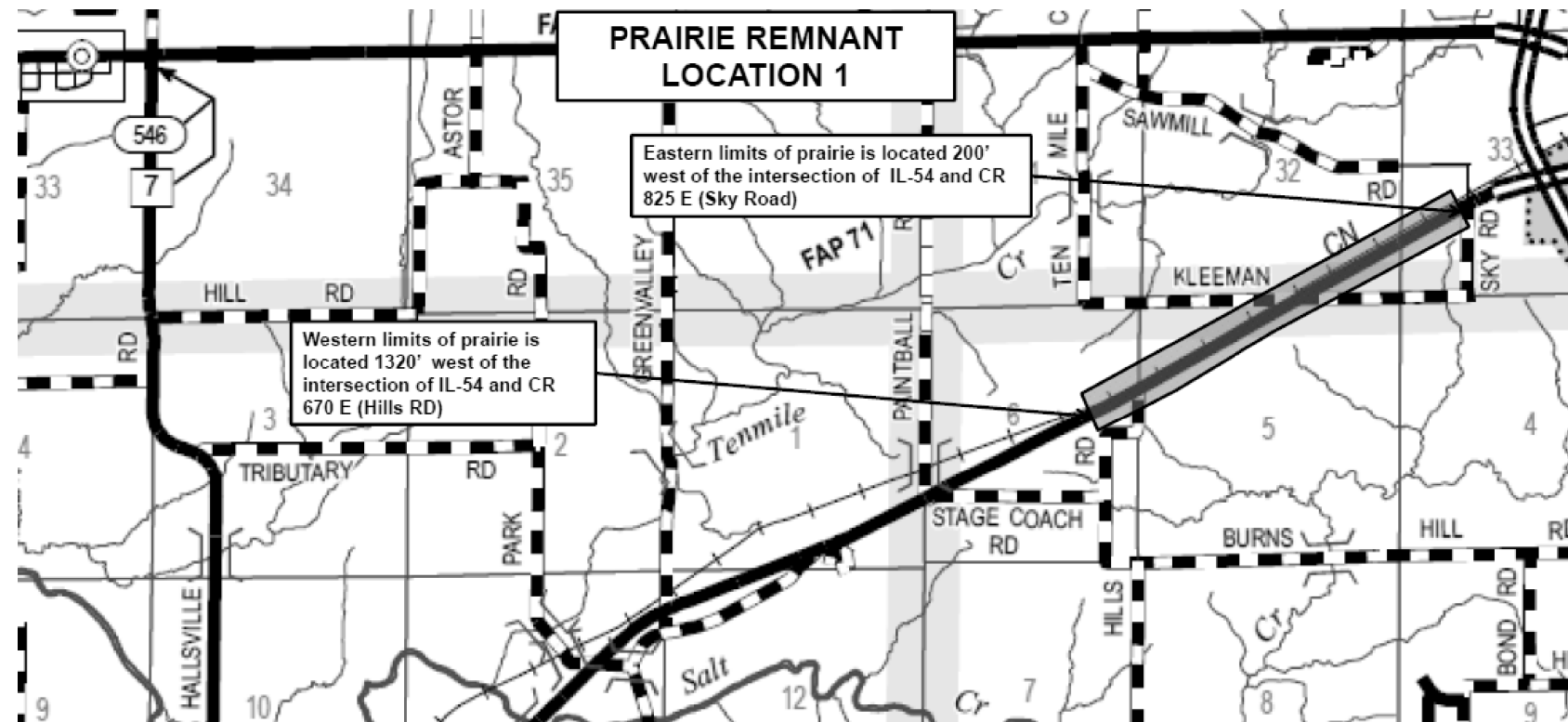

FILE NAME =	USER NAME = castrab	DESIGNED -	REVISED -	<b>STATE OF ILLINOIS DEPARTMENT OF TRANSPORTATION</b>	<b>PRAIRIE REMNANT LOCATIONS</b>			F.A.P. RTE.	SECTION	COUNTY	TOTAL SHEETS	SHEET NO.	
et:\pwork\pwork\castrab\d0402165\0570482-sht-environmental.dgn		DRAWN -	REVISED -		SCALE:	SHEET 4 OF 5 SHEETS	STA.	TO STA.	71	D5 EAB CONTROL 2015-1	DEWITT	5	4
PLOT SCALE = 80.0000' / in.		CHECKED -	REVISED -		CONTRACT NO. 70A82								
*MODELNAME*		DATE -	REVISED -		ILLINOIS FED. AID PROJECT								



NOTE: TREE REMOVAL SHALL NOT TAKE PLACE WITHIN THE WETLANDS AREA OUTLINED IN THE MAP ABOVE.

FILE NAME =	USER NAME = castrab	DESIGNED -	REVISED -
et:\pw\work\p\idot\castrab\d0402165\0570	62-sht-environmental.dgn	DRAWN -	REVISED -
*MODELNAME*	PLOT SCALE = 80.0000' / in.	CHECKED -	REVISED -
	PLOT DATE = 6/24/2014	DATE -	REVISED -

STATE OF ILLINOIS  
DEPARTMENT OF TRANSPORTATION

WETLAND LOCATION

SCALE: SHEET 5 OF 5 SHEETS STA. TO STA.

F.A.P. RTE.	SECTION	COUNTY	TOTAL SHEETS	SHEET NO.
71	D5 EAB CONTROL 2015-1	DEWITT	5	5
CONTRACT NO. 70A82				
ILLINOIS FED. AID PROJECT				