

- LEGEND**
- ① PROPOSED HOT-MIX ASPHALT SURFACE REMOVAL - 1 1/2"
 - ② PROPOSED EXCAVATING AND GRADING EXISTING SHOULDER
 - ③ PROPOSED LEVELING BINDER (MACHINE METHOD) - 2 1/4"
 - ④ PROPOSED HOT-MIX ASPHALT SURFACE COURSE, IL 9.5 N50 - 1 1/2"
 - ⑤ PROPOSED INCIDENTAL HMA SURFACING
 - ⑥ PROPOSED HOT-MIX ASPHALT SHOULDER (8" THICK - 4' WIDTH)
 - ⑦ PROPOSED MAILBOX TURN TURNOUT
 - ⑧ PROPOSED AGGREGATE WEDGE SHOULDER, TYPE B

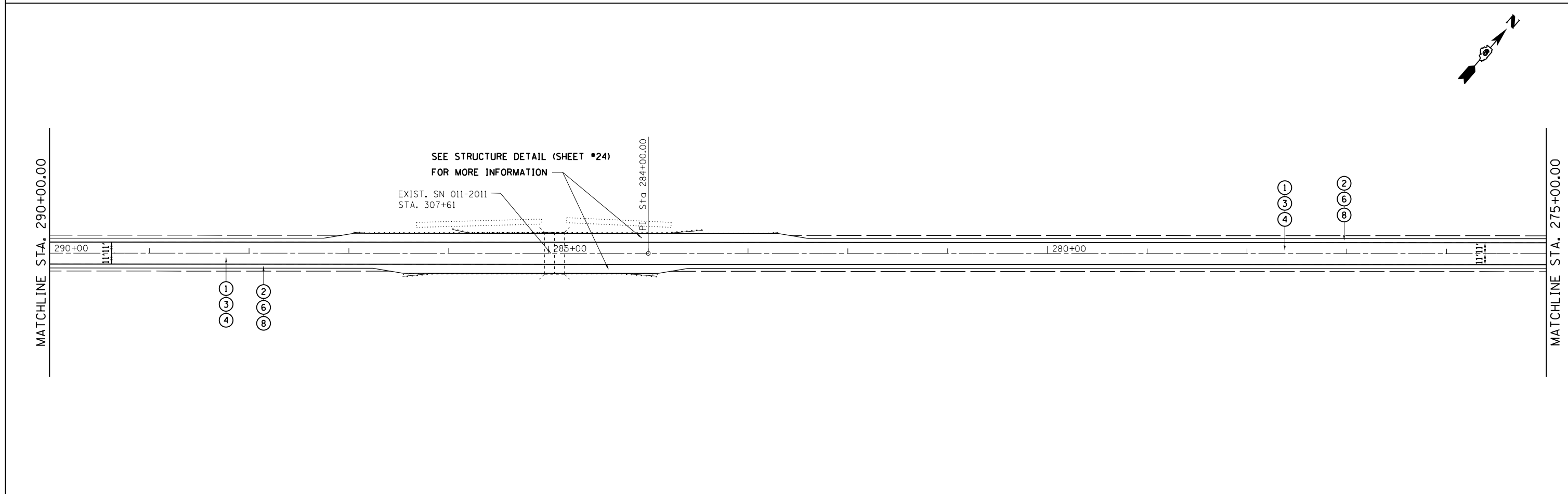

FILE NAME =	USER NAME = pricesa	DESIGNED -	REVISED -	STATE OF ILLINOIS DEPARTMENT OF TRANSPORTATION	IL 16 PLAN SHEETS				F.A.P. RTE.	SECTION	COUNTY	TOTAL SHEETS	SHEET NO.	
ce:\pwwork\pwwork\pricesa\d0239884\067204-sht-50pin.dgn		DRAWN -	REVISED -		SCALE: SHEET OF SHEETS STA. TO STA.				325	.	CHRISTIAN	28	14	
	PLOT SCALE = 100.0000' / in.	CHECKED -	REVISED -											
	PLOT DATE = Aug-14-2014 03:08:36PM	DATE -	REVISED -											
											CONTRACT NO. 72E04		ILLINOIS FED. AID PROJECT	