

- LEGEND**
- ① PROPOSED HOT-MIX ASPHALT SURFACE REMOVAL - 1 1/2"
 - ② PROPOSED EXCAVATING AND GRADING EXISTING SHOULDER
 - ③ PROPOSED LEVELING BINDER (MACHINE METHOD) - 2 1/4"
 - ④ PROPOSED HOT-MIX ASPHALT SURFACE COURSE, IL 9.5 N50 - 1 1/2"
 - ⑤ PROPOSED INCIDENTAL HMA SURFACING
 - ⑥ PROPOSED HOT-MIX ASPHALT SHOULDER (8" THICK - 4' WIDTH)
 - ⑦ PROPOSED MAILBOX TURN TURNOUT
 - ⑧ PROPOSED AGGREGATE WEDGE SHOULDER, TYPE B

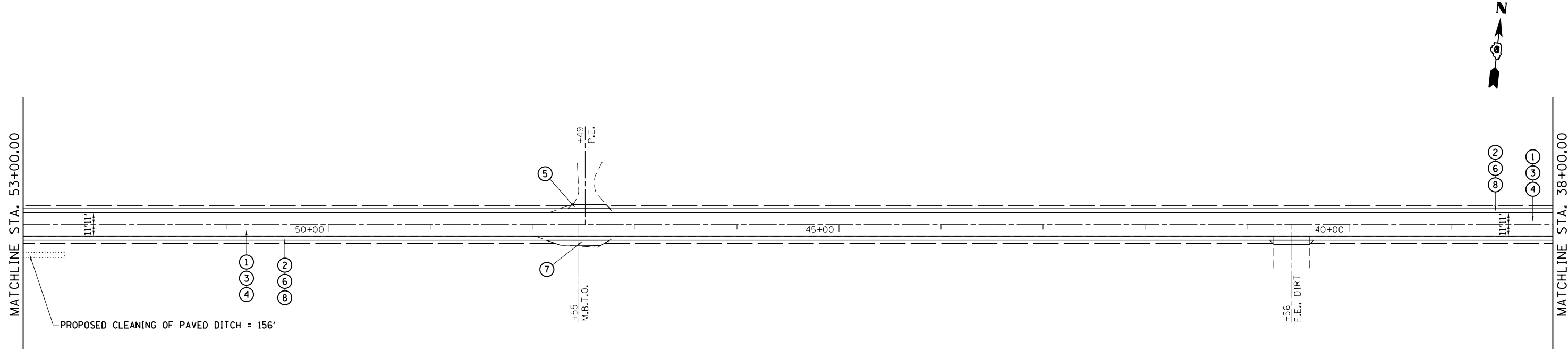
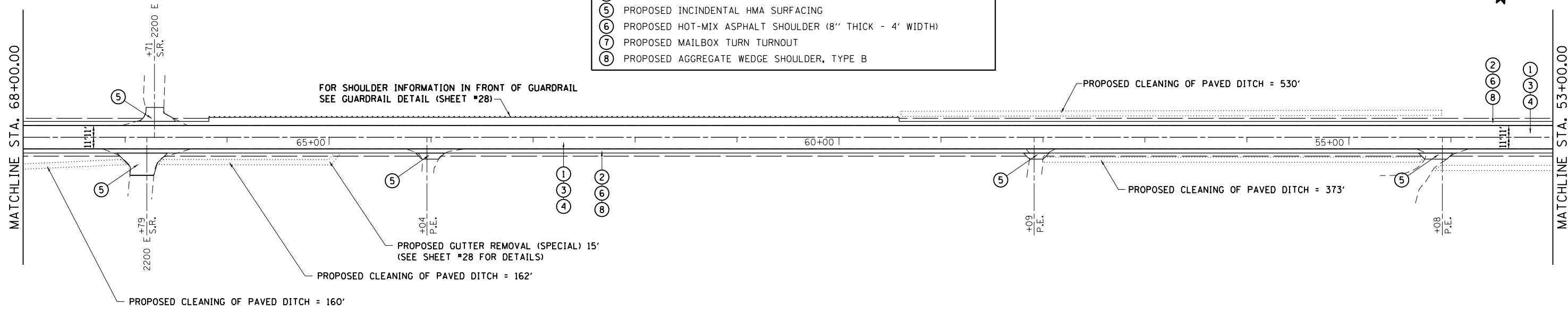

FILE NAME =	USER NAME = pricesa	DESIGNED -	REVISED -
ei:\pwwork\pwwork\pricesa\d0239884\0672604-sht-50p1n.dgn		DRAWN -	REVISED -
	PLOT SCALE = 100.0000' / in.	CHECKED -	REVISED -
	PLOT DATE = Aug-14-2014 03:08:39PM	DATE -	REVISED -

**STATE OF ILLINOIS
DEPARTMENT OF TRANSPORTATION**

IL 16 PLAN SHEETS

SCALE: SHEET OF SHEETS STA. TO STA.

F.A.P. RTE.	SECTION	COUNTY	TOTAL SHEETS	SHEET NO.
325	.	CHRISTIAN	28	22
ILLINOIS FED. AID PROJECT			CONTRACT NO. 72E04	

• ((15)RS-5, (16)RS-4)-1