

DETOUR MAP

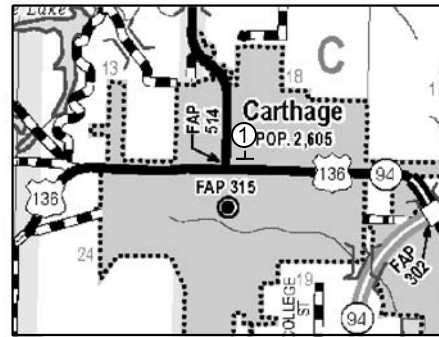

CARTHAGE

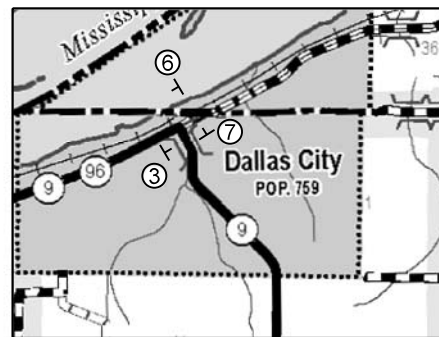

DALLAS CITY

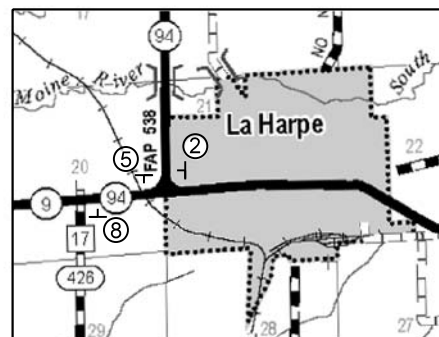

LA HARPE

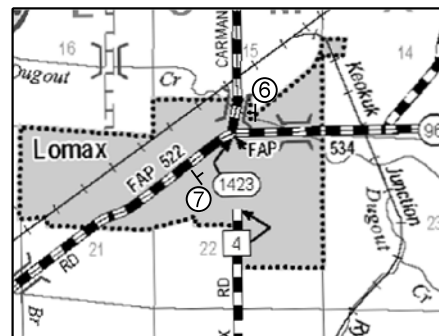

LOMAX

SIGN	MILES AHEAD	WITH
1	13	
2	8	M4-10R
3	5	M4-8 & M6-3
4	1	M4-10L
5	8	M4-10R

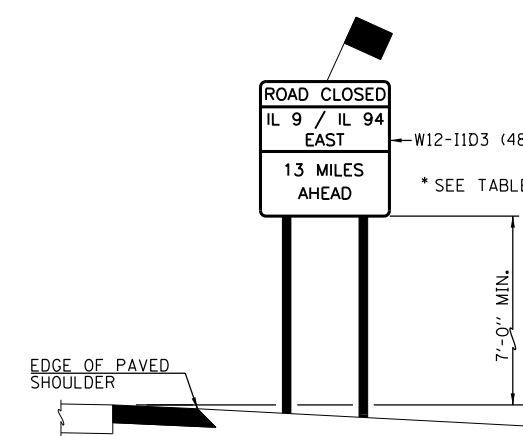

SIGN 1

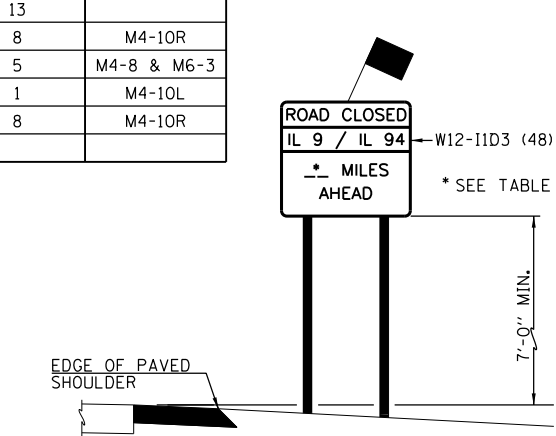

SIGNS 2, 3, 4 & 5

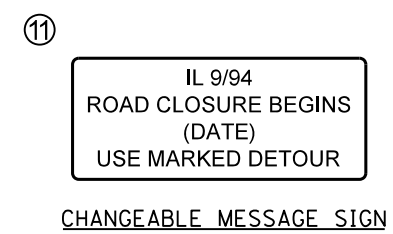
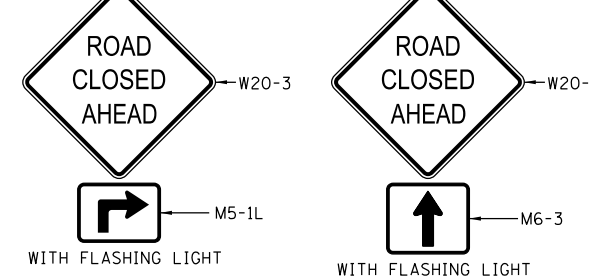
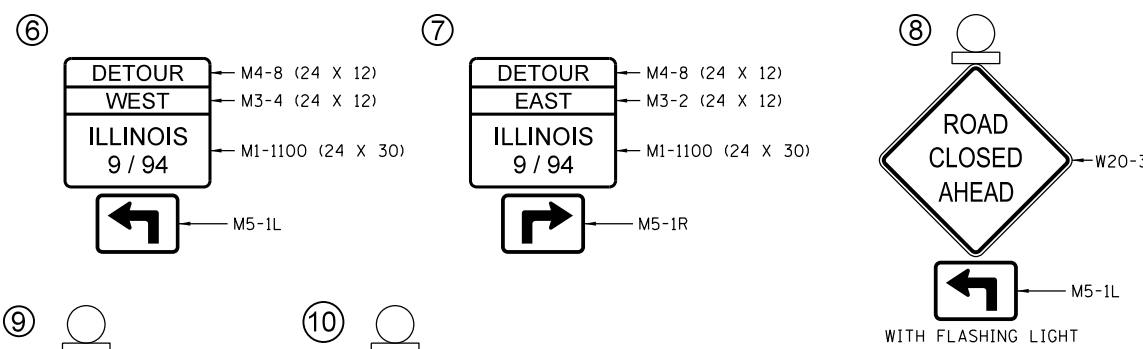
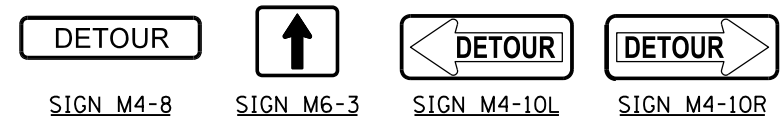

PRE-ROAD CLOSURE WORK

- 1.) THE CONTRACTOR SHALL REMOVE ALL TREES PER TREE REMOVAL SCHEDULE.

SUGGESTED CONSTRUCTION SEQUENCE

WORK DONE UNDER ROAD CLOSURE

- 1.) THE CONTRACTOR SHALL PLACE PORTABLE CHANGEABLE MESSAGE SIGN BOARDS TWO WEEKS BEFORE CONSTRUCTION BEGINS.
- 2.) THE CONTRACTOR SHALL PLACE ROAD CLOSED SIGNS IN ACCORDANCE WITH THIS SHEET AND STANDARD BLR 21-9.
- 3.) REMOVE EXISTING PAVEMENT AND AGGREGATE SHOULDERS FROM STA. 632+62 TO STA. 633+38.
- 4.) REMOVE EXISTING STRUCTURE STA. 633+00.54, AND EXISTING GUARDRAIL.
- 5.) INSTALL TRIPLE BARREL PRECAST CONCRETE BOX CULVERT AND GRANULAR CULVERT BACKFILL STA. 633+00.54.
- 6.) INSTALL HMA BASE COURSE, 9/2" AND HMA SURFACE COURSE, STA. 632+62 TO STA. 633+38.
- 7.) THE CONTRACTOR SHALL OPEN THE ROAD TO TRAFFIC AND COMPLETE REMAINING WORK UNDER FLAGGERS.

WORK DONE UNDER FLAGGERS

- 1.) CONSTRUCT CAST IN PLACE CONCRETE END SECTIONS AND PERMANENT STEEL SHEET PILING WINGWALLS WITH CAPS @ STA. 633+00.54 LT. & RT.
- 2.) SHAPE AND GRADE EARTH FOR SHOULDERS AND DITCHES STA. 630+79 TO STA. 634+50.
- 3.) CONSTRUCT AGGREGATE WEDGE SHOULDERS STA. 630+79 TO STA. 634+50 RT. AND STA. 632+00 TO STA. 634+50 LT.
- 4.) FINAL STRIPING, SEEDING AND MISCELLANEOUS CLEANUP.

FILE NAME =	USER NAME =	DESIGNED - RKA	REVISED -
FILES		DRAWN - RKA	REVISED -
	PLOT SCALE =	CHECKED - CPK	REVISED -
	PLOT DATE = \$DATE*	DATE - 3/25/08	REVISED -

Allen Henderson & Associates, Inc.
 Civil and Structural Engineers Springfield, IL.
 62703 Phone: (217)544-8033 IL Design Firm
 No. 184-001907

CONSTRUCTION SEQUENCE & ROAD CLOSED SIGNING		
SCALE: NONE	SHEET NO. 1 OF 1 SHEETS	STA. 630+00 TO STA. 634+50

F.A.P. RTE.	SECTION	COUNTY	TOTAL SHEETS	SHEET NO.
685	(115)B-2	HANCOCK	28	13
CONTRACT NO. 72F07				
FED. ROAD DIST. NO. ILLINOIS FED. AID PROJECT				