

**NOTE:**  
 PROP. GUARDRAIL REM. - IL 9/96 - STA. 43+18.00 TO STA. 44+61.00 RT & HMA SURF STA. 43+29.00 TO STA. 45+19.00 LT.  
 TR 1120 E. - STA. 9+70.00 TO STA. 9+90.00 RT.  
 TR 2920 N (APPLE RIVER RD.) - STA. 10+04.00 TO STA. 10+38.00 RT.  
 PROP. SPBGR ATTACH TO STR. IL 9/96 - STA. 43+20.00 TO STA. 43+34.00 RT. & STA. 43+28.00 TO STA. 43+42.00 LT.  
 PROP. SPBGR SHORT RADIUS - TR 1120 E. (102' Radius) - STA. 9+18.00 TO STA. 9+40.00 RT. TR 2920 N (APPLE RIVER RD.) (22' Radius) - STA. 10+21.00 TO STA. 10+39.00 RT.  
 PROP. SPBGR TA 6' POSTS - STA. 43+34.00 TO STA. 44+21.00 RT. & 43+42.00 TO 44+54.50 LT.  
 TR 1120 E. - STA. 9+15.00 TO 9+65.00 RT TR 2920 N (APPLE RIVER RD.) - STA. 10+39.00 TO 10+89.00 RT.  
 PROP. TRAF. BAR. TERM. T1 SPL. - IL 9/96 - STA. 44+21.50 TO STA. 44+71.50 RT. & STA. 44+54.50 TO STA. 45+04.50 LT.  
 TR 1120 E. - STA. 8+65.00 TO STA. 9+15.00 RT.  
 TR 2920 N (APPLE RIVER RD.) - STA. 10+89.00 TO STA. 11+39.00 RT.

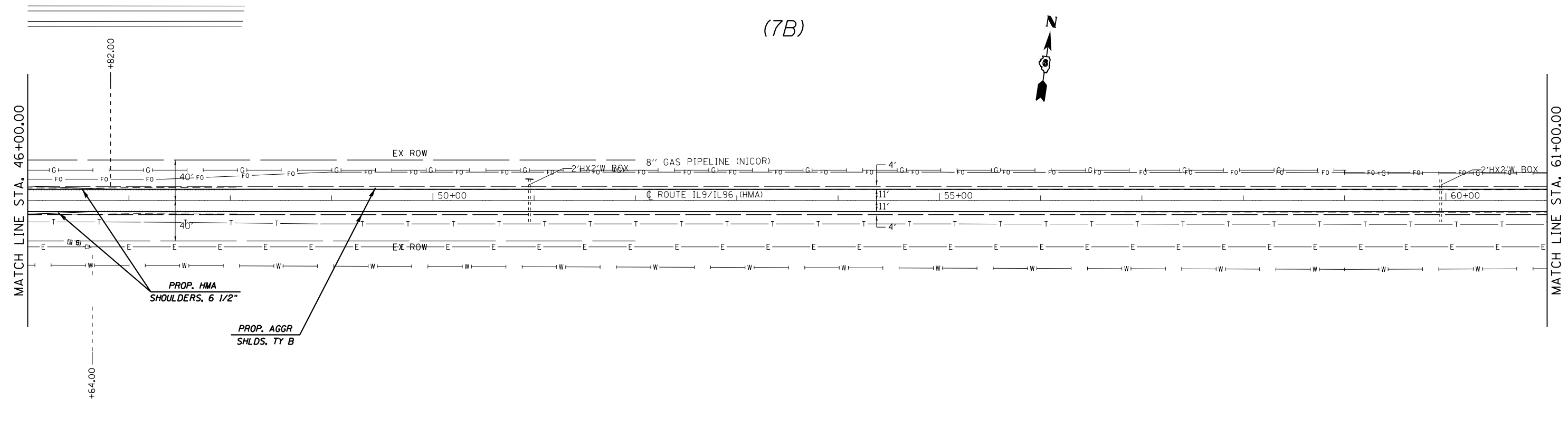

FILE NAME =	USER NAME = sparksgw	DESIGNED - JWC	REVISED -	<b>STATE OF ILLINOIS DEPARTMENT OF TRANSPORTATION</b>	<b>PLAN SHEETS - IL 91L 96</b>			F.A.P. RTE.	SECTION	COUNTY	TOTAL SHEETS	SHEET NO.		
Default	ei:\pw\work\pwidot\sparksgw\10296720\10672f32-sht-plan_rural.dgn	DRAWN - JWC	REVISED -					119	RS-11,113	RS-6	HANCOCK	95	33	
	PLOT SCALE = 100.0000' / in.	CHECKED - JWC	REVISED -		SCALE: 50			SHEET 4 OF 18 SHEETS			STA. 32+00.00 TO STA. 61+00.00		CONTRACT NO. 72F32	
	PLOT DATE = Jun-06-2014 10:35:31AM	DATE -	REVISED -		ILLINOIS FED. AID PROJECT									