

PAVEMENT MARKING LEGEND

(THERMOPLASTIC)

- (A) PAVEMENT MARKING - LINE - 5" WHITE (SOLID)
- (B) PAVEMENT MARKING - LINE - 5" DOUBLE YELLOW (SOLID)
- (C) PAVEMENT MARKING - LINE - 6" WHITE (6' SKIP- 2' DASH)

(PREFORMED PLASTIC, TYPE B - INLAID -)

- (D) PAVEMENT MARKING - LINE - 5" YELLOW (SKIP-DASH)
- (E) PAVEMENT MARKING - LINE - 8" WHITE (SOLID)
- (F) PAVEMENT MARKING - LINE - 12" WHITE (SOLID)
- (G) PAVEMENT MARKING - LINE - 24" WHITE (SOLID)

(PAINT)

- (H) PAVEMENT MARKING - LINE - 5" WHITE (SOLID)
- (I) PAVEMENT MARKING - LINE - 5" YELLOW (DOUBLE SOLID)

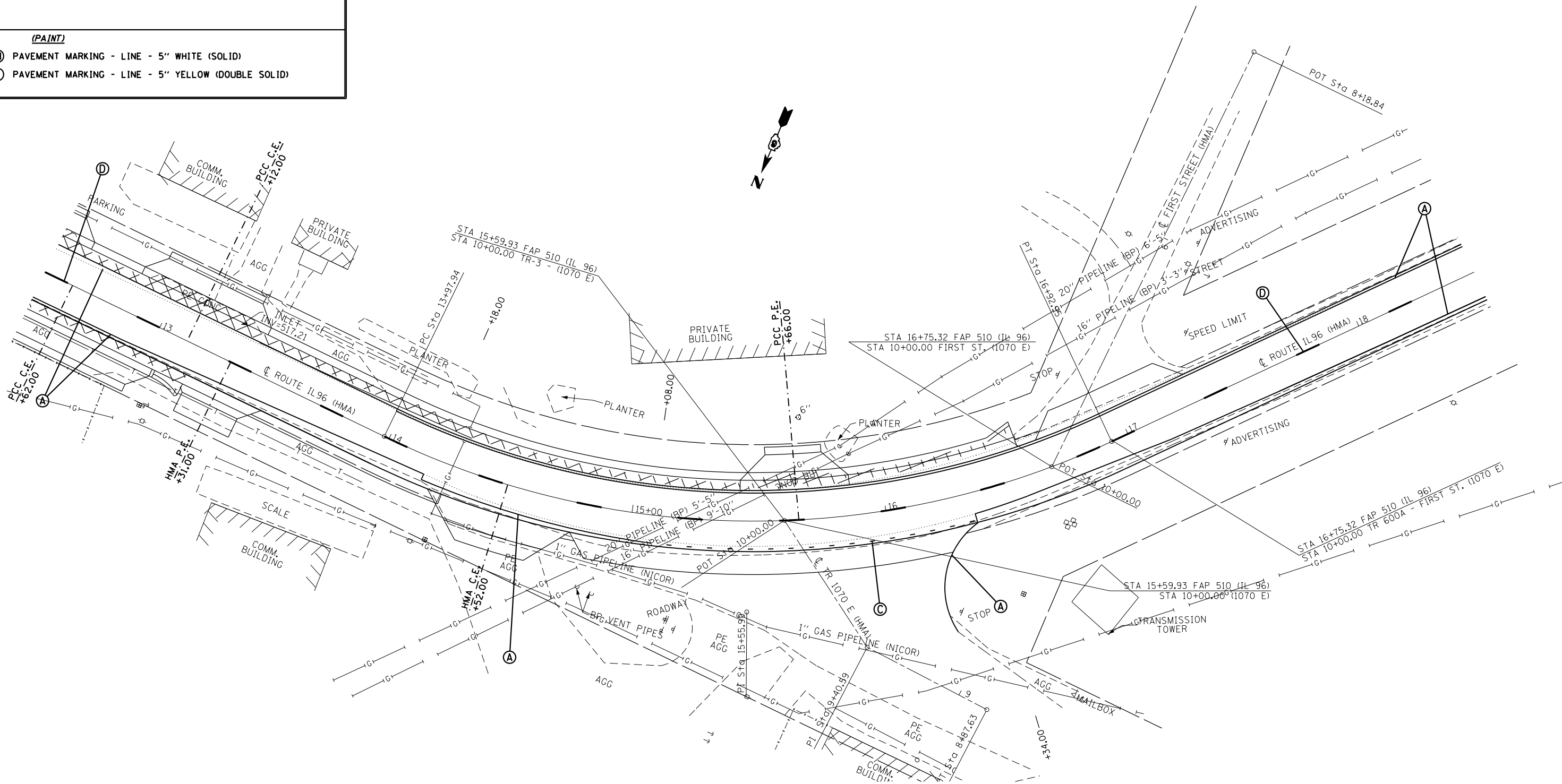

FILE NAME =	USER NAME = sparksgw	DESIGNED -	REVISED -
ct:\pw\work\p\midot\sparksgw\10296720\06720\F32-sh-t-pmk1.dgn		DRAWN -	REVISED -
Default	PLOT SCALE = 40.0000' / in.	CHECKED -	REVISED -
	PLOT DATE = Jun-06-2014 10:35:57AM	DATE -	REVISED -

**STATE OF ILLINOIS
DEPARTMENT OF TRANSPORTATION**

PAVEMENT MARKING DETAILS

SCALE: 50 SHEET 1 OF 3 SHEETS STA. 18+50 TO STA. 12+50

F.A.P. RTE.	SECTION	COUNTY	TOTAL SHEETS	SHEET NO.
..	(119)RS-11,(113)RS-6	HANCOCK	95	57
CONTRACT NO. 72F32			ILLINOIS FED. AID PROJECT	

**685 & 510