

LEGEND	
	TRAFFIC SIGNAL WITH BACKPLATE
	DRUM WITH STEADY BURNING LIGHT
	CRYSTAL/BIDIRECTIONAL BARRIER WALL/GUARDRAIL MARKER
	DOUBLE VERTICAL PANEL
	TYPE III BARRICADE
	IMPACT ATTENUATOR
	HMA BASE COURSE

- GENERAL NOTES**
- SEE STANDARD 701321 FOR DETAILS OF TRAFFIC CONTROL AND PROTECTION NOT SHOWN
  - PLACEMENT AND REMOVAL OF TEMPORARY PAVEMENT MARKINGS - INCLUDED IN THE COST FOR TRAFFIC CONTROL AND PROTECTION STANDARD 701321
  - SEE SHEETS 16-17 FOR SECTION A-A AND B-B
  - DRUMS IN TAPER SHALL BE POSITIONED TO ALLOW ACCESS TO FIELD ENTRANCES ON THE SOUTH SIDE OF US 36

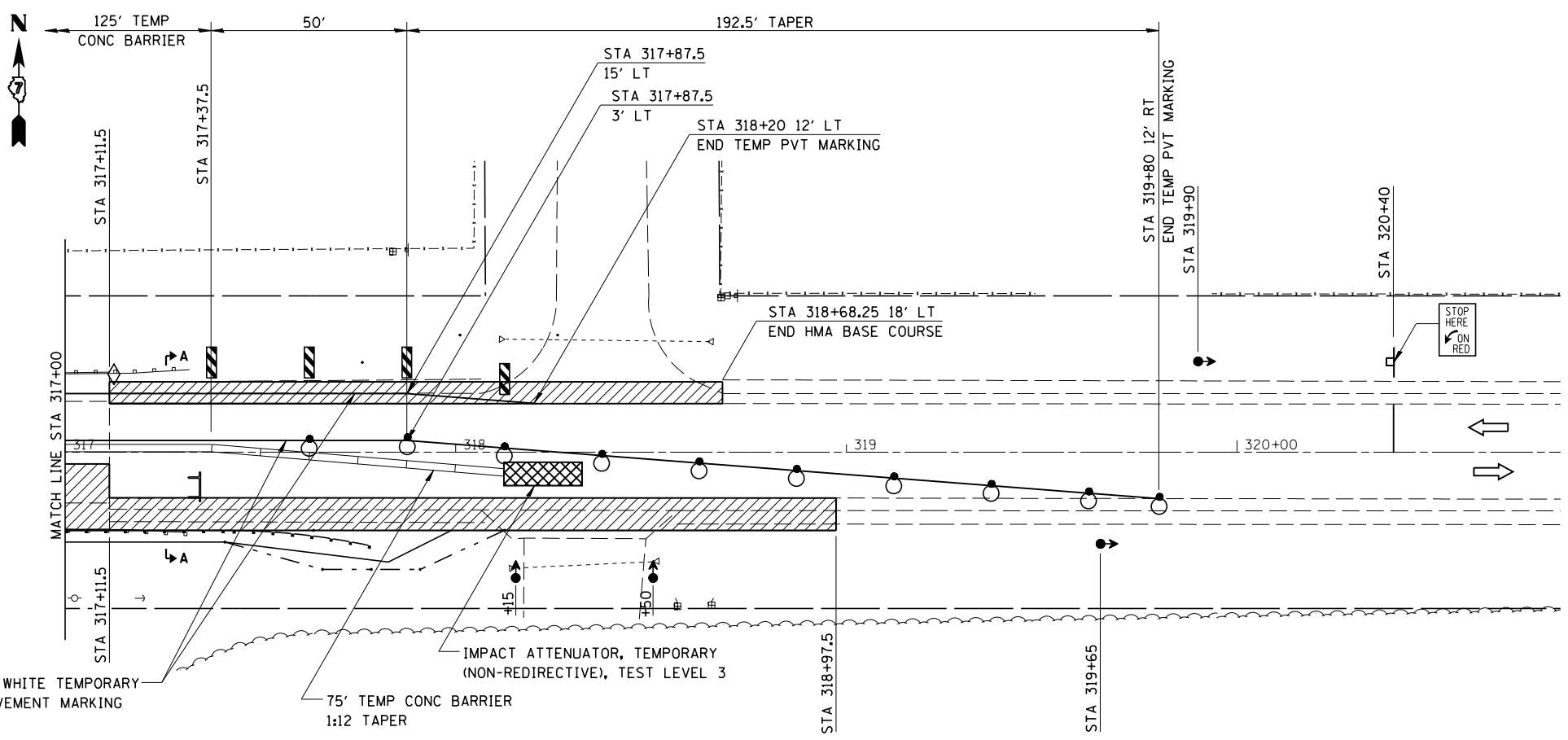

- SEQUENCE OF OPERATIONS**
- PRELIMINARY PHASE**  
 PRELIMINARY PHASE CONSTRUCTION WILL CONSIST OF THE FOLLOWING:
- REMOVE PAVED SHOULDER LEFT STA. 314+78 TO STA. 318+06.5
  - REMOVE PAVEMENT LEFT STA 318+06.5 TO STA 318+68.25
  - CONSTRUCT HMA BASE COURSE LEFT STA 314+78 TO STA 318+68.25
  - INSTALL TRAFFIC CONTROL DEVICES AS SHOWN ON STANDARD 701321 AND AS DETAILED ON THE PLANS.
- STAGE 1**  
 STAGE 1 CONSTRUCTION WILL CONSIST OF THE FOLLOWING:
- REMOVE GUARDRAIL ALONG EASTBOUND LANE
  - REMOVE PAVED SHOULDER RIGHT STA. 314+28.25 TO STA. 318+97.5
  - REMOVE STAGE 1 PORTIONS OF APPROACH SLABS RIGHT STA. 316+38.5 TO STA. 316+58.5 AND RIGHT STA. 316+91.5 TO STA. 317+11.5
  - REMOVE STAGE 1 PORTIONS OF EXISTING BRIDGE RIGHT STA. 316+58.5 TO STA. 316+91.5
  - CONSTRUCT STAGE 1 PORTION OF PROPOSED STRUCTURE
  - CONSTRUCT EMBANKMENT AND EXCAVATE DITCHES RIGHT STA. 314+28.25 TO STA. 318+97.5
  - CONSTRUCT HMA BASE COURSE AND HMA SHOULDER RIGHT STA. 314+28.25 TO STA. 318+97.4
  - INSTALL GUARDRAIL, TERMINALS, AND MARKERS RIGHT STA. 315+28.4 TO STA. 317+78.4



JOB = 2223.1  
 FILE NAME = D774165-sht-stgl.dgn  
 PLOT SCALE = 48.0000' / in.  
 PLOT DATE = 8/11/2014

DESIGNED - NAK  
 DRAWN - AJH  
 CHECKED - NAK  
 DATE - 8/25/2010

REVISED -  
 REVISED -  
 REVISED -  
 REVISED -

**STATE OF ILLINOIS  
 DEPARTMENT OF TRANSPORTATION**

**STAGE 1 TRAFFIC CONTROL AND PROTECTION**

SHEET NO. 1 OF 2 SHEETS

F.A.P. RTE.	SECTION	COUNTY	TOTAL SHEETS	SHEET NO.
323	(142BY) BR	MOULTRIE	35	14
FED. ROAD DIST. NO. ILLINOIS FED. AID PROJECT			CONTRACT NO. 74165	