

**EAST ABUTMENT ELEVATION**

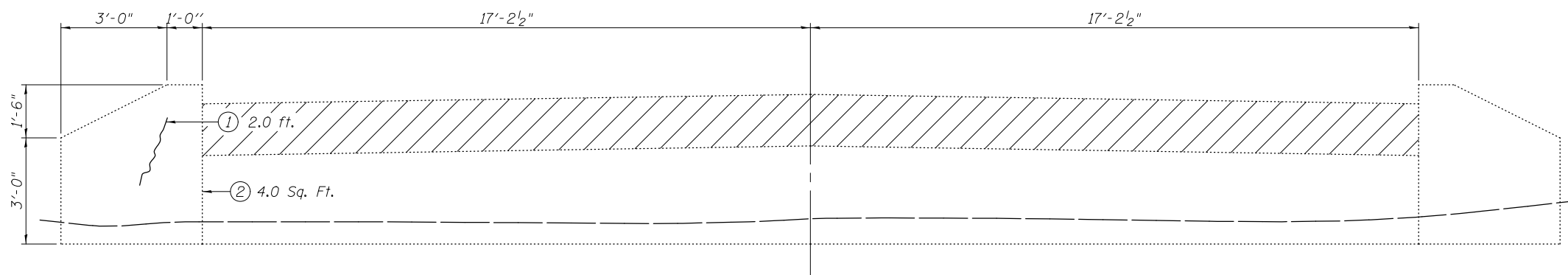

**WEST ABUTMENT ELEVATION**

\* Existing reinforcement bars extending into the removal area shall be cleaned, straightened and incorporated into the new construction. Any reinforcement bars that are damaged during concrete removal operations shall be replaced with an approved bar splicer or anchorage system. Cost shall be included in Concrete Removal.

**LEGEND**

- ① Epoxy Crack Injection
- ② Structural Repair of Concrete (Depth equal to or less than 5 inches)

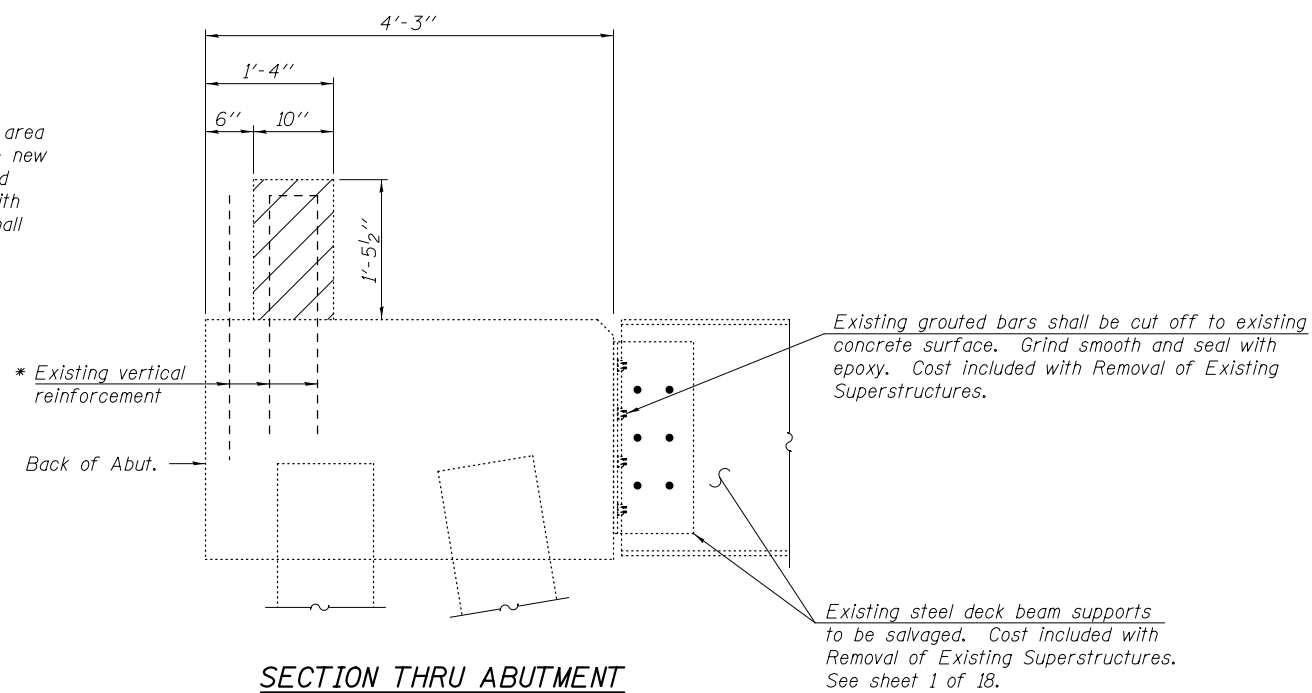
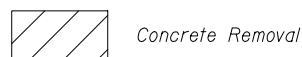

**BILL OF MATERIAL**

Item	Unit	Quantity
Concrete Removal	Cu. Yd.	3.1
Epoxy Crack Injection	Foot	2.0
Structural Repair Of Concrete (Depth Equal to or Less than 5 Inches)	Sq. Ft.	4.0