

PAY ITEM	UNIT	QUADRANT LOCATION						QUANTITY
		NE	SE	SW	NW	MEDIAN	ISLAND	
SIDEWALK REMOVAL	SO FT	51	40	0	0	86	0	177
CURB REMOVAL	FOOT	6	5	0	0	12	10	33
ISLAND REMOVAL	SO FT	0	0	0	0	0	35	35
PCC SIDEWALK 5"	SO FT	341	136	0	0	137	0	614
PCC BASE CSE WIDENING, 12"	SO YD	0	0	0	0	0	4	4
DETECTABLE WARNINGS	SO FT	10	10	0	0	20	0	40

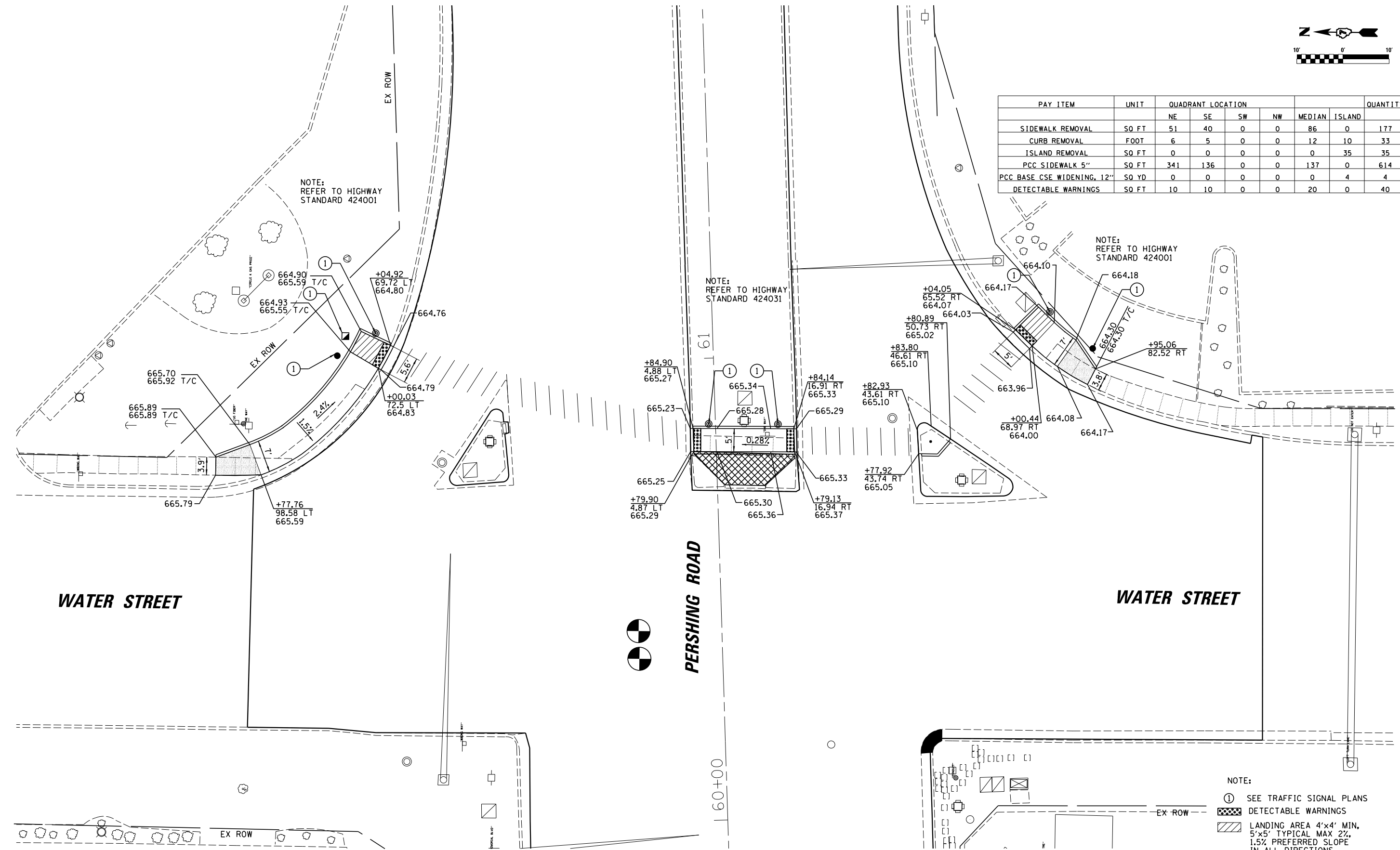

- NOTE:
- ① SEE TRAFFIC SIGNAL PLANS
  - ▣ DETECTABLE WARNINGS
  - ▨ LANDING AREA 4'x4' MIN, 5'x5' TYPICAL MAX 2%, 1.5% PREFERRED SLOPE IN ALL DIRECTIONS
  - ▤ TRANSITIONAL SEGMENT

• ISLAND REMOVAL, REPLACE WITH PCC BASE COURSE WIDENING AND HMA SURFACE (SEE PLAN SHEETS).

FILE NAME =	USER NAME = dbullock	DESIGNED - CAS	REVISED -
I:\DOT\6008 - 07 Var Var\Work Order 3	IL 121 Resurfacing\CADD\Civil\0774624-sht-dwg	DRAWN - DLB	REVISED -
Default	PLOT SCALE = 20.0000' / in.	CHECKED - JMB	REVISED -
	PLOT DATE = 8/21/2014	DATE - 8/13/14	REVISED -

**STATE OF ILLINOIS  
DEPARTMENT OF TRANSPORTATION**

<b>SIDEWALK RAMP DETAILS - WATER ST.</b>	
<b>FAP 320 (IL 121/L 48)</b>	
SCALE:	SHEET 5 OF 7 SHEETS STA. TO STA.

F.A.P. RTE.	SECTION	COUNTY	TOTAL SHEETS	SHEET NO.
320	(126)RS-2, 135RS-1	MACON	119	54
CONTRACT NO. 74624				
ILLINOIS FED. AID PROJECT				