

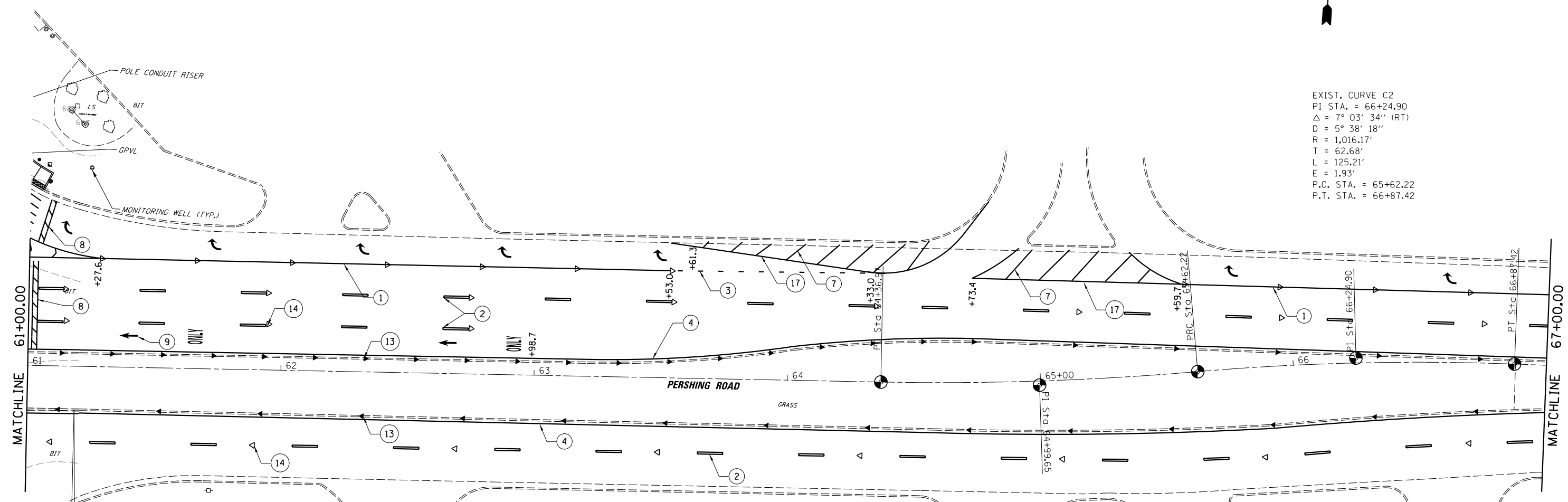

EXIST. CURVE C2
 PI STA. = 66+24.90
 $\Delta = 7^\circ 03' 34''$ (RT)
 D = 5° 38' 18"
 R = 1,016.17'
 T = 62.68'
 L = 125.21'
 E = 1.93'
 P.C. STA. = 65+62.22
 P.T. STA. = 66+87.42



LEGEND

- ① THERMOPLASTIC PAVEMENT MARKING - LINE 6" (WHITE)
- ② THERMOPLASTIC PAVEMENT MARKING - LINE 6" (WHITE SKIP DASH)
- ③ THERMOPLASTIC PAVEMENT MARKING - LINE 6" (WHITE DOTTED LINE)
- ④ THERMOPLASTIC PAVEMENT MARKING - LINE 4" (YELLOW)
- ⑤ THERMOPLASTIC PAVEMENT MARKING - LINE 4" (YELLOW SKIP DASH)
- ⑥ THERMOPLASTIC PAVEMENT MARKING - LINE 4" (DOUBLE YELLOW)
- ⑦ THERMOPLASTIC PAVEMENT MARKING - LINE 12" (WHITE)
- ⑧ THERMOPLASTIC PAVEMENT MARKING - LINE 24" (WHITE)
- ⑨ THERMOPLASTIC PAVEMENT MARKING - LETTERS AND SYMBOLS (WHITE)
- ⑩ PREFORMED PLASTIC PAVEMENT MARKING, TYPE B - 4" (YELLOW)
- ⑪ PREFORMED PLASTIC PAVEMENT MARKING, TYPE B - 6" (WHITE SKIP DASH)
- ⑫ PRISMATIC CURB REFLECTORS (CRYSTAL)
- ⑬ PRISMATIC CURB REFLECTORS (AMBER)
- ⑭ RAISED REFLECTIVE PAVEMENT MARKERS (ONE-WAY CRYSTAL)
- ⑮ RAISED REFLECTIVE PAVEMENT MARKERS (ONE-WAY AMBER)
- ⑯ RAISED REFLECTIVE PAVEMENT MARKERS (TWO-WAY AMBER)
- ⑰ THERMOPLASTIC PAVEMENT MARKING - LINE 8" (WHITE)

EXIST. CURVE C1
 PI STA. = 64+99.65
 $\Delta = 6^\circ 00' 50''$ (LT)
 D = 4° 48' 06"
 R = 1,193.27'
 T = 62.68'
 L = 125.25'
 E = 1.65'
 P.C. STA. = 64+36.97
 P.T. STA. = 65+62.22

FILE NAME =	USER NAME = csefert	DESIGNED - CAS	REVISED -
IL 121 Resurfacing\CADD\Civil\0774624-sht-prk		DRAWN - DLB	REVISED -
	PLOT SCALE = 40.0000' / in.	CHECKED - JMB	REVISED -
	PLOT DATE = 9/26/2014	DATE - 8/13/14	REVISED -

**STATE OF ILLINOIS
 DEPARTMENT OF TRANSPORTATION**

**PAVEMENT MARKING PLAN
 FAP 320 (IL 121/IL 48)**

SCALE: SHEET 11 OF 23 SHEETS STA. TO STA.

F.A.P. RTE.	SECTION	COUNTY	TOTAL SHEETS	SHEET NO.
320	(126)RS-2, 135RS-1	MACON	119	73
CONTRACT NO. 74624				
ILLINOIS FED. AID PROJECT				