

BILL OF MATERIALS			
CODE	ITEM	UNIT	QUANTITY
81028330	UNDERGROUND CONDUIT, PVC, 1 1/4" DIA	FOOT	62
87301225	ELECTRIC CABLE IN CONDUIT, SIGNAL NO. 14 3/C	FOOT	308
87301245	ELECTRIC CABLE IN CONDUIT, SIGNAL NO. 14 5/C	FOOT	36
87301255	ELECTRIC CABLE IN CONDUIT, SIGNAL NO. 14 7/C	FOOT	47
87301900	ELECTRIC CABLE IN CONDUIT, EQUIPMENT GROUNDING CONDUCTOR, NO. 6 1C	FOOT	62
87502700	TRAFFIC SIGNAL POST, ALUMINUM 16 FT.	EACH	1
87502720	TRAFFIC SIGNAL POST, ALUMINUM 18 FT.	EACH	3
87600100	PEDESTRIAN PUSH BUTTON POST, TYPE 1	EACH	3
87900200	DRILL EXISTING HANDHOLE	EACH	3
88040260	SIGNAL HEAD, POLYCARBONATE, LED, 2-FACE, 1-3-SECTION, 1-5-SECTION, BRACKET MOUNTED	EACH	3
88102825	PEDESTRIAN SIGNAL HEAD, POLYCARBONATE, LED, 1-FACE, BRACKET MOUNTED WITH COUNT DOWN TIMER	EACH	2
88102845	PEDESTRIAN SIGNAL HEAD, POLYCARBONATE, LED, 2-FACE, BRACKET MOUNTED WITH COUNT DOWN TIMER	EACH	1
88600100	DETECTOR LOOP, TYPE 1	FOOT	537
88800100	PEDESTRIAN PUSH BUTTON	EACH	4
89502375	REMOVE EXISTING TRAFFIC SIGNAL EQUIPMENT	EACH	1

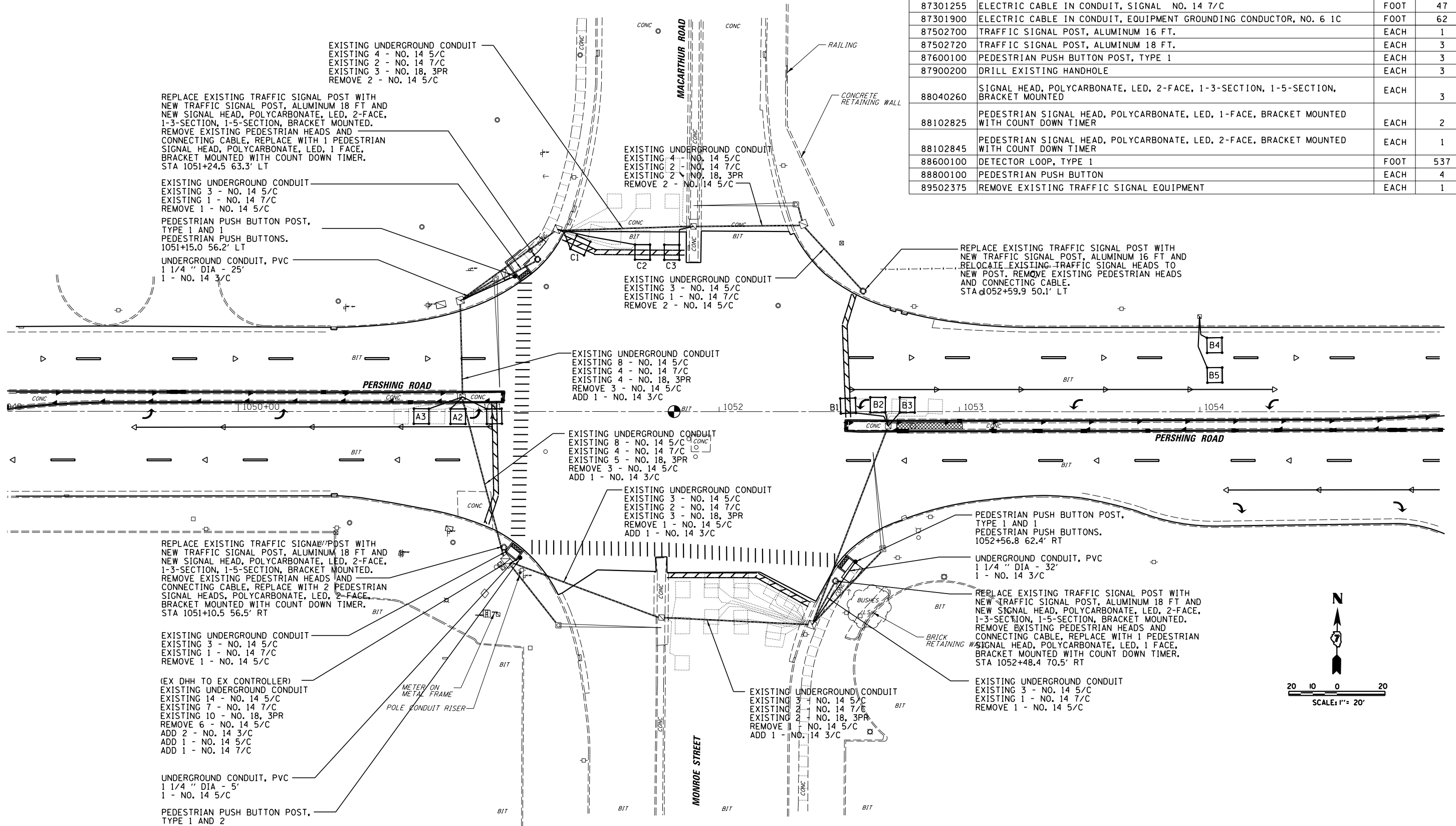

THE CONTRACTOR SHALL REMOVE ALL EXISTING PEDESTRIAN PUSH BUTTONS, THIS SHALL WORK SHALL BE PAID FOR AS REMOVE EXISTING TRAFFIC SIGNAL EQUIPMENT.

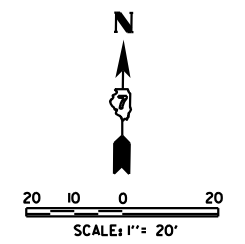

FILE NAME =	USER NAME = csefert	DESIGNED - TES	REVISED -	STATE OF ILLINOIS DEPARTMENT OF TRANSPORTATION	TRAFFIC SIGNAL PLAN IL. RTE 121/48 & MONROE ST./MACARTHUR RD.	F.A.P. RTE.	SECTION	COUNTY	TOTAL SHEETS	SHEET NO.	
I:\DOT\6008 - 07 Var Var\Work Order 3	IL 121 Resurfacing\CADD\Civil\0774624-sht-t	DRAWN - RLK	REVISED -			320	(126)RS-2, 135RS-1	MACON	119	90	
Default	PLOT SCALE = 40.0000' / in.	CHECKED - CAS	REVISED -			CONTRACT NO. 74624					
	PLOT DATE = 8/20/2014	DATE - 8/13/14	REVISED -			ILLINOIS FED. AID PROJECT					