

EXISTING UNDERGROUND CONDUIT
EXISTING 2 - NO. 14 5/C
ADD 1 - NO. 14 5/C

EXISTING HANDHOLE
31+42.9 45.3' LT

UNDERGROUND CONDUIT, PVC
2 1/2" DIA - 6'
2 - NO. 14 5/C
1 - NO. 14 7/C

STEEL COMBINATION MAST ARM ASSEMBLY
AND POLE 40 FT AND CONCRETE FOUNDATION,
TYPE E 36-INCH DIA. 13 FT. INSTALL 2
SIGNAL HEADS, POLYCARBONATE, LED, 1-FACE,
3-SECTION, MAST ARM MOUNTED AND 1 SIGNAL
HEAD, POLYCARBONATE, LED, 1-FACE, 5-SECTION,
MAST ARM MOUNTED.
31+39.0 41.1' LT

UNDERGROUND CONDUIT, PVC
1 1/4" DIA - 15'
1 - NO. 14 3/C

REPLACE EXISTING SIGNAL POST WITH
TRAFFIC SIGNAL POST, ALUM, 16 FT AND
INSTALL SIGNAL HEAD, POLYCARBONATE, LED,
2-FACE, 3-SECTION, BRACKET MOUNTED AND
PEDESTRIAN SIGNAL HEAD, POLYCARBONATE,
LED, 1-FACE, BRACKET MOUNTED WITH COUNT
DOWN TIMER.
31+65.1 55.2' LT

REPLACE EXISTING SIGNAL POST WITH
TRAFFIC SIGNAL POST, ALUM, 14 FT AND
INSTALL SIGNAL HEAD, POLYCARBONATE, LED,
1-FACE, 3-SECTION, BRACKET MOUNTED.

REPLACE EXISTING SIGNAL POST WITH
TRAFFIC SIGNAL POST, ALUM, 18 FT AND
INSTALL SIGNAL HEAD, POLYCARBONATE, LED,
2-FACE, 3-SECTION, 5-SECTION, BRACKET MOUNTED.

PEDESTRIAN PUSH BUTTON AND
PEDESTRIAN PUSH BUTTON POST,
TYPE 1
31+56.7 40.3' LT

REMOVE LIGHTING UNIT
REMOVE EXISTING MAST ARM
ASSEMBLY AND FOUNDATION.

EXISTING UNDERGROUND CONDUIT
EXISTING 6 - NO. 14 5/C
EXISTING 1 - NO. 14 7/C
REMOVE 3 - NO. 14 5/C
ADD 1 - NO. 14 3/C
ADD 3 - NO. 14 5/C
ADD 1 - NO. 14 7/C

REPLACE EXISTING SIGNAL POST WITH
TRAFFIC SIGNAL POST, ALUM, 14 FT AND
INSTALL SIGNAL HEAD, POLYCARBONATE LED,
1-FACE, 3-SECTION, BRACKET MOUNTED.

REMOVE EXISTING TRAFFIC SIGNAL
POST, CABLE, AND FOUNDATION.

TRAFFIC SIGNAL POST, ALUM, 16 FT
WITH TYPE A FOUNDATION. INSTALL
1 SIGNAL HEAD, POLYCARBONATE, LED,
1-FACE, 3-SECTION, BRACKET MOUNTED
AND 1 PEDESTRIAN SIGNAL HEAD,
POLYCARBONATE, LED, 1-FACE, BRACKET
MOUNTED WITH COUNT DOWN TIMER.
31+41.7 51.0' RT

PEDESTRIAN PUSH BUTTON AND
PEDESTRIAN PUSH BUTTON POST, TYPE 1
31+45.2 51.8' RT

EXISTING CONTROLLER
31+42.5 61.0' RT

UNDERGROUND CONDUIT, PVC
2" DIA - 9'
2 - NO. 14 5/C

EXISTING HANDHOLE
31+50.3 53.2' RT

UNDERGROUND CONDUIT, PVC
1 1/4" DIA - 5'
1 - NO. 14 3/C

EXISTING UNDERGROUND CONDUIT
EXISTING 1 - NO. 14 2/C TS
EXISTING 11 - NO. 14 5/C
EXISTING 2 - NO. 14 7/C
REMOVE 4 - NO. 14 5/C
ADD 2 - NO. 14 3/C
ADD 5 - NO. 14 5/C
ADD 1 - NO. 14 7/C

REPLACE EXISTING SIGNAL
POST WITH TRAFFIC SIGNAL
POST, ALUM, 14 FT AND
INSTALL SIGNAL HEAD,
POLYCARBONATE, LED, 2-FACE,
3-SECTION, BRACKET MOUNTED.

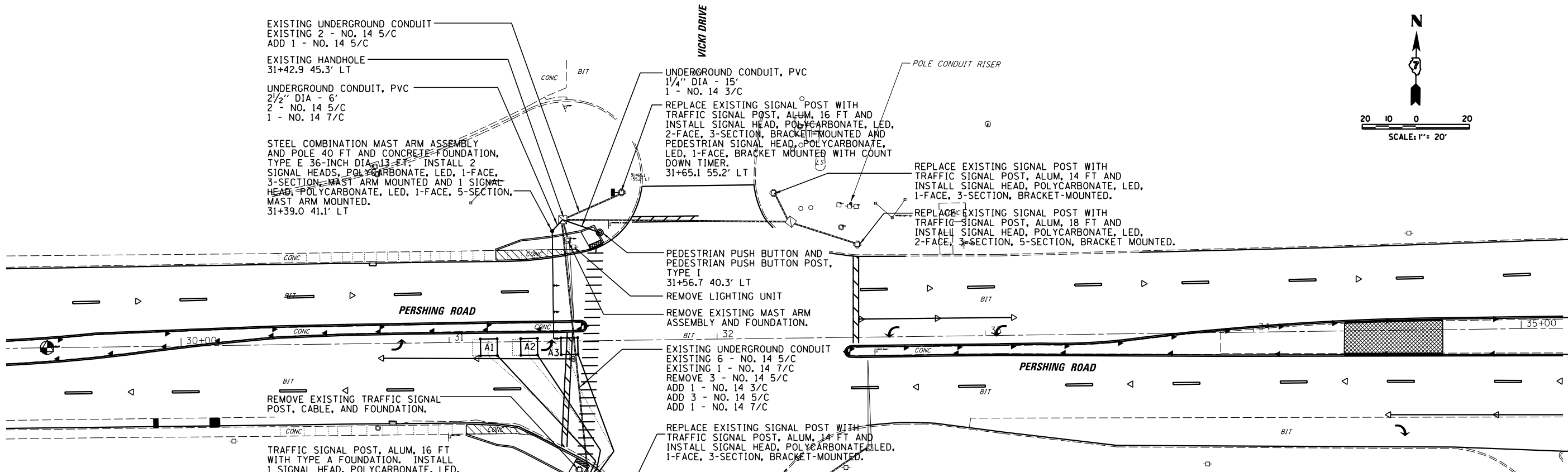
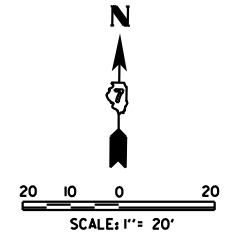

BILL OF MATERIALS			
CODE	ITEM	UNIT	QUANTITY
81028330	UNDERGROUND CONDUIT, PVC, 1 1/4" DIA	FOOT	20
81028350	UNDERGROUND CONDUIT, PVC, 2" DIA	FOOT	9
81028360	UNDERGROUND CONDUIT, PVC, 2 1/2" DIA.	FOOT	6
84200600	REMOVAL OF LIGHTING UNIT, NO SALVAGE	EACH	1
87301225	ELECTRIC CABLE IN CONDUIT, SIGNAL NO. 14 3/C	FOOT	185
87301245	ELECTRIC CABLE IN CONDUIT, SIGNAL NO. 14 5/C	FOOT	681
87301255	ELECTRIC CABLE IN CONDUIT, SIGNAL NO. 14 7/C	FOOT	202
87301900	ELECTRIC CABLE IN CONDUIT, EQUIPMENT GROUNDING CONDUCTOR, NO. 6 1C	FOOT	125
87502680	TRAFFIC SIGNAL POST, ALUMINUM 14 FT.	EACH	3
87502700	TRAFFIC SIGNAL POST, ALUMINUM 16 FT.	EACH	2
87502720	TRAFFIC SIGNAL POST, ALUMINUM 18 FT.	EACH	1
87600100	PEDESTRIAN PUSH BUTTON POST, TYPE 1	EACH	2
87702930	STEEL COMBINATION MAST ARM ASSEMBLY AND POLE 40 FT.	EACH	1
87800100	CONCRETE FOUNDATION, TYPE A	FOOT	3
87800415	CONCRETE FOUNDATION, TYPE E 36-INCH DIAMETER	FOOT	13
87900200	DRILL EXISTING HANDHOLE	EACH	4
88040070	SIGNAL HEAD, POLYCARBONATE, LED, 1-FACE, 3-SECTION, BRACKET MOUNTED	EACH	3
88040090	SIGNAL HEAD, POLYCARBONATE, LED, 1-FACE, 3-SECTION, MAST ARM MOUNTED	EACH	2
88040160	SIGNAL HEAD, POLYCARBONATE, LED, 1-FACE, 5-SECTION, MAST ARM MOUNTED	EACH	1
88040230	SIGNAL HEAD, POLYCARBONATE, LED, 2-FACE, 3-SECTION, BRACKET MOUNTED	EACH	2
88040260	SIGNAL HEAD, POLYCARBONATE, LED, 2-FACE, 1-3-SECTION, 1-5-SECTION, BRACKET MOUNTED	EACH	1
88102825	PEDESTRIAN SIGNAL HEAD, POLYCARBONATE, LED, 1-FACE, BRACKET MOUNTED WITH COUNT DOWN TIMER	EACH	2
88200100	TRAFFIC SIGNAL BACKPLATE	EACH	3
88600100	DETECTOR LOOP, TYPE 1	FOOT	249
88800100	PEDESTRIAN PUSH BUTTON	EACH	2
89502210	MODIFY EXISTING CONTROLLER CABINET	EACH	1
89502375	REMOVE EXISTING TRAFFIC SIGNAL EQUIPMENT	EACH	1
89502385	REMOVE EXISTING CONCRETE FOUNDATION	EACH	2