

SEC. 4, T3S, R3E, 3RD P.M.

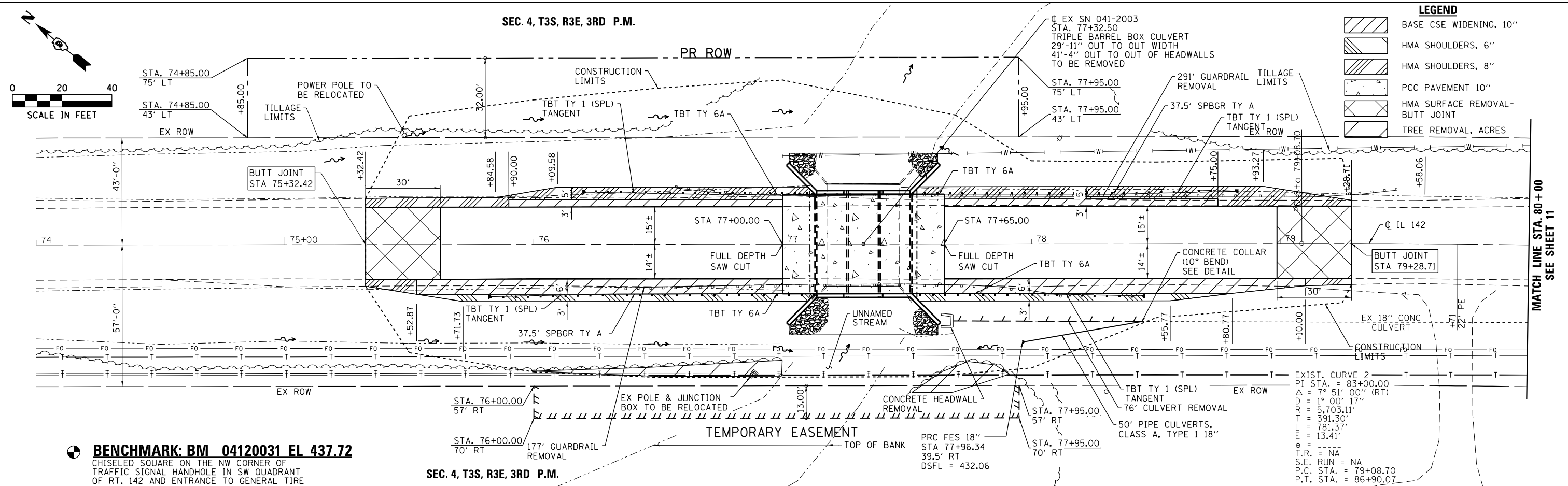

BENCHMARK: BM 04120031 EL 437.72
 CHISELED SQUARE ON THE NW CORNER OF TRAFFIC SIGNAL HANDHOLE IN SW QUADRANT OF RT. 142 AND ENTRANCE TO GENERAL TIRE

SEC. 4, T3S, R3E, 3RD P.M.

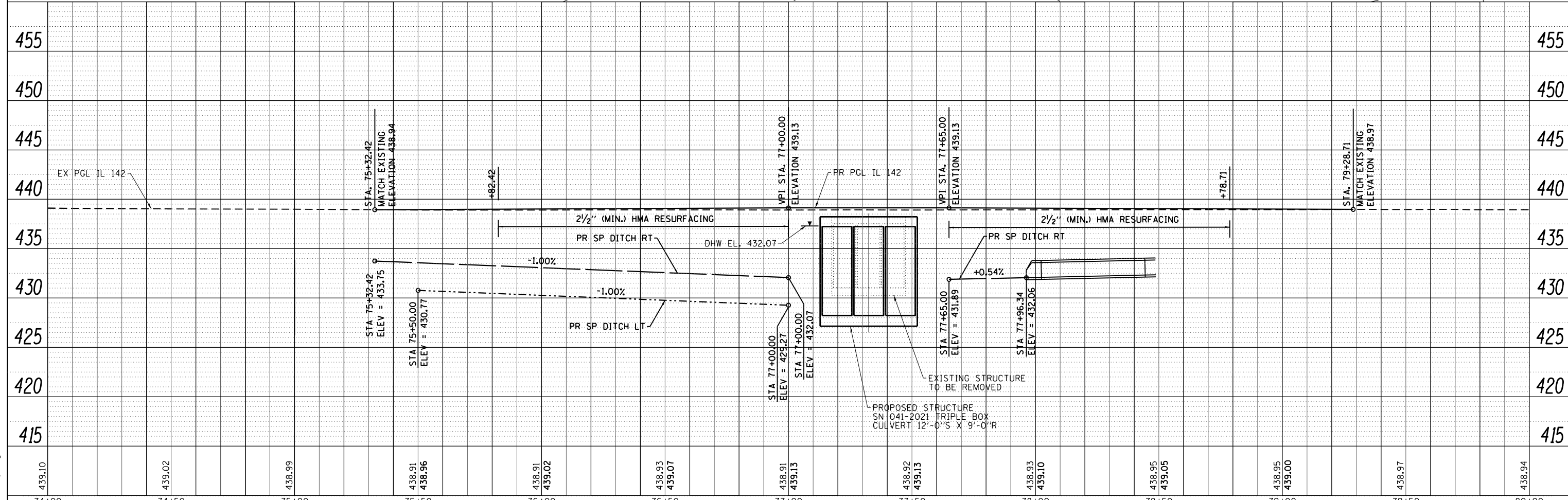

FILE NAME = D:\78210-sht-plnprof.dgn
 MODEL = Default
 PLOT DRIVER = I:\DOT_PDF.plt.ctb

74+00	74+50	75+00	75+50	76+00	76+50	77+00	77+50	78+00	78+50	79+00	79+50	80+00
439.10	439.02	438.99	438.91 438.96	438.91 439.02	438.93 439.07	438.91 439.13	438.92 439.13	438.93 439.10	438.95 439.05	438.95 439.00	438.97	438.94



USER NAME = twalker	DESIGNED - MCV	REVISED -
FILE NAME = D:\78210-sht-plnprof.dgn	DRAWN - CMM	REVISED -
PLOT SCALE = 40.0000' / in.	CHECKED - MTM	REVISED -
PLOT DATE = 5/29/2014	DATE - 4/25/2014	REVISED -

STATE OF ILLINOIS
DEPARTMENT OF TRANSPORTATION

IL RTE 142 PLAN & PROFILE
SN 041-2021
 SCALE: 1"=20' SHEET NO. 1 OF 2 SHEETS STA. 74+00 TO STA. 80+00

F.A.P. RTE. = 849	SECTION = 113B-1	COUNTY = JEFFERSON	TOTAL SHEETS = 36	SHEET NO. = 10
CONTRACT NO. 78210				
ILLINOIS FED. AID PROJECT				