

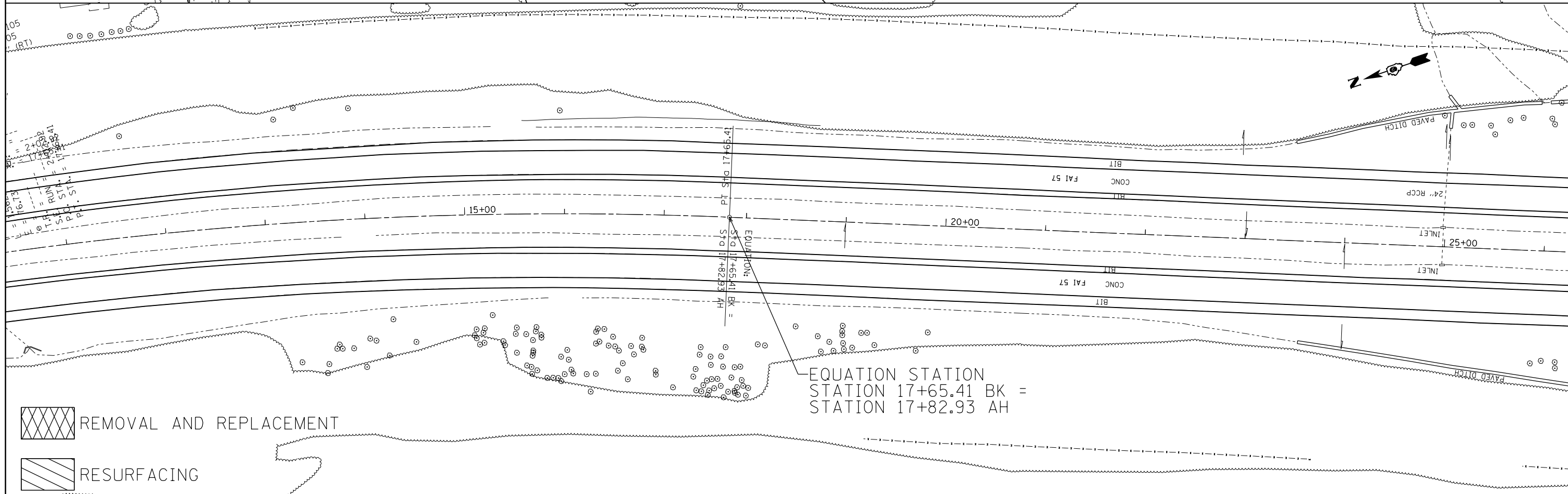

EXIST. CURVE CL105  
 P.T. STA. = 9+94.05  
 $\Delta = 22^\circ 09' 33''$  (RT)  
 $D = 1^\circ 25' 06''$   
 $R = 4,040.03'$   
 $T = 791.13'$   
 $L = 1,562.49'$   
 $E = 76.73'$   
 $e = \dots$   
 $T.R. = \dots$   
 $S.E. RUN = \dots$   
 $P.T. STA. = 2+032.92$   
 $P.T. STA. = 11+562.41$

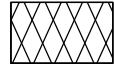

 REMOVAL AND REPLACEMENT  
 RESURFACING

FILE NAME = c:\pwwork\pwwork\colemm\d0351283\78380\sh1.dgn	USER NAME = colemm	DESIGNED -	REVISED -	<b>STATE OF ILLINOIS DEPARTMENT OF TRANSPORTATION</b>	<b>PLAN ALONG I-57 MEDIAN</b>				F.A.I. RTE. 57	SECTION .	COUNTY WILLIAMSON	TOTAL SHEETS 107	SHEET NO. 69
Default	PLOT DATE = 8/22/2014	DRAWN -	REVISED -		SCALE:	SHEET	OF	SHEETS	STA.	TO	STA.	CONTRACT NO. 78380	
		CHECKED -	REVISED -		ILLINOIS FED. AID PROJECT								
		DATE -	REVISED -		(X1-8,X1-7-1,X1-7,X1-6-1)R-1								