

DETOUR SIGNING

SIGN DETAIL

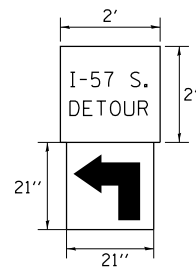

NOTES:

1. THE CONTRACTOR HAS THE OPTION OF USING METAL POSTS INSTEAD OF WOOD.
2. ALL SIGNS SHALL BE BLACK ON ORANGE. THE POSTS SHALL BE PLACED 12 FEET FROM THE EDGE OF PAVEMENT OR AS DIRECTED BY THE ENGINEER.
3. THE COST OF FURNISHING, REMOVING, AND INSTALLING, ALL SIGNS, AND HARDWARE AS SHOWN ON THIS SHEET, SHALL BE INCLUDED IN THE COST OF DETOUR SIGNING.
4. SIGNS SHALL BE REMOVED ON COMPLETION OF STAGE II AT THE DIRECTION OF THE ENGINEER. THIS WORK SHALL BE COMPLETED ACCORDING TO SECTION 724 OF THE STANDARD SPECIFICATIONS. THE SIGNS AND POSTS SHALL BECOME THE PROPERTY OF THE CONTRACTOR.
5. THE RELOCATING, MAINTENANCE OR REPLACEMENT OF SIGNS SHALL BE PAID FOR IN ACCORDANCE WITH ARTICLE 109.04.
6. EXACT SIGN PLACEMENT WILL BE DETERMINED BY THE ENGINEER.
7. THE DISTRICT 9 OPERATIONS ENGINEER SHALL BE CONTACTED 10 DAYS PRIOR TO THE ERECTION OF SIGNS.

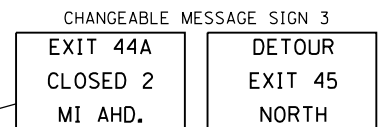
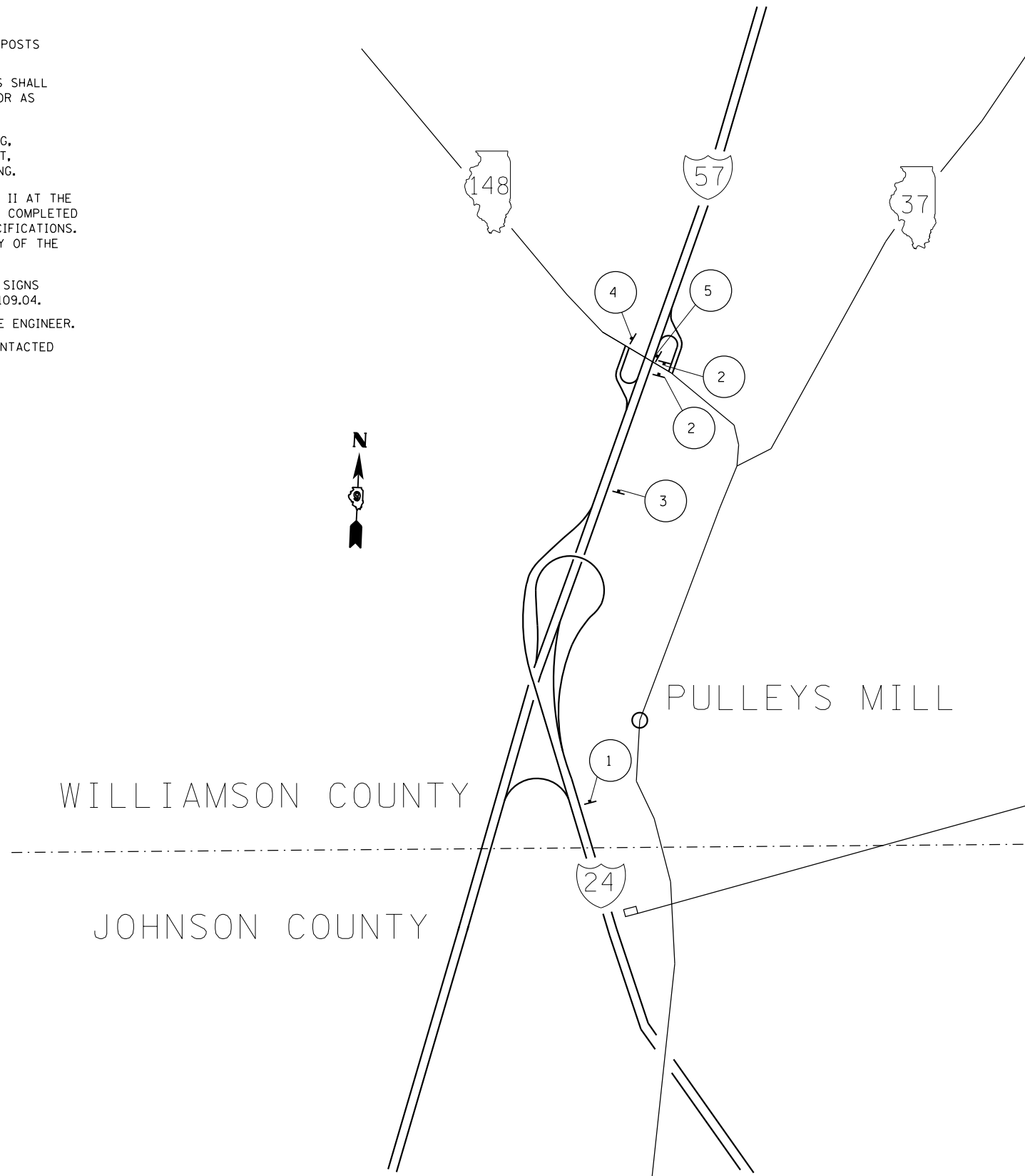
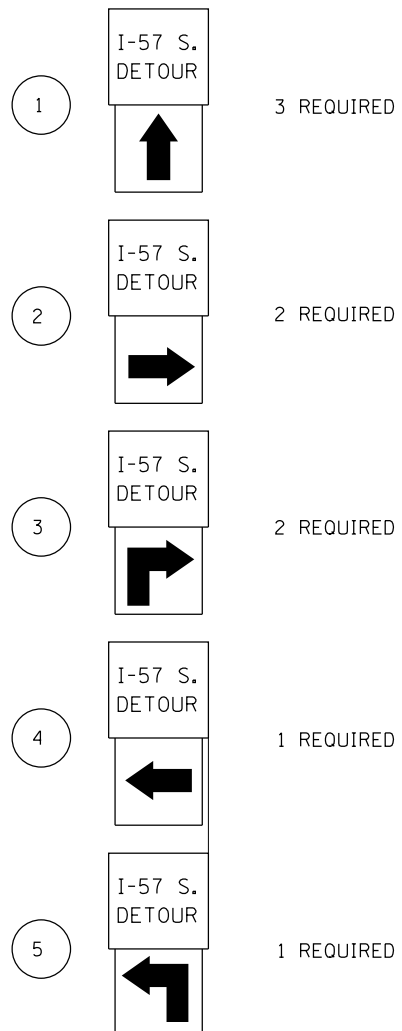

FILE NAME =	USER NAME = Dahmer,ja	DESIGNED -	REVISED -	STATE OF ILLINOIS DEPARTMENT OF TRANSPORTATION	DETOUR SIGNING	F.A.I. RTE.	SECTION	COUNTY	TOTAL SHEETS	SHEET NO.			
Default	et:\pw\work\p\id\dot\dahmer,ja\0387649\78424-sh-t-plan.dgn	DRAWN -	REVISED -			24	D9 CM BRIDGE REP. 2015-1	WILLIAMSON	19	19			
	PLOT SCALE = 100.0000' / in.	CHECKED -	REVISED -							CONTRACT NO. 78424			
	PLOT DATE = 8/15/2014	DATE -	REVISED -		SCALE:		SHEET	OF	SHEETS	STA.	TO	STA.	ILLINOIS FED. AID PROJECT