

097-0038/0039

SHEET NO.	SECTION	COUNTY	TOTAL SHEETS	SHEET NO.
23	5	WHITE	36	5

23 SHEETS
SHEET NO. 5

STATE OF ILLINOIS
DEPARTMENT OF PUBLIC WORKS & BUILDINGS
DIVISION OF HIGHWAYS

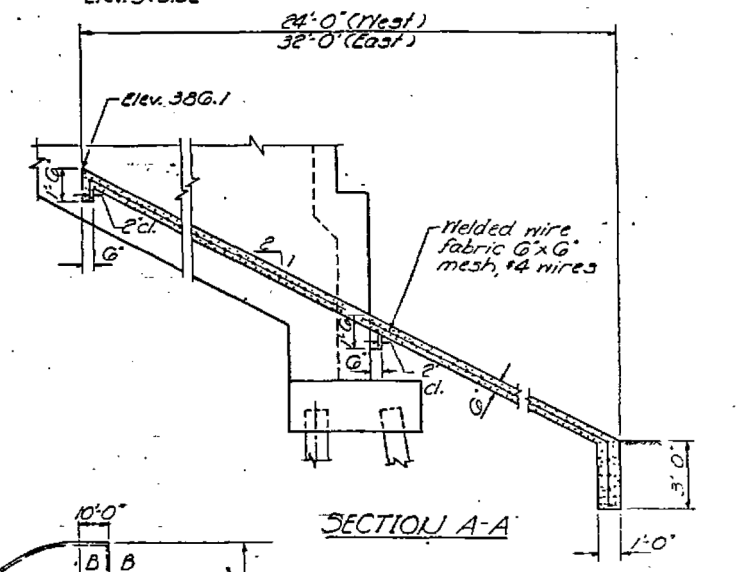
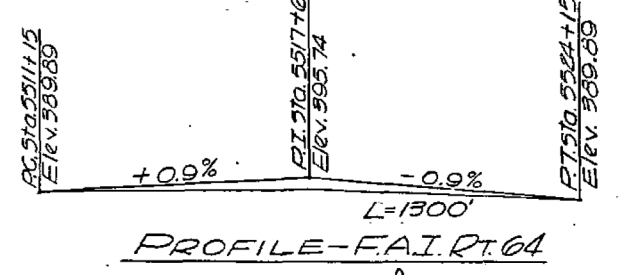
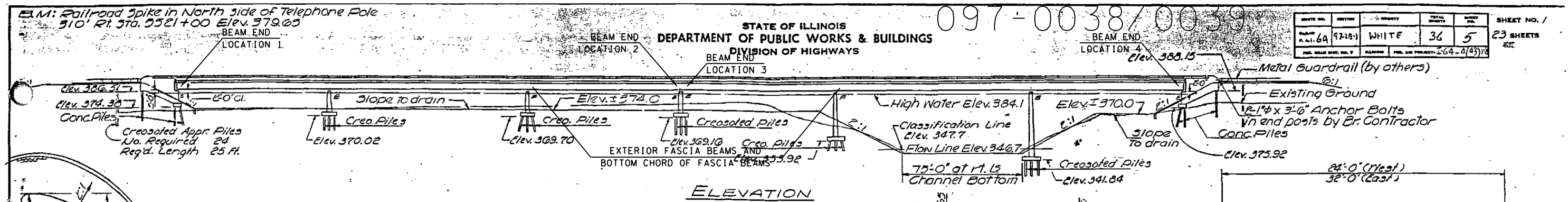

WATERWAY INFORMATION

Drainage Area ----- 1950 Sq. Miles
Character ----- Level, Rolling, Wooded, Cultivated
Required Opening ----- (50 Year Flood) - 9750 Sq. Ft.
Present Opening ----- None
Proposed Opening ----- 9750 Sq. Ft.
Q = 39,000 cfs.

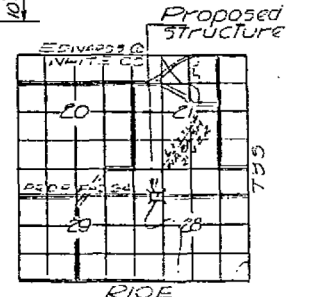
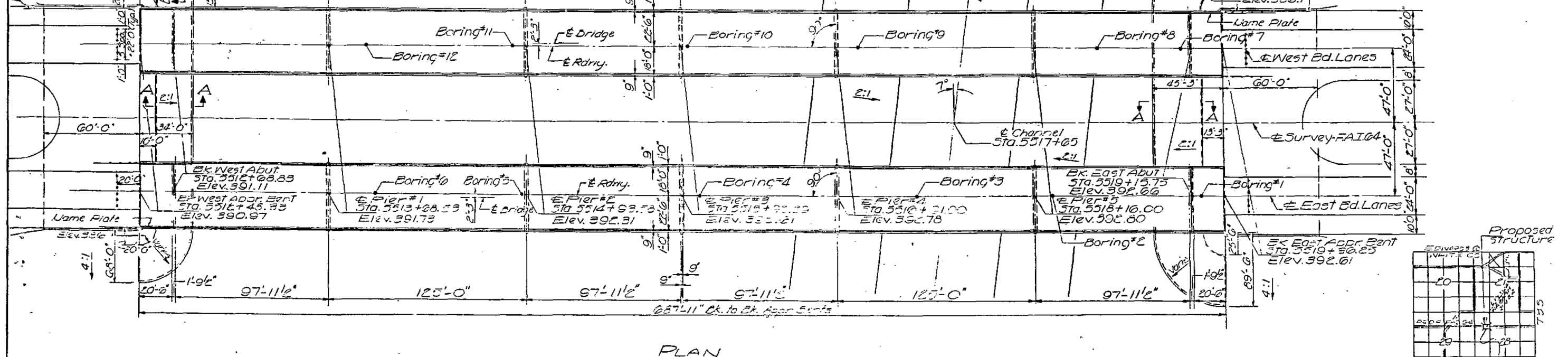
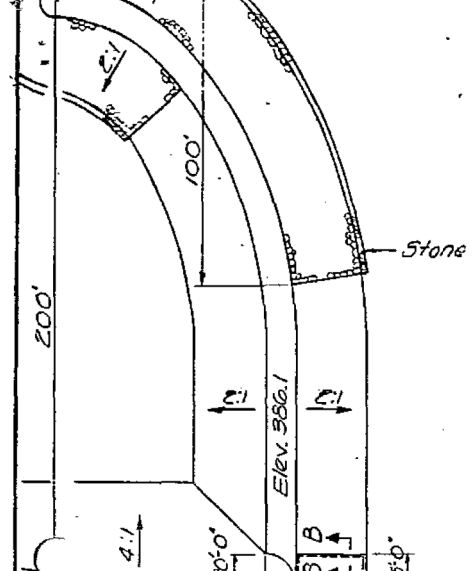

DESIGN STRESSES

$F_c = 1400$ PSI. - (SUELF & SUP.)
 $F_s = 20,000$ PSI. - (TENS.)
 $F_s = 20,000$ PSI. - (STRUCT.)
 $V_c = 75$ PSI. - (FIBES)
 $n = 10$

STATION 5517+65
BUILT 197 BY
STATE OF ILLINOIS
FAI RT. 64 SEC. 27-28-1
FA PROJ. 1-64-4(4)

FOR INFORMATION ONLY

SIGNED: [Signature]
CHECKED: [Signature]
DRAWN: [Signature]
CHECKED: [Signature]

EXAMINED: [Signature]
PASSED: [Signature]
APPROVED: [Signature]

December 7 1967

FILE NAME: c:\pwwork\pwwork\dahmer\ja\0392003\78428-shr-plan.dgn	USER NAME: Dahmer,ja	DESIGNED: -	REVISED: -	STATE OF ILLINOIS DEPARTMENT OF TRANSPORTATION	SN 097-0038 & SN 097-0039	F.A. RTE.	SECTION	COUNTY	TOTAL SHEETS	SHEET NO.	
PLOT SCALE: 100.0000' / in.	PLotted DATE: 8/15/2014	DRAWN: -	REVISED: -			VAR. D9 BRIDGE PAINT 2015-1	VARIOUS	ILLINOIS	23	13	
Default		CHECKED: -	REVISED: -			CONTRACT NO. 78428					
		DATE: -	REVISED: -			ILLINOIS FED. AID PROJECT					