

C15 STA 45+68.7 FORCEMAIN VAULT  
 11.0' BY 8.0'  
 TOP EL = 416.6  
 FLOOR EL = 409.2

C16 STA 49+34.2 FORCEMAIN VAULT  
 11.0' BY 8.0'  
 TOP EL = 418.6  
 FLOOR EL = 411.4

PLAN	SURVEYED	DATE
	PLOTTED	
	ALIGNED	
	CHECKED	
	FILED	
	NO.	

PROFILE	SURVEYED	DATE
	PLOTTED	
	GRADES	
	CHECKED	
	STRUCTURE	
	NOTATIONS	
	CHKD	
	NO.	

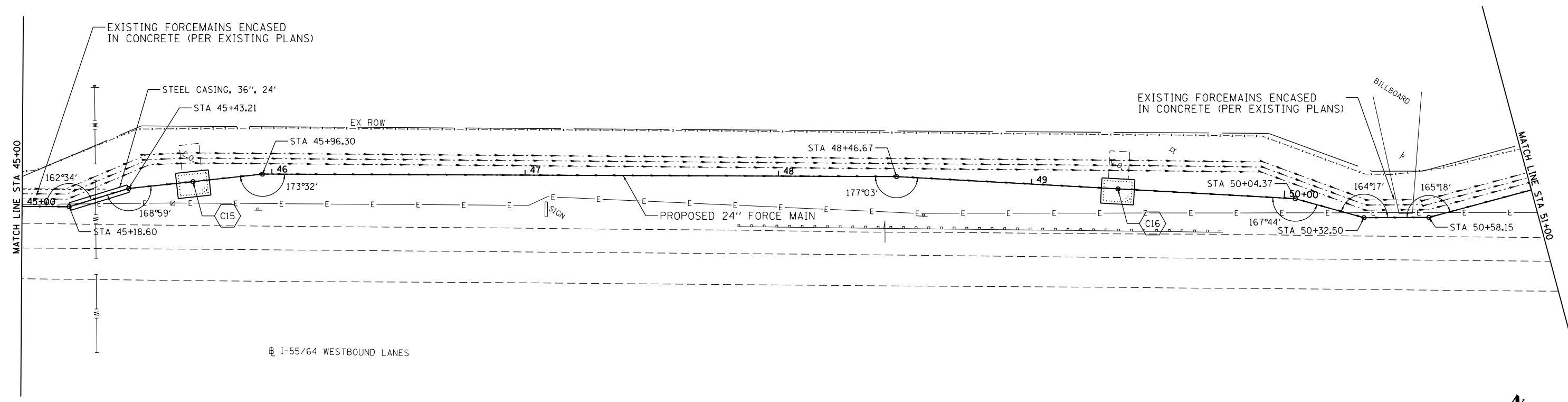

NOTE:  
 ALL CONSTRUCTION ACTIVITIES SHALL BE LOCATED  
 OUTSIDE OF THE PAVED SHOULDERS OF F.A.I. 64

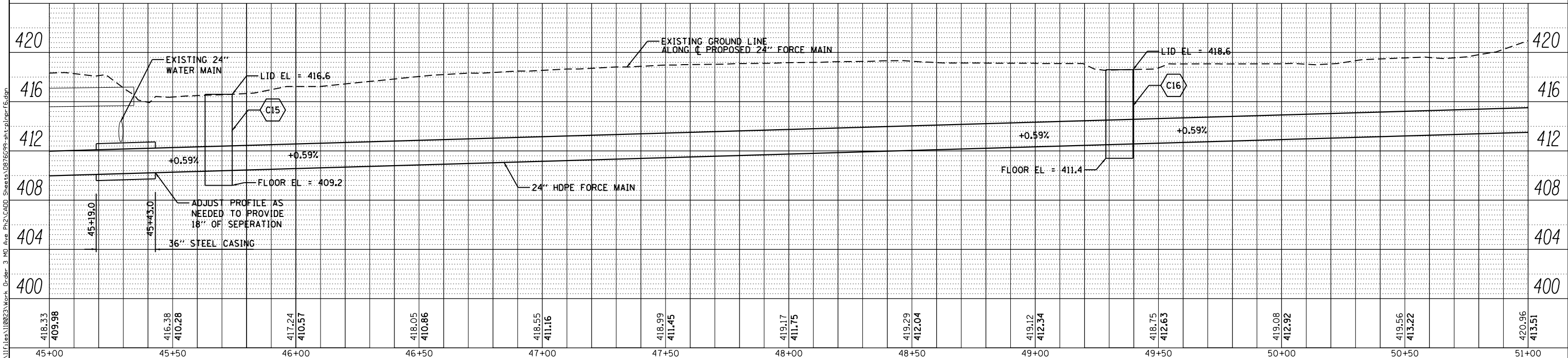
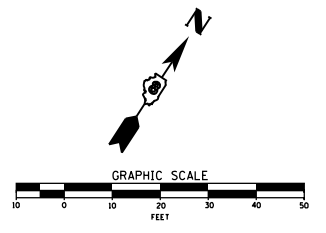

**KLINGNER & ASSOCIATES, P.C.**  
 Engineers - Architects - Surveyors

USER NAME = seb	DESIGNED - SEB	REVISED -
	DRAWN - SEB	REVISED -
PLOT SCALE = 40.0000' / in.	CHECKED -	REVISED -
PLOT DATE = 8/23/2014	DATE -	REVISED -

STATE OF ILLINOIS  
 DEPARTMENT OF TRANSPORTATION

FORCE MAIN PLAN AND PROFILE  
 MISSOURI AVENUE DEEP WELL FACILITY  
 SCALE: 1"=20' SHEET 10 OF 12 SHEETS STA. 45+00 TO STA. 51+00

F.A.I. RTE. 64	SECTION 82-4T-1	COUNTY ST. CLAIR	TOTAL SHEETS 185	SHEET NO. 36
CONTRACT NO. 76C99			ILLINOIS FED. AID PROJECT	