

THE STORMWATER PUMP STATION ELECTRICAL CLASSIFICATION IS CLASS 1, DIVISION 2, GROUP D. ALL EQUIPMENT INSTALLED AND INSTALLATION METHODS WITHIN OR ON THE STORMWATER PUMP STATION SHALL BE SUITABLE FOR THIS CLASSIFICATION.

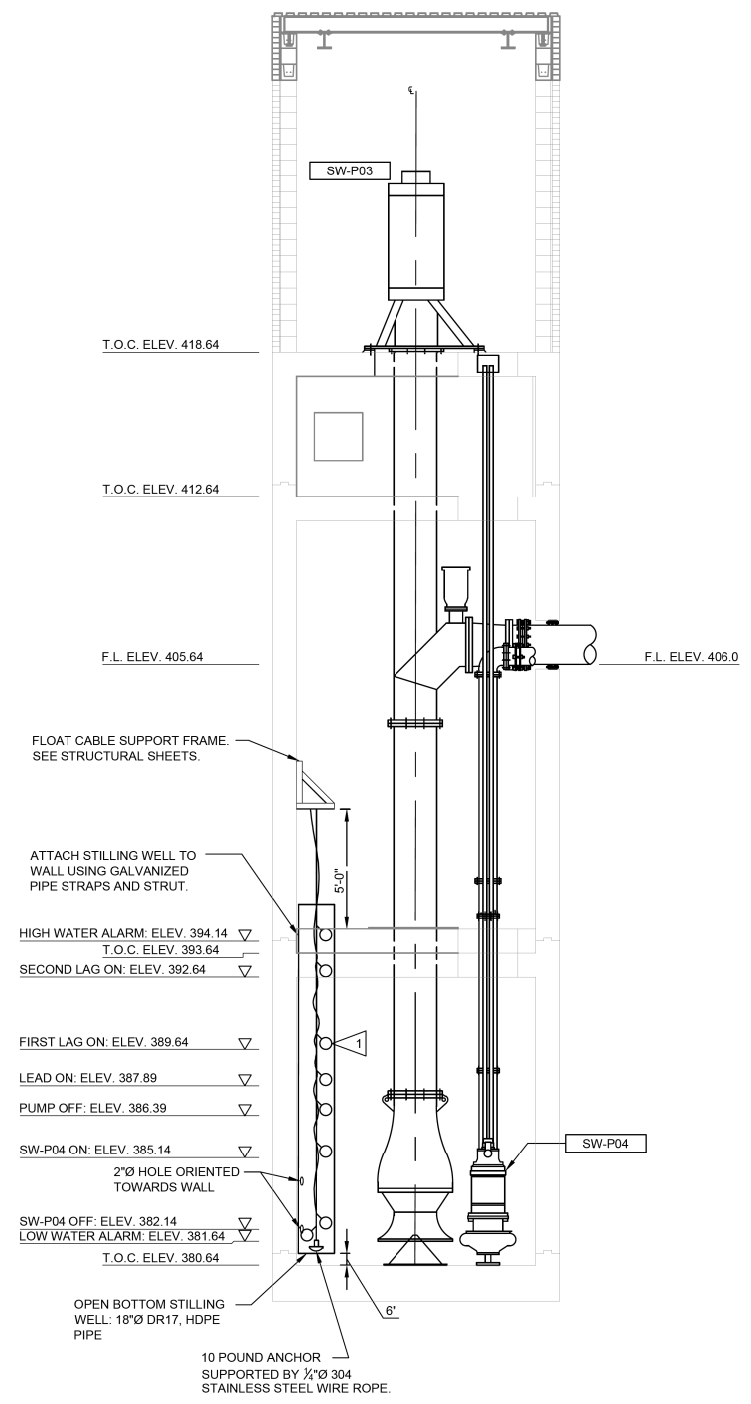

A SECTION
M300 SCALE: 1/4"=1'-0"

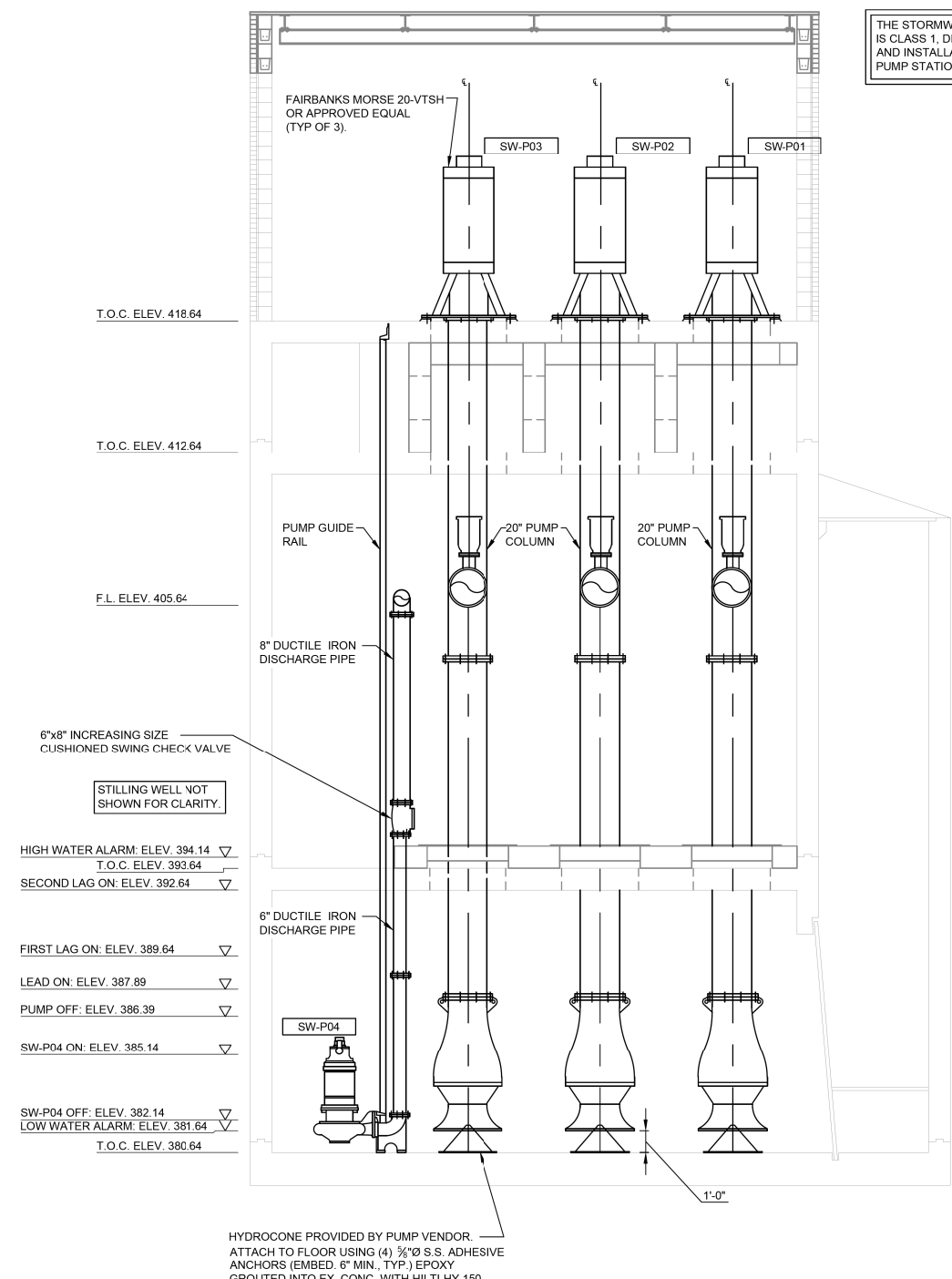

B SECTION
M300 SCALE: 1/4"=1'-0"

KEYED NOTES (NOTES APPLICABLE TO THIS SHEET ONLY)

- 1 FLOATS (TYPE OF 8) SHALL CONSIST OF SEALED MERCURY SWITCHES IN A STAINLESS STEEL SPHERICAL FLOAT WITH INTEGRAL NEOPRENE JACKETED CABLE. FLOATS SHALL BE RATED FOR INTRINSICALLY SAFE INSTALLATIONS.

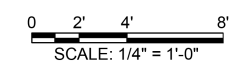

FILE NAME = G:\115\115023\Work\Drawn\3_M0_Ave_P12\ACADD_Sheets\0876599-ah-t-KL0_Mech3.dgn

KLINGNER & ASSOCIATES, P.C.
Engineers • Architects • Surveyors

USER NAME = seb	DESIGNED - JJN	REVISED -
PLOT SCALE = 40.0000' / in.	DRAWN - JJN	REVISED -
PLOT DATE = 8/23/2014	CHECKED -	REVISED -
	DATE -	REVISED -

**STATE OF ILLINOIS
DEPARTMENT OF TRANSPORTATION**

**EXISTING PUMP STATION BUILDING - PROCESS MECHANICAL
MISSOURI AVENUE DEEP WELL FACILITY**

SCALE: AS NOTED SHEET 3 OF 3 SHEETS STA. TO STA.

F.A.I. RTE.	SECTION	COUNTY	TOTAL SHEETS	SHEET NO.
64	82-4T-1	ST. CLAIR	185	150
CONTRACT NO. 76C99				
ILLINOIS FED. AID PROJECT				

M302