

F.A.I. 80/94 (KINGERY EXPRESSWAY) BORING LOCATION PLAN ILLINOIS DEPARTMENT OF TRANSPORTATION, COOK COUNTY		F.A.I. RTE	SECTION	COUNTY	TOTAL SHEETS	SHEET NO.
DRAWN BY: SLS CHECKED BY: SLS		80/94	*	COOK	870	186
STA. 39+600		TO STA. 39+850		FED ROAD DIST. NO. ILLINOIS FED. AID PROJECT		
		346 Main Street Lombard, IL 60148 630-952-8888 200-08-04				

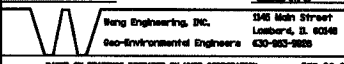

- NOTES:
1. ALL STATIONING AND OFFSET MEASUREMENTS OFF  $\phi$  IL 394 UNLESS OTHERWISE NOTED.
  2. ALL DIMENSIONS ARE IN METERS (m) UNLESS OTHERWISE NOTED.

**PROPOSED**

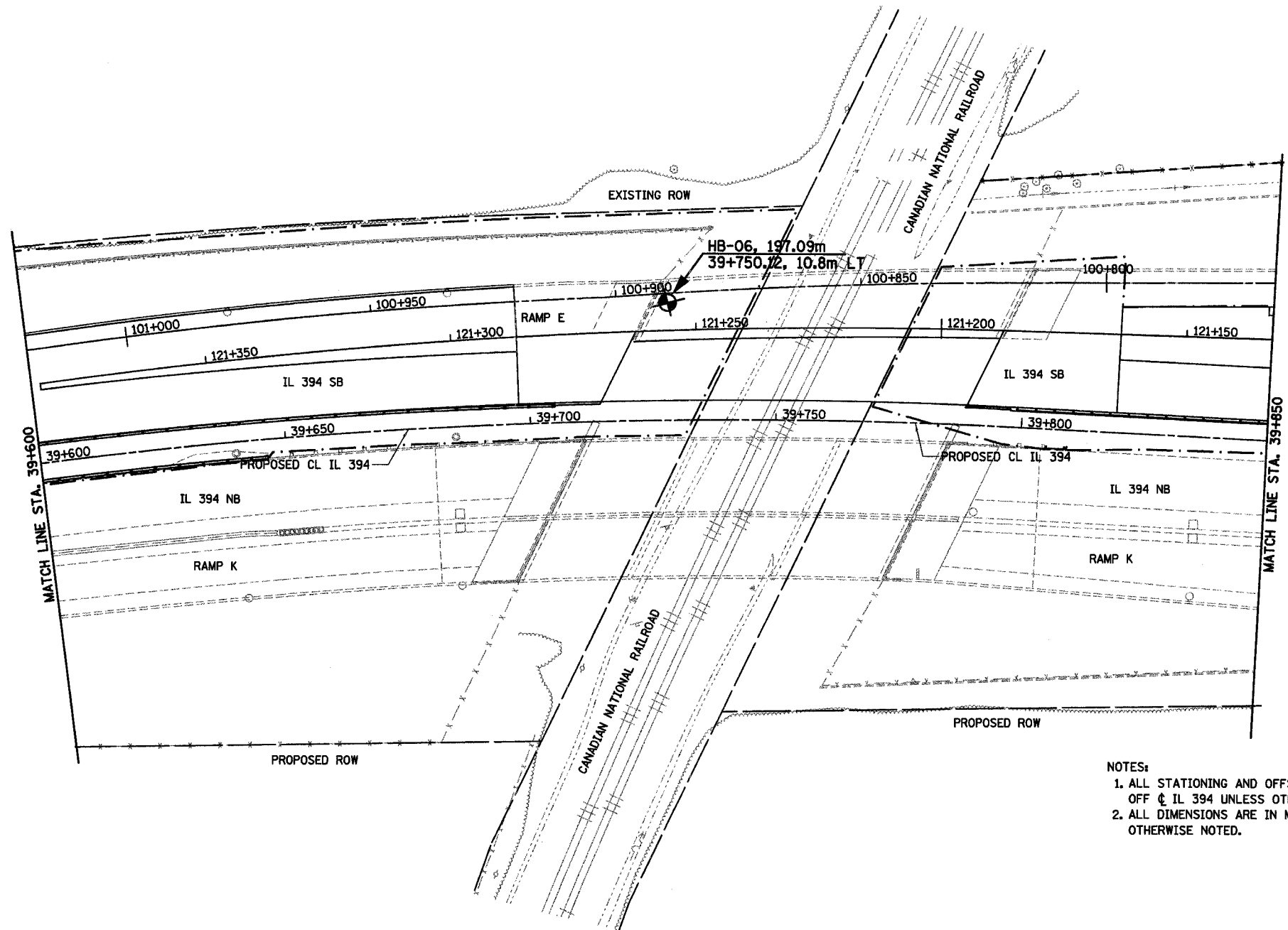
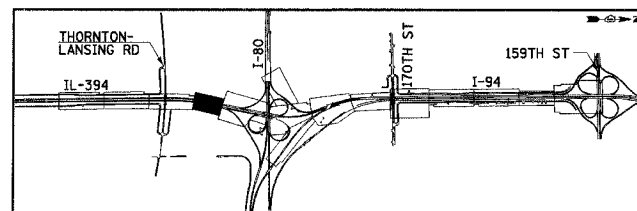

REVISIONS	
NAME	DATE

SB-14

ILLINOIS DEPARTMENT OF TRANSPORTATION  
I-94 EAST BOUND / IL 394 SOUTH BOUND

**SOIL BORING PLAN**  
**IL 394**  
**STA. 39+600 TO STA. 39+850**

HORIZ SCALE: 1:500  
VERT SCALE: 1:500  
DATE: JULY 18, 2005

DRAWN BY: \_\_\_\_\_  
CHECKED BY: \_\_\_\_\_