

90932

F.A.P. RTE.	SECTION	COUNTY	TOTAL SHEETS	SHEET NO.
717	110BR	DEWITT	40	1
FED. ROAD DIST. NO. 5 ILLINOIS			FED. AID PROJECT	

D-95-025-98

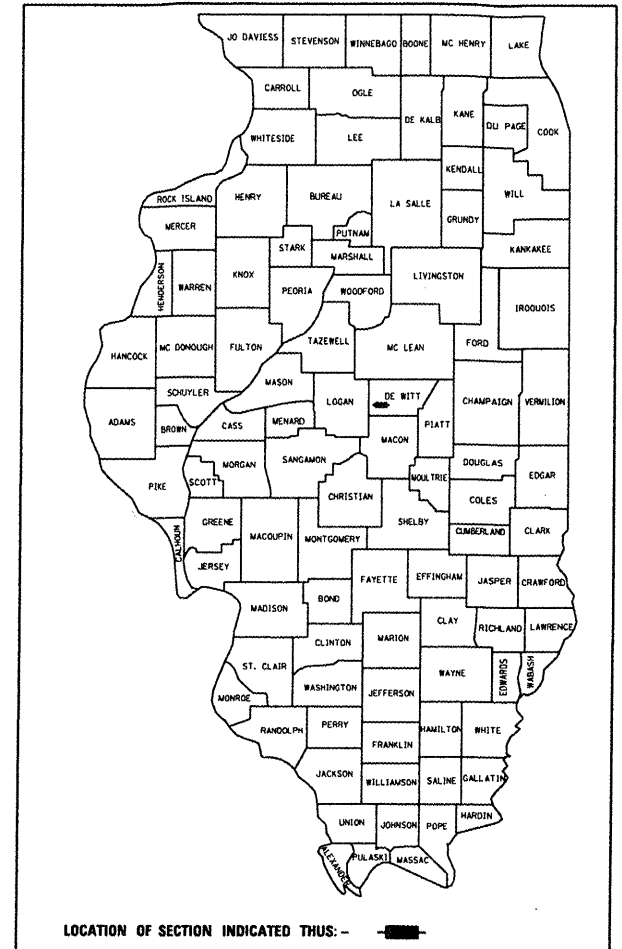

ADT = 1,800 (1999)  
 %SU = 6.1  
 %MU = 4.3  
 TOWNSHIP: BARNETT  
 FUNCTIONAL CLASSIFICATION:  
 MINOR ARTERIAL

STATE OF ILLINOIS  
 DEPARTMENT OF TRANSPORTATION  
 DIVISION OF HIGHWAYS

SUBMITTED: 12/20 20 09

*Paul K. Anderson*  
 DEPUTY DIRECTOR OF HIGHWAYS, REGION ENGINEER

December 4, 2009  
*Charles J. Ingersoll*  
 ENGINEER OF DESIGN AND ENVIRONMENT

December 4, 2009  
*Christine M. Reed*  
 DIRECTOR OF HIGHWAYS, CHIEF ENGINEER

**PRINTED BY THE AUTHORITY  
 OF THE STATE OF ILLINOIS**

STATE OF ILLINOIS  
 DEPARTMENT OF TRANSPORTATION  
 DIVISION OF HIGHWAYS

**PLANS FOR PROPOSED  
 FEDERAL AID HIGHWAY**  
**F.A.P. ROUTE 717 ( IL. RTE. 10)**  
**SECTION 110BR**  
**PROJECT NO. ACF-0717(031)**  
**BRIDGE REPLACEMENT**  
**DEWITT COUNTY**

C-95-025-98

**INDEX OF SHEETS**

- 1 COVER SHEET
- 2 GENERAL NOTES
- 3 SUMMARY OF QUANTITIES
- 4 TYPICAL CROSS-SECTIONS
- 5 PLAN AND PROFILE
- 6 STAGE 1 CONSTRUCTION PLAN
- 7 STAGE 2 CONSTRUCTION PLAN
- 8-21 STRUCTURE PLANS
- 22 EXISTING STRUCTURE
- 23 BUTT JOINT DETAIL
- 24-33 PLAN DETAILS
- 34-40 CROSS SECTIONS

**STANDARDS**

- 000001-05 STANDARD SYMBOLS, ABBREVIATIONS, AND PATTERNS
- 001001-02 AREAS OF REINFORCEMENT BARS
- 001006 DECIMAL EQUIVALENTS OF AN INCH AND FOOT
- 280001-05 TEMPORARY EROSION CONTROL SYSTEMS
- 420001-07 PAVEMENT JOINTS
- 420401-08 BRIDGE APPROACH PAVEMENT CONNECTOR
- 421001-02 BAR REINFORCEMENT FOR CRC PAVEMENT
- 442201-03 CLASS C AND D PATCHES
- 482011-03 HMA SHLD. STRIPS/SHLDS. WITH RESURFACING OR WIDENING AND RESURFACING PROJECTS
- 515001-03 NAME PLATE FOR BRIDGES
- 542401-01 METAL END SECTIONS FOR PIPE CULVERTS
- 609001-05 BRIDGE APPROACH SHOULDER PAVEMENT AND DRAIN
- 609006-05 BRIDGE APPROACH PAVEMENT (DRAIN DETAIL)
- 630001-08 STEEL PLATE BEAM GUARDRAIL
- 630201-06 PCC/IMA STABILIZATION AT STEEL PLATE BEAM GUARDRAIL
- 630301-05 SHOULDER WIDENING FOR TYPE I (SPECIAL) GUARDRAIL TERMINALS
- 631031-08 TRAFFIC BARRIER TERMINAL, TYPE 6
- 635006-03 REFLECTOR AND TERMINAL MARKER PLACEMENT
- 635011-02 REFLECTOR MARKER AND MOUNTING DETAILS
- 701001-02 OFF-ROAD OPERATIONS, 2L, 2W, MORE THAN 4.5m (15') AWAY
- 701006-03 OFF-ROAD OPERATIONS, 2L, 2W, 4.5m (15') TO 600mm (24") FROM PAVEMENT EDGE
- 701201-03 LANE CLOSURE, 2L, 2W, DAY ONLY, FOR SPEEDS >= 45 MPH
- 701301-03 LANE CLOSURE, 2L, 2W, SHORT TIME OPERATIONS
- 701311-03 LANE CLOSURE, 2L, 2W MOVING OPERATIONS - DAY ONLY
- 701321-10 LANE CLOSURE, 2L, 2W, BRIDGE REPAIR WITH BARRIER
- 701901-01 TRAFFIC CONTROL DEVICES
- 704001-06 TEMPORARY CONCRETE BARRIER
- 780001-02 TYPICAL PAVEMENT MARKINGS
- 886001-01 DETECTOR LOOP INSTALLATION
- 886006-01 TYPICAL LAYOUT FOR DETECTION LOOPS

**SCALE**

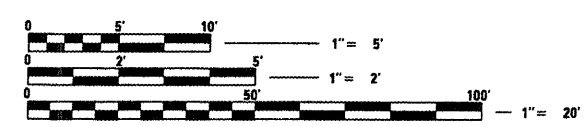

FULL SIZE PLANS HAVE BEEN PREPARED USING STANDARD ENGINEERING SCALES. REDUCED SIZED PLANS WILL NOT CONFORM TO STANDARD SCALES. IN MAKING MEASUREMENTS ON REDUCED PLANS, THE ABOVE SCALES MAY BE USED.

J.U.L.I.E.  
 JOINT UTILITY LOCATION INFORMATION FOR EXCAVATION  
 1-800-892-0123 OR 811  
 BARNETT TOWNSHIP

PROPOSED  
 STRUCTURE No. 020-0061  
 STA. 738 + 60  
 1 SPAN PPC I-BEAM 53'-0"  
 BK TO BK ABUTMENTS  
 IL 10 OVER UN-NAMED CREEK  
 BRIDGE REPLACEMENT

BEGIN SECTION 110BR  
 STA. 736 + 00.00

END SECTION 110BR  
 STA. 741 + 00.00

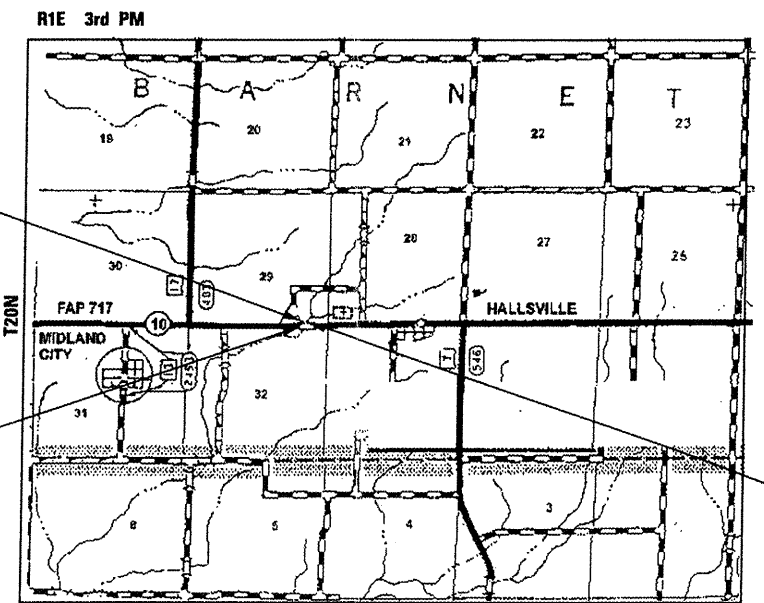

**LOCATION MAP**

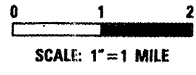

TOTAL AND NET LENGTH OF PROJECT = 500' (0.095 MILE)



*M. Silvester* 07-14-09  
 MARTIN SILVESTER, P.E.  
 LICENSE EXP. DATE 11-30-09

PROJECT ENGINEER: NANCY FASIG (217) 4654181  
 CONSULTANT LIAISON CONTACT: JASON STULTS  
 CONSULTANT: THE UPCHURCH GROUP, INC.  
 05/0012-ent-convr 5-10-09

CONTRACT NO. 90932